

PC board drilling dimensions(after plating)
(thickness ≤ 3.20±0.30mm)

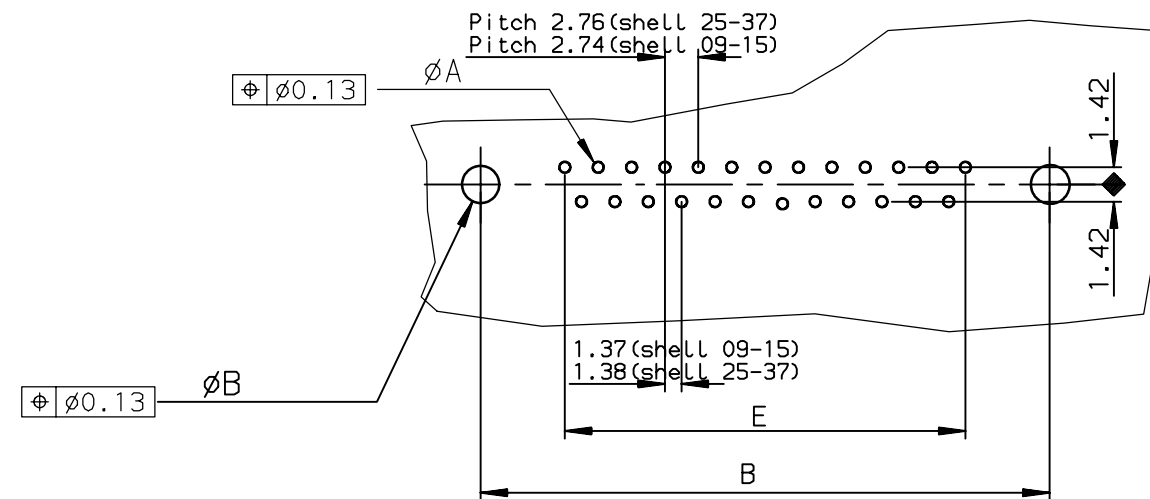

TIN LEAD PART NUMBER

SHELL	A±0.38	B±0.12	C±0.10	D±0.25	E±0.07	PART NUMBER	PART NUMBER
09	30.81	24.99	16.96	16.21	10.96	D09S90C4PX00	D09S90C6PX00
15	39.14	33.32	25.18	24.54	19.18	D15S90C4PX00	D15S90C6PX00
25	53.03	47.04	39.12	38.25	33.12	D25S90C4PX00	D25S90C6PX00
37	69.32	63.50	55.68	54.71	49.68	D37S90C4PX00	D37S90C6PX00
						gold flash	0.76µ gold

LEAD FREE PART NUMBER

SHELL	A±0.38	B±0.12	C±0.10	D±0.25	E±0.07	PART NUMBER	PART NUMBER
09	30.81	24.99	16.96	16.21	10.96	D09S90C4PX00LF	D09S90C6PX00LF
15	39.14	33.32	25.18	24.54	19.18	D15S90C4PX00LF	D15S90C6PX00LF
25	53.03	47.04	39.12	38.25	33.12	D25S90C4PX00LF	D25S90C6PX00LF
37	69.32	63.50	55.68	54.71	49.68	D37S90C4PX00LF	D37S90C6PX00LF
						gold flash	0.76µ gold

GENERAL CHARACTERISTICS AND ROHS INFORMATIONS:

SEE DRAWING C01-8646-0001

European Views

www.fciconnect.com		surface ISO 1302 ✓	tolerance std ISO 406 ISO 1101	projection mm
TOLERANCES UNLESS OTHERWISE SPECIFIED				size A3
Dr	PESSON	1996/07/23	ANGULAR	Scale 2
Eng	PESSON	1996/07/23	LINEAR	ECN LS06-0140
Chr	LEGARE	1996/07/23	0.xx' ± 2'	Spec ref -
Appr	LEGARE	1996/07/23	Product family	D-SUB
FCi		title FEMALE CONNECTOR DELTA D LOW PROFIL straight press-fit		dwg no C01-8646-0462
catalog no		-		Rev. D
CUSTOMER			sheet 1 of 1	

rev	ecn no	dr	date
A	-	-	1996/07/23
B	LS05-004	MPE	2005/02/14
C	LS06-0097	LGO	2006/07/28
D	LS06-0140	LGO	2006/09/23
-	-	-	-
-	-	-	-
-	-	-	-