

Recommended PCB Layout
(Tolerance: ±0.05mm)

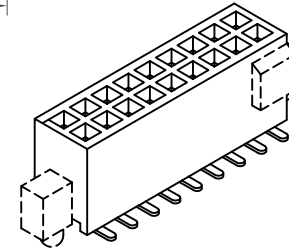
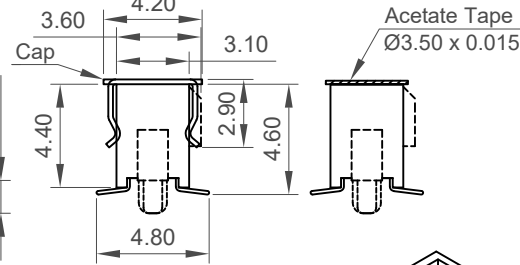
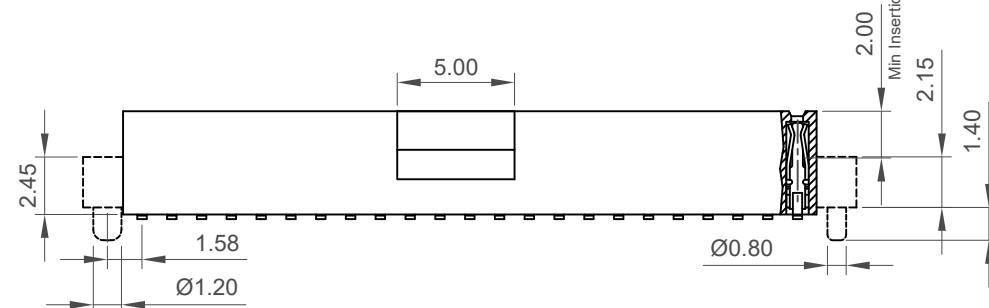

No. of Contacts	Dimensions			
	A	B	C	D
06	2.56	4.18	7.58	5.71
08	3.81	5.43	8.83	6.96
10	5.08	6.70	10.10	8.23
12	6.35	7.97	11.37	9.50
14	7.62	9.24	12.64	10.77
16	8.89	10.51	13.91	12.04
18	10.16	11.78	15.18	13.31
20	11.43	13.05	16.45	14.58
22	12.70	14.32	17.72	15.85
24	13.97	15.59	18.99	17.12
26	15.24	16.86	20.26	18.39
28	16.51	18.13	21.53	19.66
30	17.78	19.40	22.80	20.93
32	19.05	20.67	24.07	22.20
34	20.32	21.94	25.34	23.47
36	21.59	23.21	26.61	24.74
38	22.86	24.48	27.88	26.01
40	24.13	25.75	29.15	27.28
42	25.40	27.02	30.42	28.55
44	26.67	28.29	31.69	29.82
46	27.94	29.56	32.96	31.09
48	29.21	30.83	34.23	32.36
50	30.48	32.10	35.50	33.63
52	31.75	33.37	36.77	34.90
54	33.02	34.64	38.04	36.17
56	34.29	35.91	39.31	37.44
58	35.56	37.18	40.58	38.71
60	36.83	38.45	41.85	39.98
62	38.10	39.72	43.12	41.25
64	39.37	40.99	44.39	42.52
66	40.64	42.26	45.66	43.79
68	41.91	43.53	46.93	45.06
70	43.18	44.80	48.20	46.33
72	44.45	46.07	49.47	47.60
74	45.72	47.34	50.74	48.87
76	46.99	48.61	52.01	50.14
78	48.26	49.88	53.28	51.41
80	49.53	51.15	54.55	52.68
82	50.80	52.42	55.82	53.95
84	52.07	53.69	57.09	55.22
86	53.34	54.96	58.36	56.49
88	54.61	56.23	59.63	57.76
90	55.88	57.50	60.90	59.03
92	57.15	58.77	62.17	60.30
94	58.42	60.04	63.44	61.57
96	59.69	61.31	64.71	62.84
98	60.96	62.58	65.98	64.11
100	62.23	63.85	67.25	65.38

Specifications 规格

Material 物料

Contact 接触: Phosphor Bronze
Insulator 绝缘体: Polyester, LCP, UL 94V-0

Electrical 电气

Current Rating 电流额定值: 1.0 amp
Insulation Resistance 绝缘电阻值: 1000 MΩ min.
Dielectric Withstanding 耐电压: 300 V AC
Contact Resistance 接触电阻值: 20 mΩ max.

Mechanical & Environmental 机械 & 环境

Operating Temperature 工作温度: -40°C to +105°C
Soldering Process 可焊性:
IR Reflow 回流焊: 260°C for 10 sec.
Manual Solder 人工焊接: 350°C for 3-5 sec

Mates with 配套之母座 (Subject to pin length)

BD025 BD030 BD031 BD033 BD035
BD038 BD040 BD095

Ordering Grid

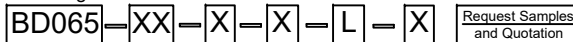

No. of Contacts
06 to 100
100 Contacts = 00

Contact Plating

A = Gold Flash All Over (Standard)
B = Selective Gold Flash Contact Area/
Tin On Tail
C = Tin All Over
G = 10µ" Gold Contact Area/Tin On Tail
I = 30µ" Gold Contact Area/Tin On Tail

Request Samples and Quotation

Packing Options

C = Tape & Reel with Film (Standard)
B = Tape & Reel with Cap
D = Tube
E = Tube with Cap
F = Tube with Film
Insulator Material
L = LCP
Locating Peg
0 = Without Peg & Bump
1 = With Peg & Bump

Part Number		Product Description	
BD065		1.27mm Pitch Socket, Dual Row, Surface Mount, Top Entry	
Drawing Date		28th December 2007	
By	AJO	Tolerances (Except as Noted)	
Detail	BD065 J PCN	Length X. ± 0.30 X.X ± 0.20 X.XX ± 0.15 X.XXX ± 0.10	Angle X.° ± 5° X.X° ± 3° X.XX° ± 2° X.XXX° ± 1°
Revision	J1	Units: Metric (mm)	
Date	24/05/06		
		This drawing is confidential and copyright of Global Connector Technology, Ltd (GCT). This drawing must not be copied or disclosed without written consent. E & OE	

GCT

Global Connector Technology
www.gct.co

Not to Scale Drawn By LYH Sheet No. 1/1