

SPECIFICATIONS

Current Rating: 3Amp
 Contact Material: Phosphor Bronze
 Contact Resistance: 20mΩ Max.
 Insulation Material: Polyester, UL94V-0
 Insulation Resistance: 1000MΩ Min.
 Withstanding: 600V AC/DC
 Operating Temperature: -40C to +105C

Recommended P.C.Board

Hole Layout

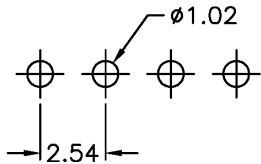

Series	Rows	Profile	Positions	Plating	Options
ARS	XX	L3	XX	XX	XX
.100 Receptacle Strip	01=Single Row 02=Dual Row 03=Single Row R/A 04=Dual Row R/A	L3=5.65mm Others available	Single Row 02-40 Dual Row 04-80	TN=Tin SGXX=Selective Gold GDXX=Gold XX=Flash if blank, 15,30,50u"	Blank=None SM=Surface Mount

RoHS compliant

Rev.	Description	Date	Approved	Drawing	Name	Date
				Approved	Howard	09/20/05
				Checked	Lizzy	09/20/05
				Drawn	Tina	09/20/05
				0.0 ± 0.35	0.00 ± 0.20	Angles ± 3'
				UNIT: mm		

Central Components Manufacturing
 440 Lincoln Blvd., Middlesex, New Jersey 08846
 Phone 732 469-5720 888 288-5152 Fax 732 469-1919

Part No.: **ARS-01-L3-XX-XX-XX**

Description: .100 Receptacle Strip, Single Row, 5.65mm Profile