

MATERIAL

Body

Pin Header
Socket Housing) Nylon
Color Black
Flammability Rating .. UL94V-0

Contact

Pin Brass (Tin Alloy plated)
Socket Phosphor Bronze (Tin Alloy plated)

PERFORMANCE CHARACTERISTICS

Operating Temperature -25°C ~ +85°C
Working Voltage A.C. 250V
Current Rating 1A
Contact Resistance 20mΩ Max.
Insulation Resistance 1000MΩ Min.
Dielectric Withstanding Voltage ... A.C. 1000V (1 minute)
Durability Contact Resistance 50mΩ Max.
after 20 insertions and withdrawals

ORDERING INFORMATION

Pin Header

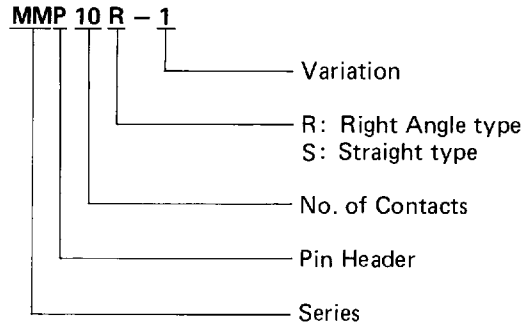

Socket Housing

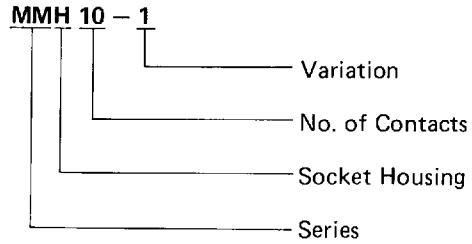

DIMENSIONS

Pin Header (Right Angle type)

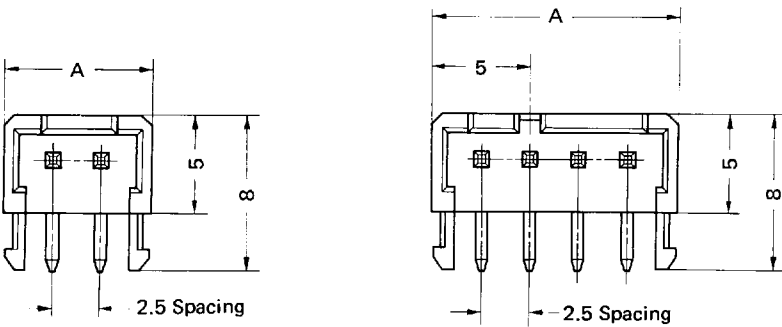

Fig. 1

Fig. 2

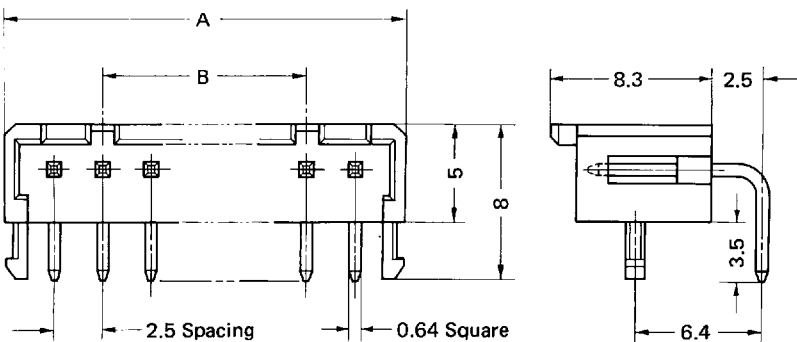

Fig. 3

Catalog Number	No. of Contacts	Fig. No.	Dimensions	
			A	B
MMP2R-1	2	1	7.5	—
MMP3R-1	3	2	10.0	—
MMP4R-1	4		12.5	—
MMP5R-1	5	3	15.0	5.0
MMP6R-1	6		17.5	7.5
MMP7R-1	7		20.0	10.0
MMP8R-1	8		22.5	12.5
MMP9R-1	9		25.0	15.0
MMP10R-1	10		27.5	17.5
MMP11R-1	11		30.0	20.0
MMP12R-1	12		32.5	22.5
MMP13R-1	13		35.0	25.0
MMP14R-1	14		37.5	27.5
MMP15R-1	15	40.0	30.0	
MMP16R-1	16	42.5	32.5	
MMP17R-1	17	45.0	35.0	
MMP18R-1	18	47.5	37.5	
MMP19R-1	19	50.0	40.0	
MMP20R-1	20	52.5	42.5	

NOTE: All dimensions in mm

Pin Header (Straight type)

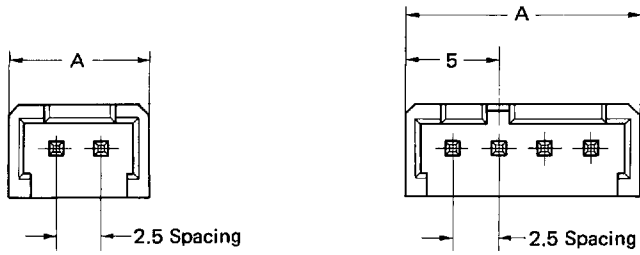

Fig. 1

Fig. 2

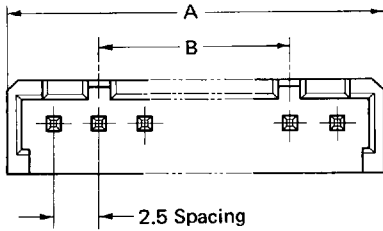
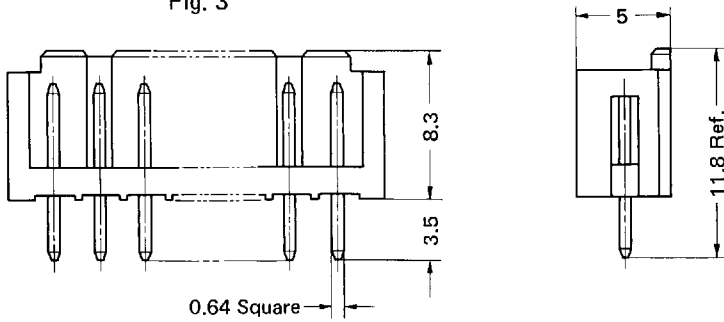

Fig. 3



Socket Housing

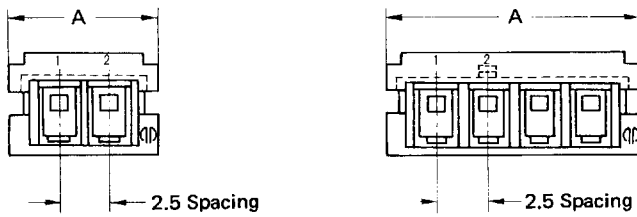

Fig. 1

Fig. 2

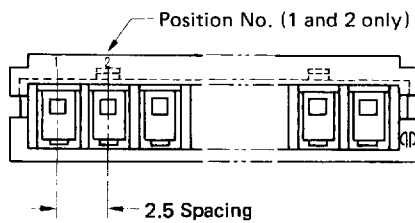
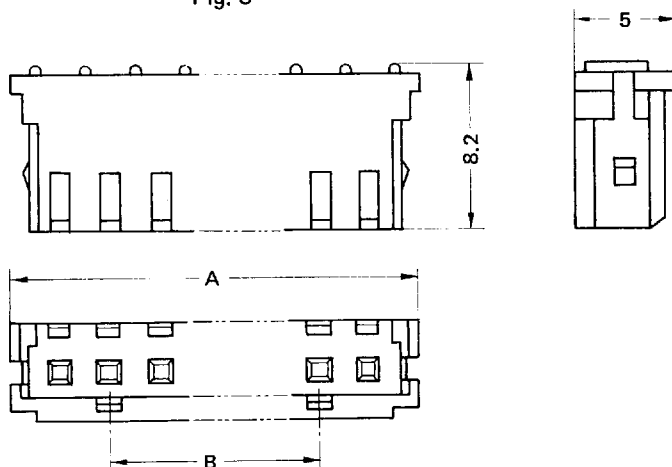

Fig. 3



Catalog Number	No. of Contacts	Fig. No.	Dimensions	
			A	B
MMP2S-1	2	1	7.5	—
MMP3S-1	3	2	10.0	—
MMP4S-1	4		12.5	—
MMP5S-1	5	3	15.0	5.0
MMP6S-1	6		17.5	7.5
MMP7S-1	7		20.0	10.0
MMP8S-1	8		22.5	12.5
MMP9S-1	9		25.0	15.0
MMP10S-1	10		27.5	17.5
MMP11S-1	11		30.0	20.0
MMP12S-1	12		32.5	22.5
MMP13S-1	13		35.0	25.0
MMP14S-1	14		37.5	27.5
MMP15S-1	15		40.0	30.0
MMP16S-1	16		42.5	32.5
MMP17S-1	17		45.0	35.0
MMP18S-1	18		47.5	37.5
MMP19S-1	19		50.0	40.0
MMP20S-1	20		52.5	42.5

Catalog Number	No. of Contacts	Fig. No.	Dimensions	
			A	B
MMH2-1	2	1	7.5	—
MMH3-1	3	2	10.0	—
MMH4-1	4		12.5	—
MMH5-1	5	3	15.0	5.0
MMH6-1	6		17.5	7.5
MMH7-1	7		20.0	10.0
MMH8-1	8		22.5	12.5
MMH9-1	9		25.0	15.0
MMH10-1	10		27.5	17.5
MMH11-1	11		30.0	20.0
MMH12-1	12		32.5	22.5
MMH13-1	13		35.0	25.0
MMH14-1	14		37.5	27.5
MMH15-1	15		40.0	30.0
MMH16-1	16		42.5	32.5
MMH17-1	17		45.0	35.0
MMH18-1	18		47.5	37.5
MMH19-1	19		50.0	40.0
MMH20-1	20		52.5	42.5

RECOMMENDED PC BOARD

- Thickness: 1.4 ~ 1.8
- Hole Pattern

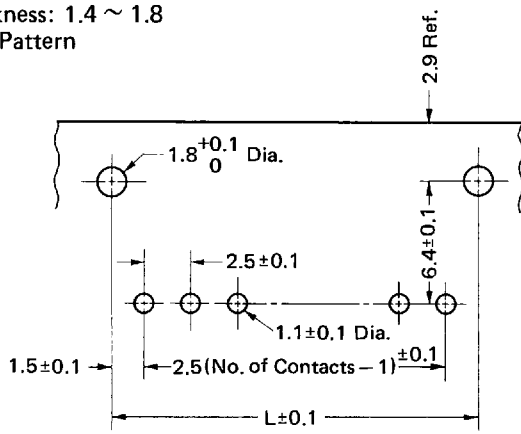

Right Angle type

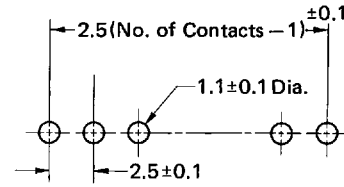

Straight type

No. of Contacts	2	3	4	5	6	7	8	9	10	11	12	13	14	15	16	17	18	19	20
L	5.5	8.0	10.5	13.0	15.5	18.0	20.5	23.0	25.5	28.0	30.5	33.0	35.5	38.0	40.5	43.0	45.5	48.0	50.5

CONTACT

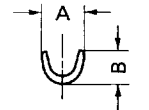
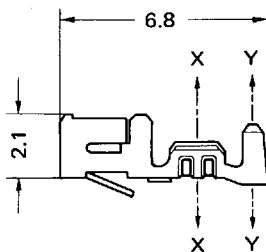

Section X-X

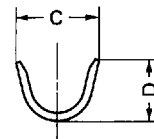

Section Y-Y

Catalog Number	Accommodated Wire			Dimensions				Installation Tool	
	Conductor Size (AWG)	Insulation Dia.	Strip Length	A	B	C	D	Manual	Semi-Auto
MMC28 - 1	#30 ~ #28	0.9 ~ 1.25	3.0 ± 0.5	1.1	0.95	2.2	1.7	Y24MHT	JCM-03K28
MMC24 - 1	#26 ~ #24	1.2 ~ 1.6		1.4	1.15	2.7	2.0		JCM-03K24

INSTALLATION TOOLING

● JCM - 03

- Semi-automatic crimping machine
- Electrically operated to install strip feed contacts

Dimensions: 270^W x 410^D x 385^H
 Weight: 77.5kg
 Power: A.C. 100V 50/60Hz
 250W

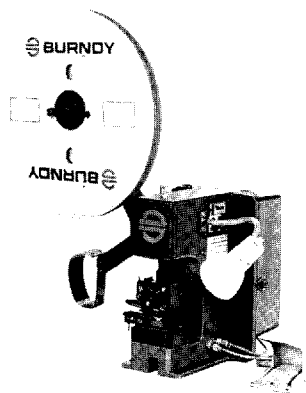

● Y24MHT

- Manual crimping tool
- Pre-stripped wire (#30 ~ #24 AWG) and strip feed contacts can be installed and contacts can be cut away from the selvage strip.

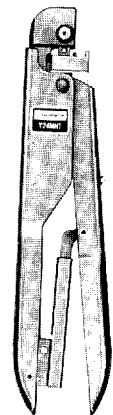

NOTE: All dimensions in mm

BURNDY
JAPAN, Ltd.

5TH FLOOR, SHUWA-SHINAGAWA BLDG 26-33, 3-CHOME, TAKANAWA
 MINATO-KU, TOKYO, JAPAN TELEPHONE TOKYO 443-7212.
 TELEX NO. 242-5124 (BJTOK J). CABLE ADDRESS BURNDY JAPAN