

**SPECIFICATION:**  
 Current Rating: 3A  
 Voltage Rating: 250V AC, DC  
 Withstanding Voltage: 800V AC/Minute  
 Contact Resistance: 20 Milliohms Max.  
 Insulation Resistance: 1000 Megohms Min.  
 Temperature Range: -25°C to +85°C  
 Applicable PCB Thickness: 1.6mm  
 Applicable PCB Hole Dia.:  $\phi 1.1 \pm 0.05$  mm  
 Applicable Wire Range: AWG #22~#28  
 Insulator: P.B.T UL 94V-0 w/30%GF  
 Contact: Brass, Tin Plated  
 Q'ty/Bag: 500PCS

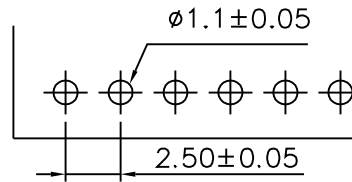

P.C.B Layout

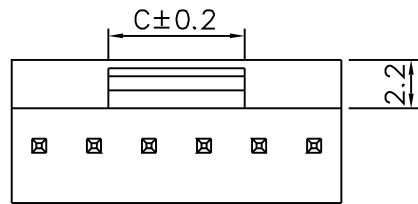
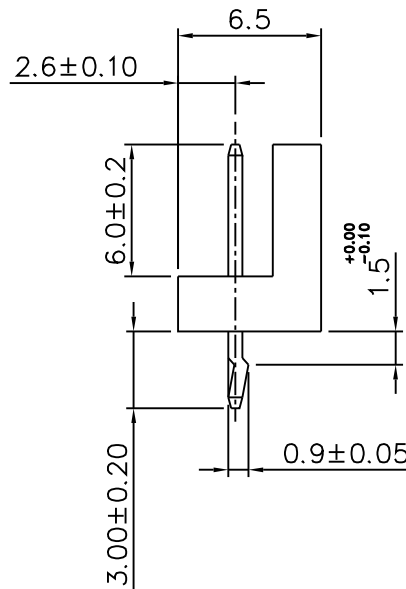
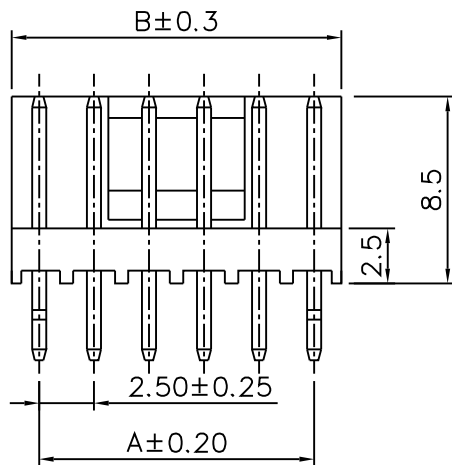

Circuits	Dimensions		
	A	B	C
2	2.5	5.0	2.2
3	5.0	7.5	2.7
4	7.5	10.0	5.2
5	10.0	12.5	5.2
6	12.5	15.0	6.2
7	15.0	17.5	8.2
8	17.5	20.0	10.2
9	20.0	22.5	10.2
10	22.5	25.0	10.2
11	25.0	27.5	11.2
12	27.5	30.0	11.2
13	30.0	32.5	13.2
14	32.5	35.0	13.2



A MEMBER OF AUK GROUP

**太聯事業股份有限公司**  
**AUK CONTRACTORS CO., LTD.**

CATEGORY		APPROVED BY		UNLESS OTHERWISE SPECIFIED TOLERANCES ARE .X ±0.25 .XX ±0.15 .XXX ±0.08
Housing		MEI		
PART No.		CHECKED BY		
JSXXD		LHC		
DRAWING No.		DRAWING BY		UNIT mm
JSXXD		HZF		
SCALE	NONE	REV.	A	

AREA	REVISIONS	CHK	DATE
------	-----------	-----	------