

PRODUCT NO.
87320-XYHLF

LEAD FREE OPTION
NOTE 7, 8, 9
NO. OF POSITIONS
SEE TABLE
PIN PLATING
BASE PART NO.

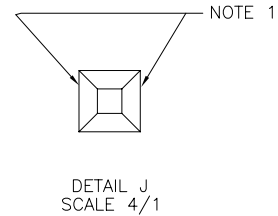

□ .025/.64 PIN
TYP
⊕ .020/.51 (M) A (S) B (S)
AT TIPS
BOTH ENDS

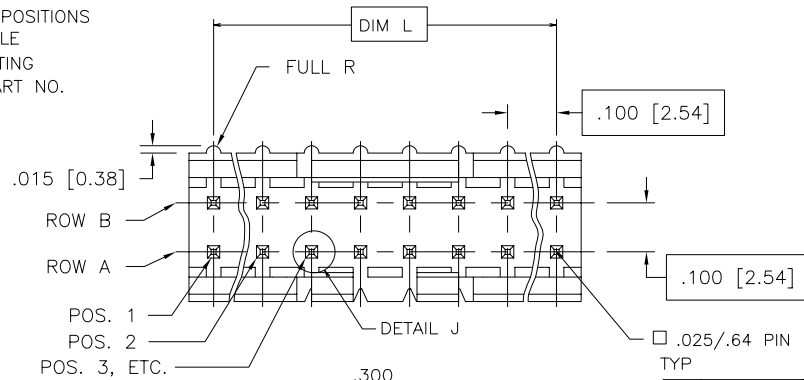
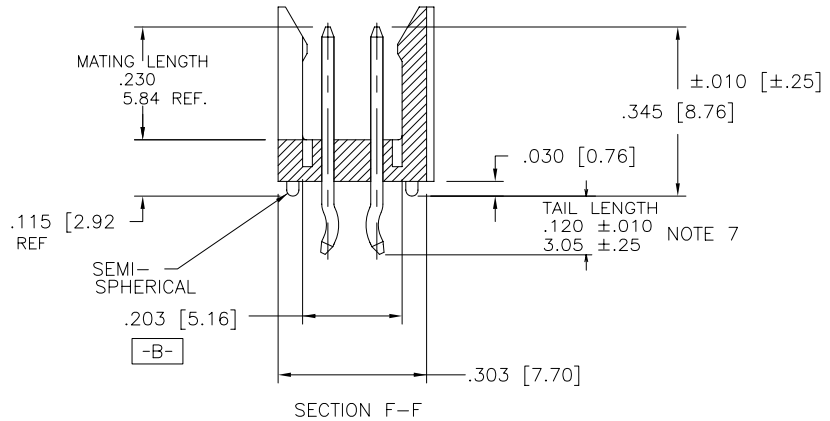
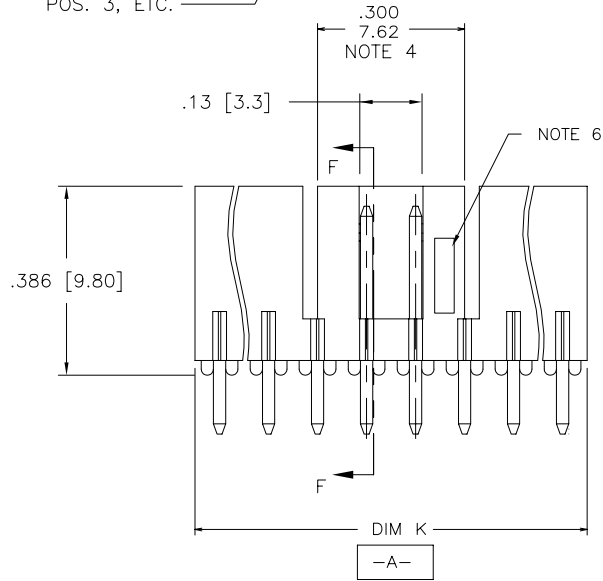

mat'l. code		surface ISO 1302 ✓		tolerance ISO 406 ISO 1101		projection ⊕		product family HEADER	
ltr	ecn no	dr	date	tolerances unless otherwise specified		INCH/MM		title	
A	V50698	LSS	7/17/95	angles	linear	.xx±.01/0.3		FRICTION LATCH HEADER	
B	V71186	HTB	9/15/97			.xxx±.005/0.13		DOUBLE ROW VERT. SELF RET.	
C	V71470	HTB	10/9/97	0°±2'		.xxxx±.0020/0.051		scale 3:1	
D	V03-0352	GJP	03/25/03	dr	J.SHREINER	6/6/89		dwg no	
E	M05-0134	ERE	06/15/05	enr	H.SUNDY	6/6/89		sheet 1 of 2 size	
F	M06-0256	MHT	9/07/06	chr	T.BREWBAKER	7/17/95		87320 A3	
sheet index		revision		F F		L.FYE		7/17/95	
sheet		sheet		1 2				type Product Customer Drawing	



Copyright FCI

PRODUCT NUMBER	NO. OF POS.	DIM K	DIM L
87320-X06	2 X 3	.300/7.62	.200/5.08
-X08	2 X 4	.400/10.16	.300/7.62
-X10	2 X 5	.500/12.70	.400/10.16
-X12	2 X 6	.600/15.24	.500/12.70
-X14	2 X 7	.700/17.78	.600/15.24
-X16	2 X 8	.800/20.32	.700/17.78
-X18	2 X 9	.900/22.86	.800/20.32
-X20	2 X 10	1.000/25.40	.900/22.86
-X22	2 X 11	1.100/27.94	1.000/25.40
-X24	2 X 12	1.200/30.48	1.100/27.94
-X26	2 X 13	1.300/33.02	1.200/30.48
-X28	2 X 14	1.400/35.56	1.300/33.02
87320-X30	2 X 15	1.500/38.10	1.400/35.56

NOTES:

1. MOLDING MAT'L: GLASS REINFORCED PCT, COLOR: BLACK
FLAME RETARDANT PER 'UL94V-0.
MAXIMUM OPERATING TEMPERATURE: 130° C.
2. PIN MATERIAL: 3/4 HD PHOS. BRZ.
3. NO SLOTS ON 2 X 5 POSITION OR SMALLER PRODUCT. THE CENTER KEY SLOT WILL BE ON ALL HEADERS REGARDLESS OF SIZE.
4. TWO NON-CRITICAL SIDES OF PIN TIP NOT PLATED, BOTH ENDS.
5. COMPANY LOGO MAY APPEAR IN THIS AREA.
6. (1) PAIR RETENTION LEGS PER PART LOCATED IN APPROXIMATE CENTER OF PART.
7. ADD "HLF" SUFFIX AT THE END OF PART NUMBER FOR LEAD FREE OPTION, NOT AVAILABLE FOR -5YY, -5YYH, -6YY & -6YYH.
8. PART NUMBERS WITH "H" SUFFIX WILL WITHSTAND EXPOSURE TO 260°C PEAK TEMPERATURE FOR 20 SECONDS IN WAVE SOLDER, INFRA-RED OR VAPOR PHASE SOLDER PROCESS.

PART NUMBERS WITHOUT "H" SUFFIX WILL WITHSTAND EXPOSURE TO 260°C PEAK TEMPERATURE FOR WAVE SOLDER PROCESS.
9. THIS PRODUCT MEETS EUROPEAN UNION DIRECTIVES AND OTHER COUNTRY REGULATION AS DESCRIBED IN GS-22-008.
10. PLATING OPTIONS: MAY BE EITHER GOLD OR GXT PLATED AT MANUFACTURER'S OPTION.
11. "THIS PRODUCT HAS 100% TIN PLATING IN THE INTERFACE AND HAS NOT BEEN TESTED FOR WHISKER GROWTH IN ALL INTERCONNECT ENVIRONMENTS."

PIN PLATING CODES

-1YY	30u"/.76u (SEE NOTE 10) 50u"/1.27u Ni
-2YY	15u/.38u (SEE NOTE 10) 50u"/1.27u Ni
-3YY	50u"/1.27u Au 50u"/1.27u Ni
-4YY	100u"/2.54u MIN Sn 50u"/1.27u Ni (SEE NOTE 11)
-4YYHLF	
-5YY	15u"/.38u (SEE NOTE 10) 50u"/1.27u Ni
-6YY	30u"/.76u (SEE NOTE 10) 50u"/1.27u Ni
-7YY	30u"/.76u Au OVER 50u"/1.27u Ni
-8YY	15u"/.38u Au OVER 50u"/1.27u Ni

mat'l. code		surface ISO 1302 ✓		tolerance ISO 406 ISO 1101		projection ⊕		product family HEADER	
ltr		ecn no dr		date		tolerances unless otherwise specified		title	
F						.XX±.01/0.3 linear .xxx±.005/0.13 0'±2' .xxx±.0020/0.051		FRICION LATCH HEADER DOUBLE ROW VERT. SELF RET.	
						scale 3:1		dwg no sheet 2 of 2 size	
						FCI		87320 A3	
								type Product Customer Drawing	
sheet index		revision sheet							