

1136 Series

2.54 mm PIN Header
 Double Row, Right Angle

Ordering Information

1136 - X X XX - XX R

Contact Plating
 A - Gold Flash
 B - 10 μ"
 C - 15 μ"
 G - 3 μ"
 0 - Gold Flash /Tin 100 μ"
 1 - 10 μ"/Tin 100 μ"
 3 - 30 μ"/Tin 100 μ"
 4 - 3 μ"/Tin 100 μ"
 5 - 15 μ"/Tin 100 μ"
 8 - Tin 100 μ"

NO. of Contact
 2-80 position

R - Right Angle

PIN Type
 SEE DIM. A ,TABLE 1

Insulator Type
 0 - 2.54mm High(PBT)
 2 - HSG with Wall
 5 - Triple type (Thermoplastic)
 6 - Dual type (PBT)

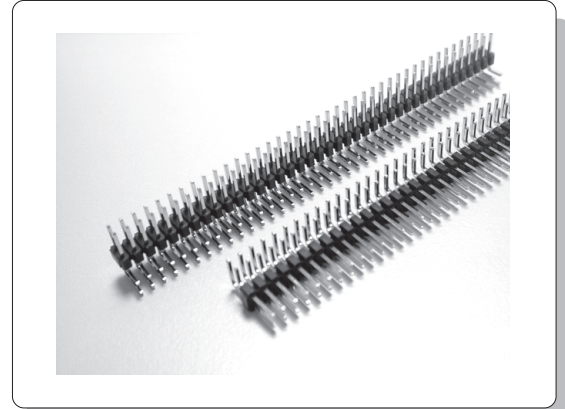

Specification

Materials:

- ◆ **Insulator:** Glass Reinforced Thermoplastic UL94V-0.
- ◆ **Contact:** Copper Alloy 0.025" (0.64mm) Square PIN.
- ◆ **Plating:** Selected Glod

Electrical:

- ◆ **Insulation Resistance:** 5000 MΩ Minimum.
- ◆ **Voltage Rating:** 250 VAC R.M.S.
- ◆ **Dielectrical Withstanding Voltage:** 500 VAC R.M.S.
- ◆ **Current Rating:** 1 AMP.

Enviromental

- ◆ Temperature: -55°C to +125°C

Dimensions

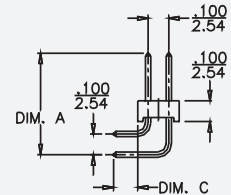
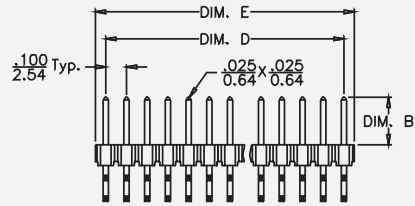
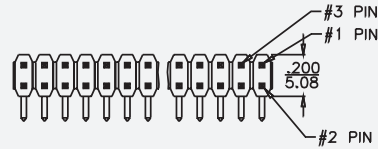

$$\text{DIM. D} = \frac{100''}{2.54\text{mm}} \times \langle \text{NO. OF SPACE} \rangle$$

$$\text{DIM. E} = \text{DIM. D} + \frac{100''}{2.54\text{mm}}$$

RECOMMENDED P.C.B. LAYOUT

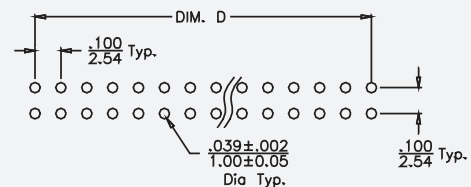

PRODUCT NO.	DIM. A		DIM. B		DIM. C	
	mm	in	mm	in	mm	in
1136-X031-XXR	12.38	0.487	5.80	0.228	2.60	0.102
1136-X036-XXR	12.70	0.500	6.10	0.240	3.50	0.138
1136-X038-XXR	12.60	0.496	6.00	0.236	3.20	0.126
1136-X042-XXR	10.40	0.409	3.80	0.150	3.80	0.150