

SILICON PRESS-FIT DIODES

VOLTAGE RANGE: 50 -- 600 V

CURRENT: 35 A

FEATURES

- ◇ Norminal current 35A
- ◇ Repetitive peak reverse voltage 600 V
- ◇ Metal press -fit case with plastic cover
- ◇ Casting compound has UL classification

94V-0

BYP

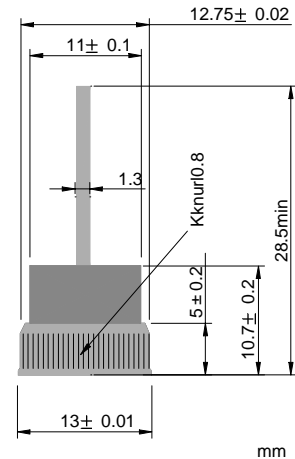

MAXIMUM RATINGS AND ELECTRICAL CHARACTERISTICS

Ratings at 25°C ambient temperature unless otherwise specified.

		BYP 35A05	BYP 35A1	BYP 35A2	BYP 35A3	BYP 35A4	BYP 35A6	UNITS
Wire to anode		BYP 35K05	BYP 35K1	BYP 35K2	BYP 35K3	BYP 35K4	BYP 35K6	
Wire to cathode								
Repetitive peak reverse voltage	V_{RRM}	50	100	200	300	400	600	V
Surge peak reverse voltage	V_{RSM}	60	120	240	360	480	700	V
Max.average forward rectified current, R-load @ $T_c=150^\circ\text{C}$	$I_{F(AV)}$	35						A
Repetitive peak forward current $f > 15\text{Hz}$ (NOTE1)	I_{FRM}	110						A
Peak forward surge current,50/60 Hz half sine-wave	I_{FSM}	360/400						A
Forward voltage @ $I_F=35\text{A}$	V_F	1.1						V
Leakage current @ $T_j=25^\circ\text{C}$	I_R	100						μA
Rating for fusing $t < 10\text{ms}$	i^2t	660.0						A^2S
Thermal resistance junction to case	R_{thc}	0.8						K/W
Operating junction temperature	T_j	- 55 --- + 215						$^\circ\text{C}$
Storage temperature range	T_s	- 55 --- + 215						$^\circ\text{C}$

NOTE: Max.case temperature $T_c=150^\circ\text{C}$ -Max.

www.galaxycn.com

FIG.1 – TYPICAL FORWARD CHARACTERISTIC

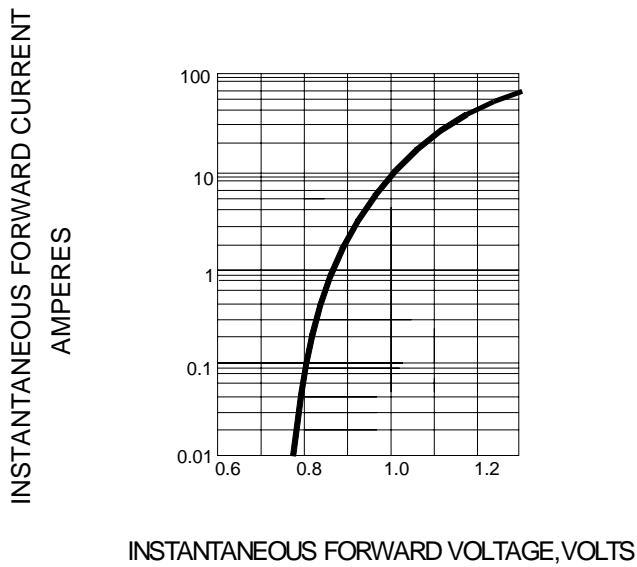

FIG.2 – FORWARD DERATING CURRENT

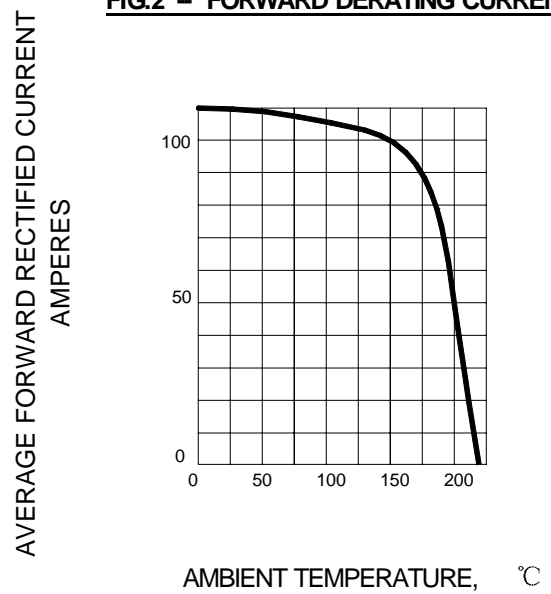

FIG.3 – PEAK FORWARD SURGE CURRENT

