

Rev	AWO #	Description	Date	Appr
-		RELEASED	1/4/11	

APPROVED: \_\_\_\_\_  
 DATE: \_\_\_\_\_ TITLE: \_\_\_\_\_

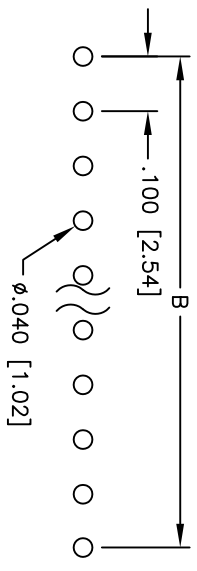

RECOMMENDED  
PCB LAYOUT

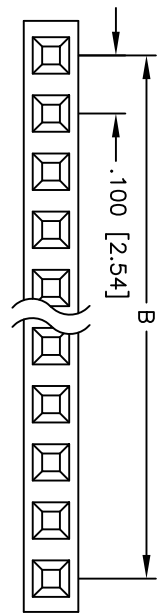
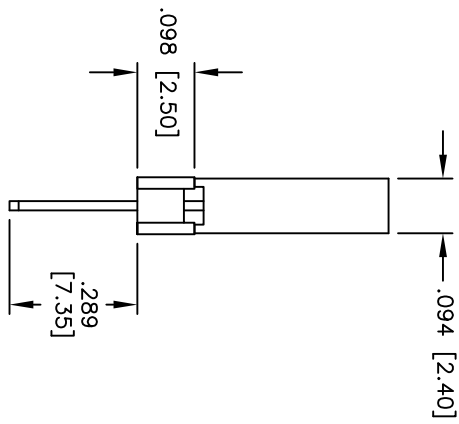
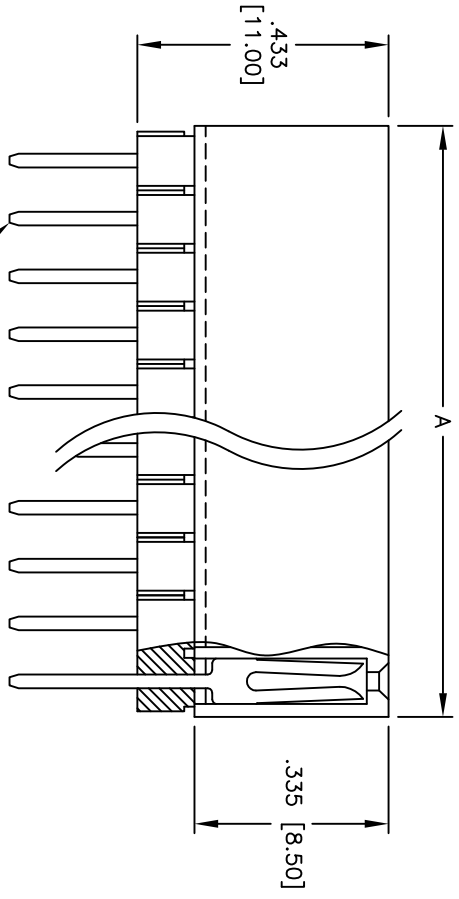

**SPECIFICATIONS:**

- Material: Insulator: PBT, glass reinforced, rated UL 94V-0
- Insulator color: Black
- Contacts: Brass
- Plating: Gold flash over Nickel underplate overall
- Electrical: Operating voltage: 250 VAC max. Current rating: 3 Amps max. Contact resistance: 20 mohms max. initial Insulation resistance: 5,000 Mohms min. Dielectric withstanding voltage: 500 VAC for 1 minute
- Temperature Rating: Operating temperature: -40°C to +105°C
- Environmental: Lead free, RoHS compliant
- Recommended soldering temp: 235°C for 5 seconds

Positions: 01 thru 40  
 A = .100 [2.54] x No. of Positions + .020 [0.50]  
 B = .100 [2.54] x No. of Spaces

UNLESS OTHERWISE SPECIFIED  
ALL DIMENSIONS ARE INCHES [MM]

.X	± .10	ØXX	± .10
.XX	± .020	ØXXX	± .015
.XXX	± .015	ØXXXX	± .010

APPROVALS

APPROVED	DATE
AY	1/4/11
VW	1/4/11

**ADAM TECH**

909 Railway Avenue, Union, NJ 07083  
 Phone: 908-687-5000 Fax: 908-687-5710

TITLE: .100 [2.54] SINGLE ROW RECEPTACLE STRIP  
 ELEVATED SOCKET, 1 INSULATOR

DRAWN	AY	1/4/11	SIZE	PART NO.	REV.
CHECKED	VW	1/4/11	X	RSE1-1-XX-G-.289	-
APPROVED			REF:	S00039T	SHEET 1 OF 1