

Recommended PCB Layout

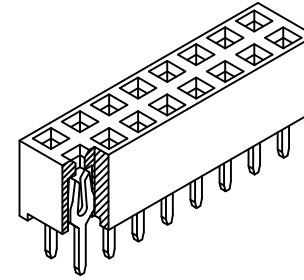
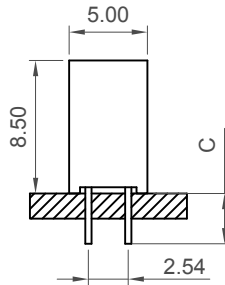
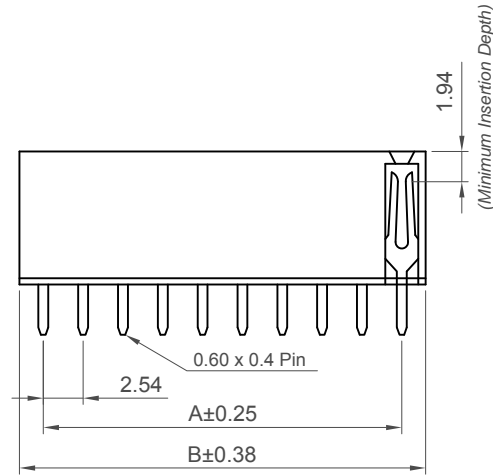

Number of Contacts	Dimensions	
	A	B
4	2.54	5.58
6	5.08	8.12
8	7.62	10.66
10	10.16	13.20
12	12.70	15.74
14	15.24	18.28
16	17.78	20.82
18	20.32	23.36
20	22.86	25.90
22	25.40	28.44
24	27.94	30.98
26	30.48	33.52
28	33.02	36.06
30	35.56	38.60
32	38.10	41.14
34	40.64	43.68
36	43.18	46.22
38	45.72	48.76
40	48.26	51.30
42	50.80	53.84
44	53.34	56.38
46	55.88	58.92
48	58.42	61.46
50	60.96	64.00
52	63.50	66.54
54	66.04	69.08
56	68.58	71.62
58	71.12	74.16
60	73.66	76.70
62	76.20	79.24
64	78.74	81.78
66	81.28	84.32
68	83.82	86.86
70	86.36	89.40
72	88.90	91.94
74	91.44	94.48
76	93.98	97.02
78	96.52	99.56
80	99.06	102.10

Specifications 规格

Material 物料

Contact 端子: Copper Alloy
 Insulator Material 绝缘体:
 Standard 标准: Polyamide, Nylon 6T, UL 94V-0
 Options 可选: Polyester, LCP, UL 94V-0
 Polyester, PBT, UL 94V-0

Electrical 电气

Current Rating 电流额定值: 3 Amp
 Insulator Resistance 绝缘电阻值: 1000 MΩ min.
 Contact Resistance 接触电阻值: 20 mΩ max.
 Dielectric Withstanding 耐压: AC 600 V

Environmental & Mechanical 机械 & 环境

Operating Temperature 工作温度: -40° to +105°C
 Soldering Process 可焊性:

Nylon 6T (Standard 标准物料) -
 IR Reflow 回流焊: 260°C for 10 sec.
 Wave 波峰焊: 230°C for 5-10 sec.
 Manual Solder 人工焊接: 350°C for 3-5 sec

LCP (Option 可选物料) -
 IR Reflow 回流焊: 260°C for 10 sec.
 Wave 波峰焊: 250°C for 5-10 sec.
 Manual Solder 人工焊接: 350°C for 3-5 sec

PBT (Option 可选物料)
 Manual solder 人工焊接: 330°C for 3-5 sec.
 (Not suitable for hi-temp process 不适合高温处理)

Mates with 配套之母座 (subject to pin length 在端子长度适合的条件下)

BG025 BG040 BG045 BG050
 BG065 BG070 BG085

Ordering Grid

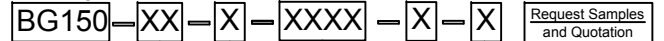

No. of Contacts
04 to 80

Contact Plating

A = Gold Flash All Over (Standard)
 B = Selective Gold Flash Contact
 Area/Tin On Tail

C = Tin All Over
 G = 10µ" Gold Contact Area/Tin On Tail
 I = 30µ" Gold Contact Area/Tin On Tail

Packing Options

D = Tube (Standard)
 E = Tube with Cap
 F = Tube with Film
 G = Plastic Box

Insulator Material

N = Nylon 6T (Standard)
 P = PBT
 L = LCP

Dimension C (1/100mm) (Tail Length)

0320 = 3.20mm (Standard)
 0300 = 3.00mm

Part Number		Product Description	
BG150		2.54mm Pitch Socket	
Drawing Date		Dual Row, Through Hole, Vertical	
30th October 2006			
By	AJO	Tolerances (Except as Noted)	
Detail	BG150 IPCN	Length	Angle
Revision	I	X ± 0.30	X° ± 5°
Date	21/07/15	X.X ± 0.20	X.X° ± 2°
		X.XX ± 0.15	X.XX° ± 1°
		X.XXX ± 0.10	X.XXX° ± 0.5°
		Units:	Metric (mm)
		This drawing is confidential and copyright of Global Connector Technology, Ltd (GCT). This drawing must not be copied or disclosed without written consent. E & OE	

GCT
 Global Connector Technology
 www.gct.co

Not to Scale	Drawn By AJO	Sheet No. 1/1
--------------	-----------------	------------------