

No. of Contacts	DIMENSIONS	
	A	B
6	5.08	8.12
8	7.62	10.66
10	10.16	13.20
12	12.70	15.74
14	15.24	18.28
16	17.78	20.82
18	20.32	23.36
20	22.86	25.90
22	25.40	28.44
24	27.94	30.98
26	30.48	33.52
28	33.02	36.06
30	35.56	38.60
32	38.10	41.14
34	40.64	43.68
36	43.18	45.72
38	45.72	48.76
40	48.26	51.30
42	50.80	53.84
44	53.34	55.88
46	55.88	58.42
48	58.42	61.46
50	60.96	64.00
52	63.50	66.54
54	66.04	69.08
56	68.58	71.62
58	71.12	74.16
60	73.66	76.70
62	76.20	79.24
64	78.74	81.78
66	81.28	84.32
68	83.82	86.86
70	86.36	89.40
72	88.90	91.94
74	91.44	94.48
76	93.98	97.02
78	96.52	99.56
80	99.06	102.10

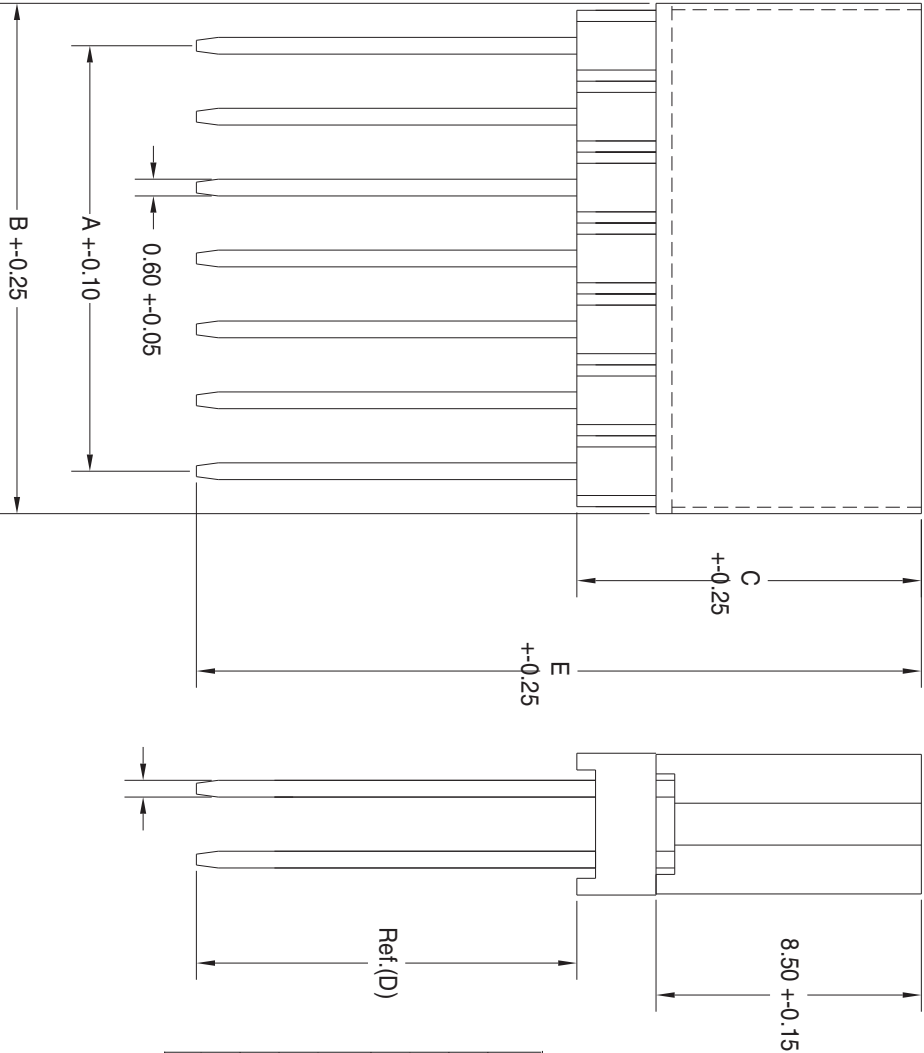
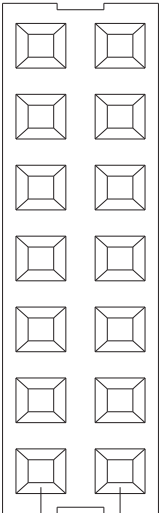

SPECIFICATIONS

Current Rating: 3 Amp
 Insulator Resistance: 5000 Mega Ohm Min.
 Contact Resistance: 20 milli Ohm Max.
 Dielectric Withstanding: 500 VAC
 Operating Temperature: -40 Degree C. to +105 Degree C.
 Contact Material: Phosphor Bronze
 Insulator Material: Polyester, UL 94V-0
 © Standard: P.B.T
 Finish: Tin, Gold or Selective Plating

PART NUMBER	# of SPACERS	C	D	E
PPPCxx2LFHN-M44	1	11.05	7.35	18.40
PPPCxx2LFHN-M45	2	13.59	4.85	18.44
PPPCxx2LFHN-M46	3	16.13	2.30	18.43
PPPCxx2LFHN-M50	1	11.05	2.30	13.35
PPPCxx2LFHN-M51	1	11.05	12.20	23.25
PPPCxx2LFHN-M52	2	13.59	9.65	23.24
PPPCxx2LFHN-M53	3	16.13	7.10	23.23
PPPCxx2LFHN-M54	4	18.67	4.60	23.27

SULLINS
 801 E. MISSION RD.
 SAN MARCOS, CA 92069
 WWW.EDGECARDS.COM

GENERAL TOLERANCE		SCALE	NTS	DRAWN	DATE
XX, +-	XXX, +-	UNIT	mm	CHECK	DATE
X, +- 0.20	.XXX, +-	SIZE		APPROVE	
X, +- 0.10	X.8, +-				
.XX, +- 0.05	.X8, +-				

PARTS NO. **PPPCxx2LFHN-M****

xx designates number of dual positions, not total contacts.
 ** see chart above and insert appropriate number after "M"

DWG. NO. **T0028**