

A
REDRAWN

CUSTOMER COPY FOR REFERENCE ONLY

Surface 180 1308 ✓	Tolerances 180 486 180 1101	Material code SEE NOTE 1
		Finish SEE NOTE 2
Product number 71988-XXX SEE TABLE		
Title QUICKIE III FEMALE 0.4mm / 30 μ" Au -PRINTED-		
Drawing number 71988		Rev (tr) A
Date 91 10 26		Sheet 213 1 of 2
A/F 10/97 91 10 26 PVL L/ ECP # Date Dr. Supplied by 7 Supervisor Release # 6148 FORMAT A2		

PRODUCT NUMBER	SIZE	DIM. "A"	DIM. "B"	DIM. "C"	DIM. "S"	SLOT STYLE
71988-X04	2X2	9.54/.376	2.54/.1	9.46/.372	5.71/.225	NO SLOT
71988-X06	2X3	12.08/.476	5.08/.2	12.00/.472	8.25/.325	RIGHT SLOT
71988-X08	2X4	14.62/.576	7.62/.3	14.54/.572	10.79/.425	RIGHT SLOT
71988-X10	2X5	17.16/.676	10.16/.4	17.08/.672	13.33/.525	RIGHT SLOT
71988-X14	2X7	22.24/.876	15.24/.6	22.16/.872	18.41/.725	RIGHT SLOT
71988-X16	2X8	24.78/.976	17.78/.7	24.70/.972	20.95/.825	2 SLOTS
71988-X18	2X9	27.32/1.076	20.32/.8	27.24/1.072	23.49/.925	2 SLOTS
71988-X20	2X10	29.86/1.176	22.86/.9	29.78/1.172	26.03/1.025	2 SLOTS
71988-X26	2X13	37.48/1.476	30.48/1.2	37.40/1.472	33.65/1.325	2 SLOTS
71988-X30	2X15	42.56/1.676	35.56/1.4	42.48/1.672	38.73/1.525	2 SLOTS
71988-X34	2X17	47.64/1.876	40.64/1.6	47.56/1.872	43.81/1.725	2 SLOTS
71988-X40	2X20	55.26/2.176	48.26/1.9	55.18/2.172	51.43/2.025	2 SLOTS
71988-X44	2X22	60.34/2.376	53.34/2.1	60.26/2.372	56.51/2.225	2 SLOTS
71988-X50	2X25	67.96/2.676	60.96/2.4	67.88/2.672	64.13/2.525	2 SLOTS
71988-X60	2X30	80.66/3.176	73.66/2.9	80.58/3.172	76.83/3.025	2 SLOTS
71988-X64	2X32	85.74/3.376	78.74/3.1	85.66/3.372	81.91/3.225	2 SLOTS

AFTER TERMINATION SIDE VIEW OF ASSEMBLY (• LATCHING DIM ON HEADER)

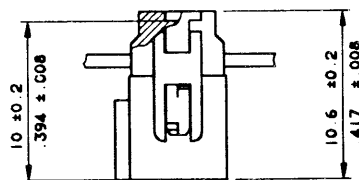

WITHOUT STRAIN RELIEF

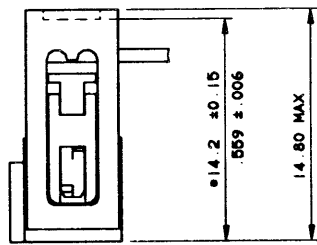

WITH LOW PROFILE STRAIN RELIEF

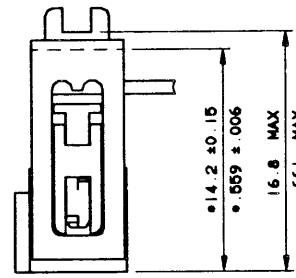

WITH STANDARD STRAIN RELIEF

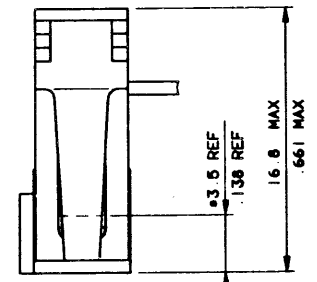

WITH LATCHING STRAIN RELIEF

71988-7YY		•				•	
71988-6YY	•					•	
71988-5YY		•			•		504-530
71988-4YY		•		•			304
71988-3YY		•	•				204-230
71988-2YY	•				•		
71988-1YY	•			•			004
71988-0YY	•		•				

PRODUCT CODE X	WITH CENTRAL KEY	WITHOUT CENTRAL KEY	STANDARD	WITHOUT	LOW PROFILE	LATCHING	DASHES NOT AVAILABLE

STRAIN RELIEF

CUSTOMER COPY FOR REFERENCE ONLY

Surface 180 1382 ✓	Tolerance 180 485 180 1101	Symbol mm inch Scale 1:1	Material code SEE TABLE
Product number 71988-XXX SEE TABLE			Finish SEE TABLE
Date 91 10 28 Name VALTHOEN P			Title QUICKIE III FEMALE 0.4 μm / 30 μ" Au -PRINTED-
Chg 91 10 28 G. HAYTHORN			
App'd 91 10 28 H. AS			
Drawing number 71988			Rev. Ltr. Sheet A 213 2 of 8
A/F 10/97 91 10 28 PVA L. ECP N		Date 91 10 28	Superseded Reference # 8148

▲
REDRAWN

