

RECOMMENDED CIRCUIT PATTERN
(COMPONENT SIDE)

- △ HOUSING MATERIAL: LIQUID CRYSTAL POLYMER
COLOR: NATURAL.
- △ CONTACT MATERIAL: PHOSPHOR BRONZE
- △ CONTACT FINISH:
UNDERPLATE (ENTIRE CONTACT):
0.00127 MIN NICKEL.
ON MATING SURFACES:
CONFORMS TO ALL TESTING SPECIFIED FOR TELCORDIA
UNCONTROLLED ENVIRONMENT.
ON LEADS
0.0006 MIN TIN-LEAD OVER UNDERPLATE.
LUBRICATION (ENTIRE CONTACT):
SURFACE CONDITIONER PER AMP SPEC 112-1002 AFTER PLATING.
- △ PART MARKING LOCATED APPROXIMATELY AS SHOWN.
- △ DIMENSION APPLIES WHEN SEATED ON PRINTED CIRCUIT BOARD.

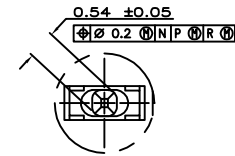

DETAIL Z
SCALE 20:1

130	65	131.88	△	330	1-223002-1
118	59	119.88	△	300	1-223002-0
106	53	107.88	△	270	223002-9
94	47	95.88	△	240	223002-8
82	41	83.88	△	210	223002-7
70	35	71.88	△	180	223002-6
58	29	59.88	△	150	223002-5
46	23	47.88	△	120	223002-4
34	17	35.88	△	90	223002-3
22	11	23.88	△	60	223002-2
10	5	11.88	△	30	223002-1

C	B	A	FINISH	NO OF SIGNAL POSN	PART NUMBER
---	---	---	--------	-------------------	-------------

THIS DRAWING IS A CONTROLLED DOCUMENT.

DATE: 12/14/98	BY: T. BLUMENFELDER	DATE: 11/14/98	BY: T. BLUMENFELDER
DATE: 11/14/98	BY: T. BLUMENFELDER	DATE: 11/14/98	BY: T. BLUMENFELDER
DATE: 11/14/98	BY: T. BLUMENFELDER	DATE: 11/14/98	BY: T. BLUMENFELDER
DATE: 11/14/98	BY: T. BLUMENFELDER	DATE: 11/14/98	BY: T. BLUMENFELDER

ASSEMBLY, PIN, SIGNAL, VERTICAL
 Z-PACK 2mm FB, 5 ROW, PRESS FIT LEADS

DATE: 01/07/99
 DRAWING NO: 223002

CUSTOMER DRAWING