

SPECIFICATIONS

Mechanical

Mating Force: 0.75N max.
Unmating Force: 0.15N min.
Durability: 250 Cycles

Electrical

Voltage Rating: 500V
Current Rating: 1A
Contact Resistance: 20mΩ max.
Insulation Resistance: 10000MΩ min.

Physical

Housing: PBT UL94V-0, Gray
Contact: Phosphor Bronze
Plating: See "ORDERING INFORMATION"

HARD METRIC CONNECTOR

2H Series
Rec Type B
2.0mm [.078"] Pitch
110 Pos. 22Column

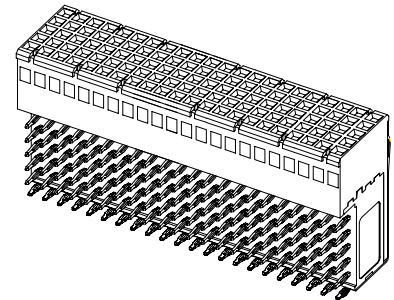

DRAWING

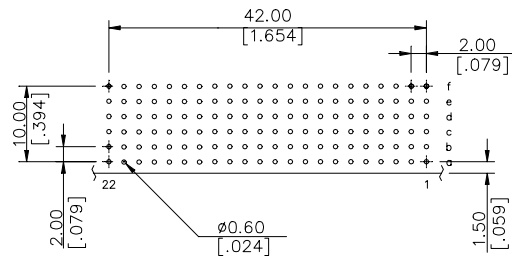
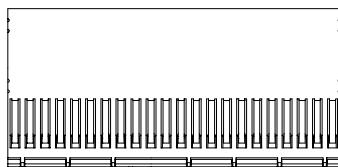

RECOMMENDED P.C.B. LAYOUT

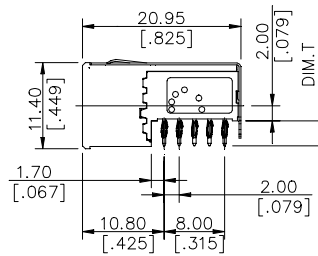
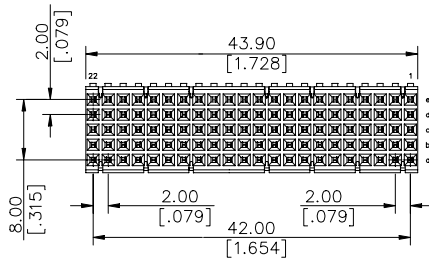

ORDERING INFORMATION

PRODUCT NO.: 2H2 * * * * -PB * * *

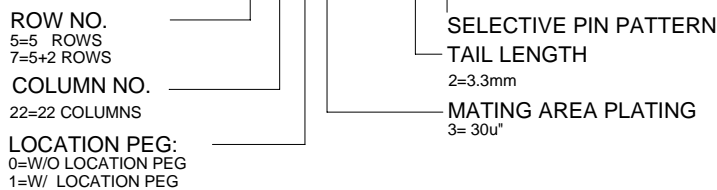

Products

News

Sales

Technical

Jobs

About Foxconn

Quick Search

 Search By

- Part Number
- Product Type
- Industry
- Alphabetical

 Part Number

- Enter Part Number

Starts With

Contains

Exact Match

 Search

Backplane Connector -> Hard Metric 2mm Conn

Hard Metric 2mm Conn 5 Row Receptacle: **2H252203-PB202**

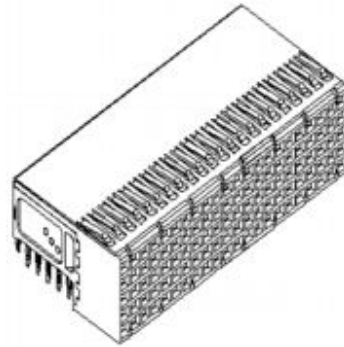

2H Series
Rec. Type B
2.0mm [0.78"] Pitch
110 Pos., 22 Column



Feature	Attribute
Number of Positions:	110
PCB Mount Style:	R/A
Plating:	32u"
Housing Material:	Thermoplastic
Color:	Grey
Number Row:	5
Solder Tail Type:	Press-Fit
Packaging Method:	Tube
Available Status:	Active
RoHS Status:	RoHS-5 compliant
Business Unit:	CID
Lead-Time (Week):	4
MOQ (pc):	700

Notice: Please confirm part availability with your local account manager.