

# .156" (3.96mm) Single Row, Through Hole, Right Angle Headers

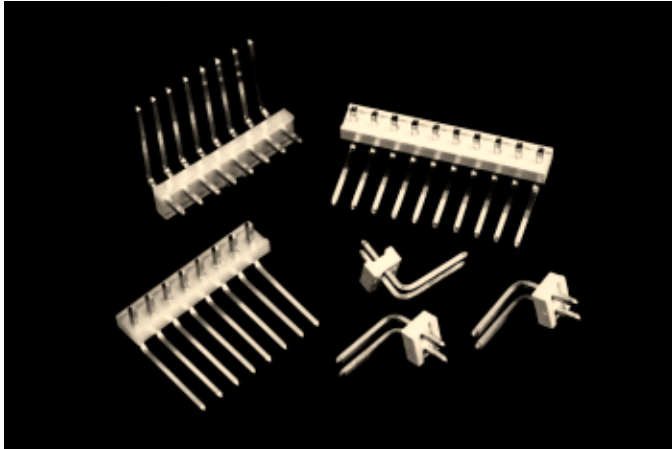

## 3100 SERIES ("TERMACON")

PART NUMBER LEGEND

**31XX-3-1XX-XX**

- PIN NUMBER, DIM "A" & "B" (SEE TABLE II)
- NUMBER OF POSITIONS (SEE TABLE I)
- PIN PLATING (SEE NOTE 2)
- INSULATOR MATERIAL (SEE NOTE 1)

**MATING CONNECTORS: 3000 SERIES AND 3300 SERIES CRIMP OR IDC STYLE CONNECTORS**

### NOTES:

- 1) INSULATOR MATERIAL:
  - 310X: NYLON 6/6, UL 94V-2
  - 316X: NYLON 6/6, UL 94V-0
  - PIN MATERIAL 70/30 BRASS
- 2) PIN FINISH:
  - 31X0- TIN OVER NICKEL PLATE
  - 31X2- .000015 GOLD PLATE OVER NICKEL PLATE
  - 31X7- .000030 GOLD PLATE OVER NICKEL PLATE

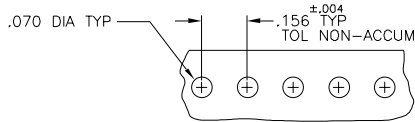
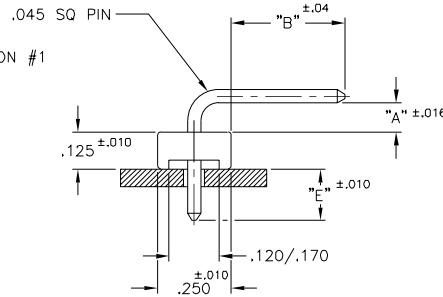
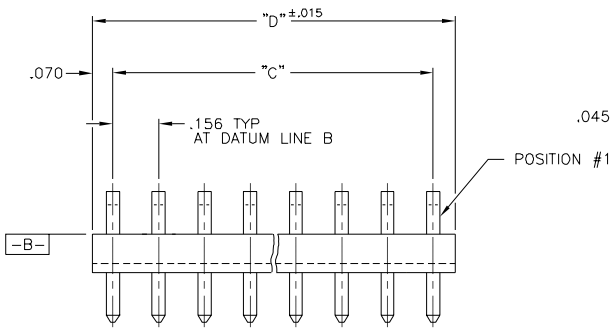

RECOMMENDED P.C. BOARD LAYOUT

TABLE I

PART No.	No. OF POSITIONS	DIM "C"	DIM "D"
31XX-3-102-XX	2	.156	.296
↑ -103- ↓	3	.312	.452
↑ -104- ↓	4	.468	.608
↑ -105- ↓	5	.624	.764
↑ -106- ↓	6	.780	.920
↑ -107- ↓	7	.936	1.076
↑ -108- ↓	8	1.092	1.232
↑ -109- ↓	9	1.248	1.388
↑ -110- ↓	10	1.404	1.544
↑ -111- ↓	11	1.560	1.700
↑ -112- ↓	12	1.716	1.856
↑ -113- ↓	13	1.872	2.012
↑ -114- ↓	14	2.028	2.168
↑ -115- ↓	15	2.184	2.324
↑ -116- ↓	16	2.340	2.480
↑ -117- ↓	17	2.496	2.636
↑ -118- ↓	18	2.652	2.792
↑ -119- ↓	19	2.808	2.948
↑ -120- ↓	20	2.964	3.104
↑ -121- ↓	21	3.120	3.260
↑ -122- ↓	22	3.276	3.416
↑ -123- ↓	23	3.432	3.572
↑ 31XX-3-124-XX ↓	24	3.588	3.728

TABLE II

PIN No.	DIM "A"	DIM "B"	DIM "E"
17	.172	.46	.171
18	.700	.49	.144
25	.172	.625	.162
38	.170	.180	.172
50	.090	.450	.169
52	.190	.360	.159
59	.105	.130	.300
63	.140	.739	.162
64	.172	1.00	.171
65	.172	.750	.171
68	.172	.360	.180
69	.110	.547	.547
70	.110 ±.010	.365 ±.015	.156
71	.250	.460	.156
73	.352	1.085	.156
74	.172	.850	.156
75	.078	.200 ±.020	.200
76	.078 ±.005	.510 ±.010	.175 ±.005
78	.295	.460	.171
79	.172	.350	.110
80	.700	.300	.144
81	.172	.450 ±.015	.125
82	.09	.700	.156
83	.090	.144	.144
84	.078	.390	.175
85	.172	.460	.112
86	.172	.490	.155