

## SPECIFICATIONS

### Mechanical

**Operating Force:** center push 250±150gf 500000 Cycles.  
 Lever tilt 100±50gf 500000 Cycles for each direction.  
**Travel:** center push 0.3±0.2mm  
 Lever tilt 7° max.

### Electrical

**Rating:** 10mA @5VDC (1mA min.)  
**Contact Resistance:** 500m max.  
**Insulation Resistance:** 100M min. @100VDC.  
**Dielectric Withstanding Voltage:** 1 Minute @100VAC.  
**Bounce:** 5ms max.  
**Contact Capacitance:** 20pF max.

### Physical

**Operating Temperatures:** -20 to +70 .  
**Storage Temperatures:** -40 TO +85 .

## Tact Switch

**1BT013 Series**  
**SMT Type**

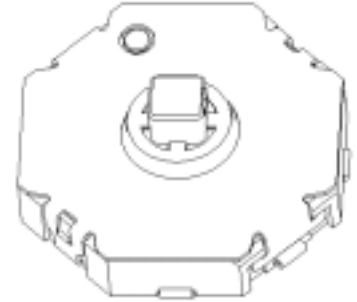

## DRAWING

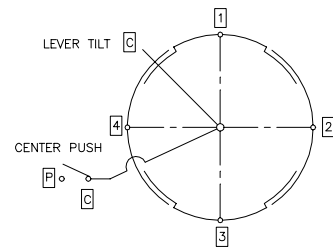
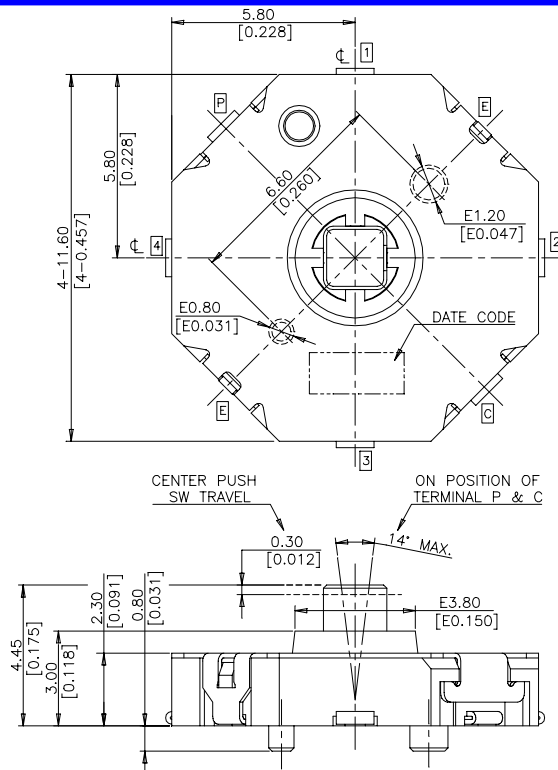

CIRCUIT DIAGRAM

□ SHOW TERMINAL NO.

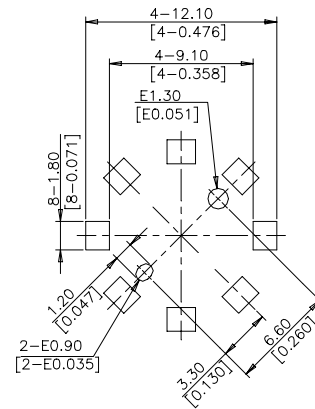

RECOMMENDED P.C.B LAYOUT

## ORDERING INFORMATION

PRODUCT NO.: 1B T 013 - 1 1 2 \* \* - \*\*\*

Switch Series	1B	T	013	-	1	1	2	*	*	-	***
Tact Type											
Product Series											
Prod. Size: 1=11.6mm*11.6mm											
Total height: 1 = 2.3mm											
Operating Force											
2 = Center push 250gf; Lever tilt 100gf											
Modification code											
None = standard type											
for Moto A1000											
Plating 0 = standard											
L = lead free											
Terminal 0 = L lead, SMT											
1 = J lead, SMT											