

FEATURES AND SPECIFICATIONS

Features and Benefits

- Sizes 6 to 15 circuits
- Bottom entry mount
- 0.64mm (.025") square pins
- Housing wall polarized to prevent misassembly
- Plating options available

Reference Information

Packaging: Bulk
 UL File No.: E29179
 Mates With: 5207 housings
 Designed In: Millimeters

Electrical

Voltage: 250V
 Current:

AWG	22	24	26	28
Amperes	3.0	2.5	2.0	1.5

Contact Resistance: 20mΩ max.
 Dielectric Withstanding Voltage: 1000V AC/1 min.
 Insulation Resistance: 1000 MΩ min.

Physical

Housing: 6/6 nylon, UL 94V-2
 Contact: Brass
 Plating: Tin
 Temperature: -40 to +105°C



2.50mm (.098") Pitch SPOX™ Wire-to-Board Header

5089-NA Feed-Through Polarized

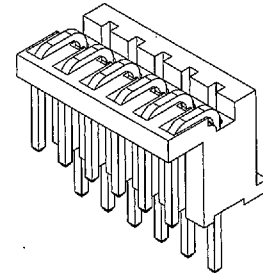

Available Primarily in the Far East

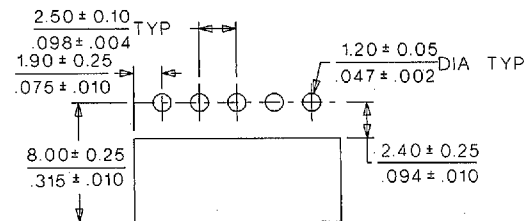
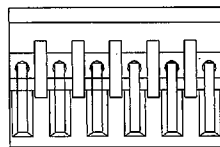

PCB LAYOUT: COMPONENT SIDE
 RECOMMENDED PCB THICKNESS: 1.60 ± 0.20
 .063 ± .008

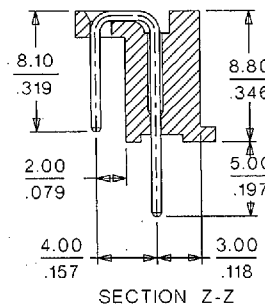
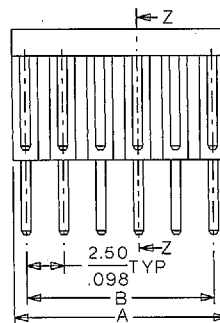

ORDERING INFORMATION AND DIMENSIONS

Circuits	Order No.	Dimension	
		A	B
6	22-21-1061	14.20 (.559)	12.50 (.492)
7	22-21-1071	16.70 (.657)	15.00 (.591)
8	22-21-1081	19.20 (.756)	17.50 (.689)
9	22-21-1091	21.70 (.854)	20.00 (.787)
10	22-21-1101	24.20 (.953)	22.50 (.886)
11	22-21-1111	26.70 (1.051)	25.00 (.984)
12	22-21-1121	29.20 (1.150)	27.50 (1.083)
13	22-21-1131	31.70 (1.248)	30.00 (1.181)
14	22-21-1141	34.20 (1.346)	32.50 (1.280)
15	22-21-1151	36.70 (1.445)	35.00 (1.378)