

BAS40T, BAS40-04T thru -06T

**SURFACE MOUNT
SCHOTTKY BARRIER DIODE**

**REVERSE VOLTAGE – 40 Volts
FORWARD CURRENT – 0.2 Ampere**

FEATURES

- Extremely Fast Switching Speed
- Low Forward Voltage
- Very Small Conduction Losses

MECHANICAL DATA

- Case: SOT-523 Plastic
- Case Material: “Green” molding compound, UL flammability classification 94V-0, (No Br. Sb. Cl)
- Moisture Sensitivity: Level 1 per J-STD-020D
- Lead Free in RoHS 2002/95/EC Compliant

SOT-523

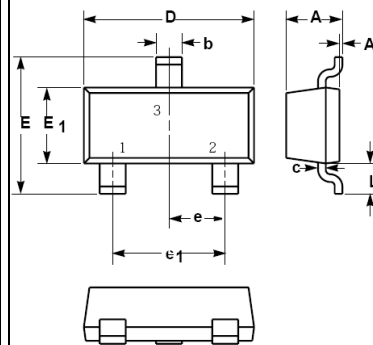

SOT-523		
Dim.	Min.	Max.
A	0.70	0.90
A1	0.00	0.10
b	0.25	0.325
c	0.10	0.20
D	1.50	1.70
E	1.45	1.75
E1	0.75	0.85
e	0.50 Typ.	
e1	0.90	1.10
L	0.55 Ref.	
Dimensions in millimeter		

Maximum Ratings & Thermal Characteristics @ T_A = 25°C unless otherwise specified

Characteristic	Symbol	BAS40T	BAS40-04T	BAS40-05T	BAS40-06T	Units
Repetitive Peak Reverse Voltage Working Peak Reverse Voltage DC Blocking Voltage	V _{RRM} V _{RWM} V _R	40				V
Forward Continuous Current	I _{FM}	200				mA
Forward Surge Current @t<1.0s	I _{FSM}	600				mA
Power Dissipation	P _D	150				mW
Thermal Resistance Junction to Ambient	R _{θJA}	833				°C/W
Operating Temperature Range	T _J	125				°C
Storage Temperature Range	T _{STG}	-65~+125				°C

Electrical Characteristics @ T_A = 25°C unless otherwise specified

Characteristic	Test Condition	Symbol	BAS40T	BAS40T-04T	BAS40T-05T	BAS40T-06T	Unit
Reverse Breakdown Voltage	I _R = 10uA	V _{BR}	40				V
Maximum Forward Voltage	I _F = 1mA I _F = 40mA	V _F	380 1000				mV
Maximum DC Reverse Current at Rated DC Blocking Voltage	V _R = 30V	I _R	200				nA
Typical Diode Capacitance	V _R = 1.0V, f=1MHz	C _D	5				pF
Reverse Recovery time	I _{rr} =1mA, I _R =I _F =10mA R _L =100Ω	t _{rr}	5				nS

RATING AND CHARACTERISTIC CURVES BAS40T, BAS40-04T thru -06T



FIG.1- TYPICAL FORWARD CHARACTERISTICS

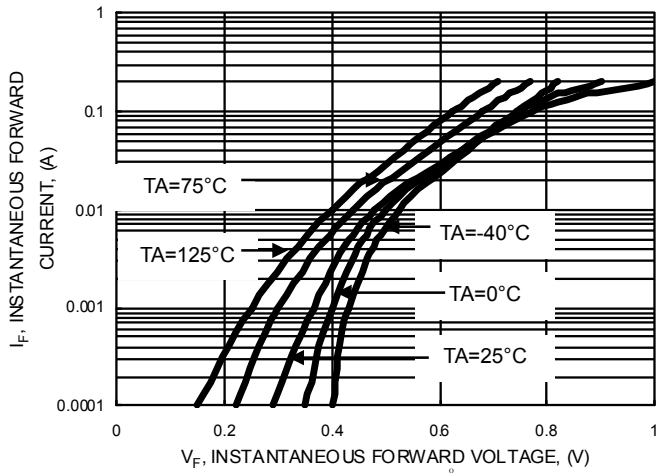

FIG.2- TYPICAL REVERSE CHARACTERISTICS

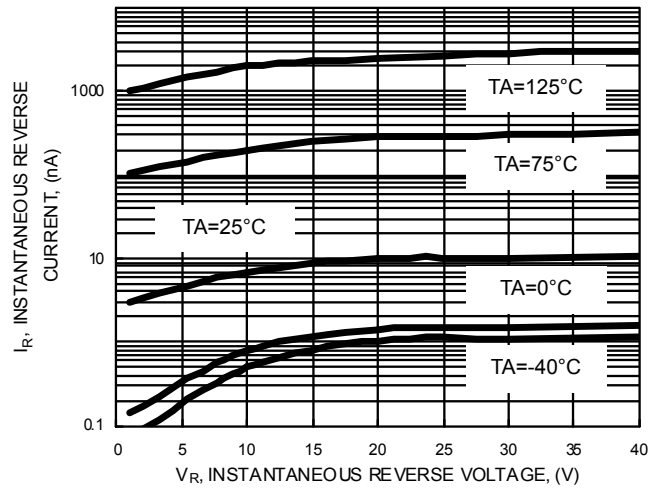

FIG.3- TYPICAL JUNCTION CAPACITANCE

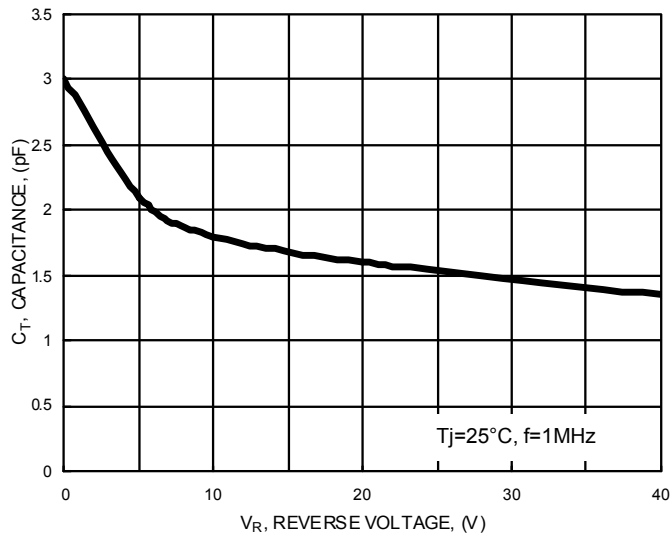
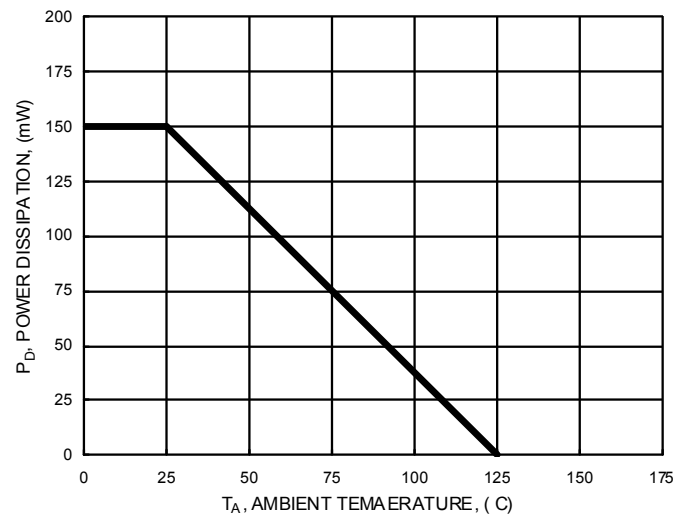

FIG.4- POWER DERATING CURVE



Device Marking :

Device P/N	Marking	Equivalent Circuit Diagram
BAS40T	43	
BAS40-04T	44	
BAS40-05T	45	
BAS40-06T	46	

Important Notice and Disclaimer

LSC reserves the right to make changes to this document and its products and specifications at any time without notice. Customers should obtain and confirm the latest product information and specifications before final design, purchase or use.

LSC makes no warranty, representation or guarantee regarding the suitability of its products for any particular purpose, nor does LSC assume any liability for application assistance or customer product design. LSC does not warrant or accept any liability with products which are purchased or used for any unintended or unauthorized application.

No license is granted by implication or otherwise under any intellectual property rights of LSC.

LSC products are not authorized for use as critical components in life support devices or systems without express written approval of LSC.