

REV.	ECN NO.	REVISIONS	DRN.	CKD.	APP.	DATE
A	—	NEW RELEASE	JAV			

OPERATING CHARACTERISTICS AT 25°C AMBIENT								
PART NUMBER	FORWARD VOLTAGE/CURRENT			REVERSE VOLTAGE (V)	PEAK WAVELENGTH (nm)	LUMINOUS INTENSITY (mcd)		TEST CONDITIONS
	MIN.	TYP.	MAX.		TYP.	MIN.	TYP.	
551-0203		2.1 V	3.0 V	$V_R = 3 \text{ V MIN. @ } 10 \mu\text{A}$	563	5.6	16.0	$I_F = 10 \text{ mA}$
551-0303		2.1 V	3.0 V	$V_R = 3 \text{ V MIN. @ } 10 \mu\text{A}$	585	2.2	6.3	$I_F = 10 \text{ mA}$
551-0403		2.0 V	3.0 V	$V_R = 3 \text{ V MIN. @ } 10 \mu\text{A}$	650	3.6	10	$I_F = 10 \text{ mA}$
551-0503		10 mA	20 mA	$V_R = 5 \text{ V MIN. @ } 100 \mu\text{A}$	635	8.7	29	$V_F = 5 \text{ V}$
551-0603		10 mA	20 mA	$V_R = 5 \text{ V MIN. @ } 100 \mu\text{A}$	565	5.6	19	$V_F = 5 \text{ V}$
551-0703		10 mA	20 mA	$V_R = 5 \text{ V MIN. @ } 100 \mu\text{A}$	585	3.7	12.6	$V_F = 5 \text{ V}$
551-1103		1.7 V	2.2 V	$V_R = 5 \text{ V MIN. @ } 50 \mu\text{A}$	635	1.0	1.6	$I_F = 2 \text{ mA}$
551-1203		1.8 V	2.7 V	$V_R = 5 \text{ V MIN. @ } 50 \mu\text{A}$	585	1.0	1.6	$I_F = 2 \text{ mA}$
551-1303		1.9 V	2.2 V	$V_R = 5 \text{ V MIN. @ } 50 \mu\text{A}$	565	1.0	1.6	$I_F = 2 \text{ mA}$
551-2503	1.5 V	2.2 V	3.0 V	$V_R = 5 \text{ V MIN. @ } 100 \mu\text{A}$	600	3.4	7.0	$I_F = 10 \text{ mA}$
551-3003				N/A	635/565	2.5/3.7	4.7/10	$I_F = 10 \text{ mA}$
		2.0/2.1	2.8/2.8					$I_F = 20 \text{ mA}$
551-3103				N/A	585/565	2.5/2.5	4.3/6.3	$I_F = 10 \text{ mA}$
		2.1/2.1	2.8/2.8					$I_F = 20 \text{ mA}$

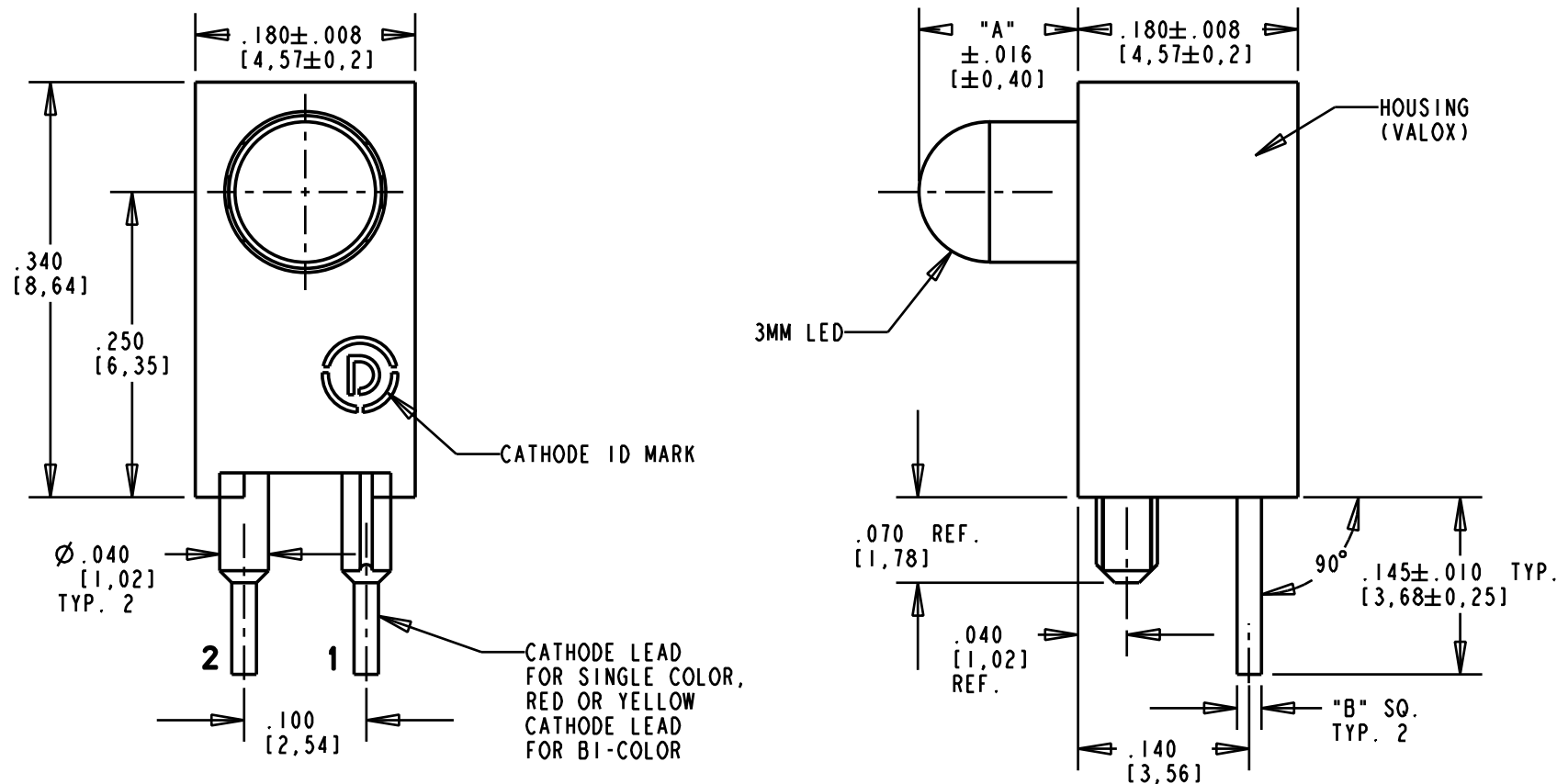

PART NUMBER	LED COLOR	"A" DIMENSION	"B" DIMENSION	"C" DIMENSION
551-0203	GREEN DIFFUSED	.140 [3,56]	.020 [0,51]	.043 [1,09]
551-0303	YELLOW DIFFUSED	.140 [3,56]	.020 [0,51]	.043 [1,09]
551-0403	RED DIFFUSED	.140 [3,56]	.020 [0,51]	.043 [1,09]
551-0503	RED W/RESISTOR 5V	.130 [3,30]	.018 [0,46]	.040 [1,02]
551-0603	GREEN W/RESISTOR 5V	.130 [3,30]	.018 [0,46]	.040 [1,02]
551-0703	YELLOW W/RESISTOR 5V	.130 [3,30]	.018 [0,46]	.040 [1,02]
551-1103	2 mA RED DIFFUSED	.130 [3,30]	.018 [0,46]	.040 [1,02]
551-1203	2 mA YELLOW DIFFUSED	.130 [3,30]	.018 [0,46]	.040 [1,02]
551-1303	2 mA GREEN DIFFUSED	.130 [3,30]	.018 [0,46]	.040 [1,02]
551-2503	ORANGE DIFFUSED	.130 [3,30]	.018 [0,46]	.040 [1,02]
551-3003	RED/GREEN BI-COLOR	.136 [3,45]	.020 [0,51]	.043 [1,09]
551-3103	YELLOW/GREEN BI-COLOR	.130 [3,30]	.020 [0,51]	.043 [1,09]

NOTES:

- LEADS TO FIT INTO HOLES SPACED AS PER HOLE PATTERN.
- LED LEAD DIMENSIONS SHOWN ARE MEASURED AT HOUSING EXIT.
- DIALIGHT PART NUMBER: 551-0203 THRU 551-3103

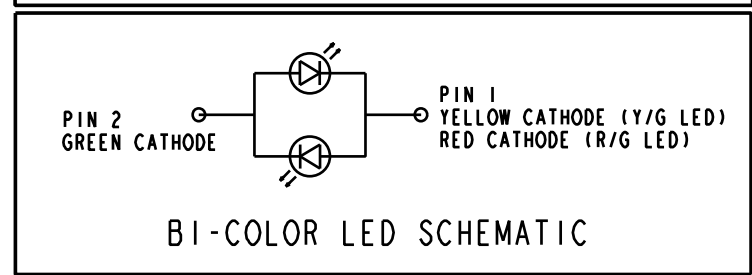
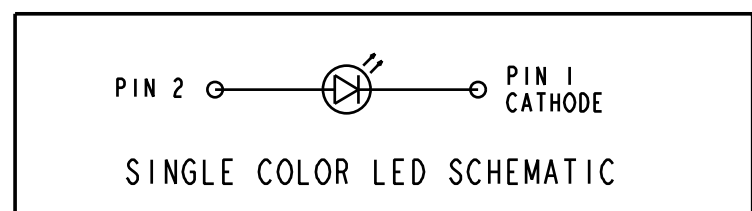
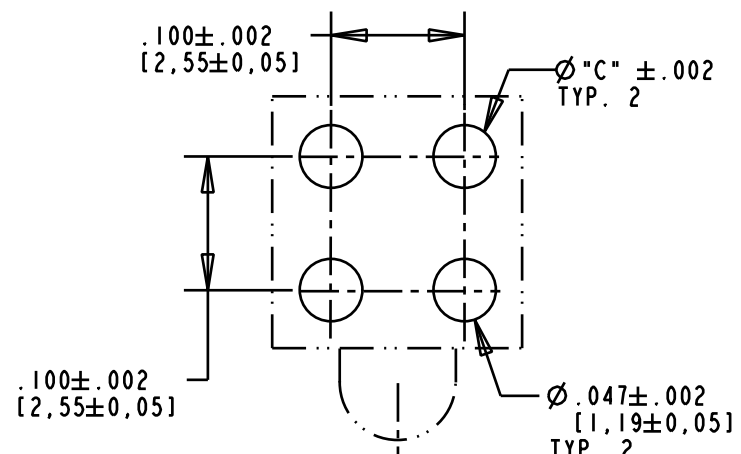

THIS DRAWING AND THE CONTENTS HEREIN ARE CONFIDENTIAL AND THE SOLE PROPERTY OF DIALIGHT. REPRODUCTION OF THIS DRAWING OR CONSTRUCTION OF ANY PARTS WITHIN THIS DRAWING ARE FORBIDDEN WITHOUT THE WRITTEN CONSENT OF DIALIGHT.

SCALE: 7.000	DRAWING NUMBER	REV
ALL DIM'S IN: INCHES (MM)	C-17117	A
TOLERANCES: UNLESS OTHERWISE SPECIFIED	TITLE	MATERIAL
FRACTIONS: ±1/64	3MM LED CBI, .250" HIGH LED	
DECIMALS (.XX): ±.020		
DECIMALS (.XXX): ±.015		
DECIMALS (.XXXX): ±.0005		
ANGLES: ±3°		
FINISH:		
FSCM 83330	Dialight	1501 ROUTE 34 SOUTH FARMINGDALE, NJ 07727
	SHEET 1 OF 1	FAMILY TABLE:

RECOMMENDED P.C. BOARD HOLE PATTERN