



6HG SERIES

10 to 20kV, 2.5 to 3A, Standard Recovery Rectifier Block with Mounting Slots



Features

- High Voltage, High Current Rectifier Block
- Epoxy Molded Encapsulation with Mounting Slots
- Threaded Brass Terminal Inserts

Specifications¹

Part Number	V_{RRM} V	V_F V	I_{FAVM} A	I_R μA	I_{FSM} A
6HG10	10000	10	3.00	5	400
6HG15	15000	15	2.75	5	400
6HG20	20000	20	2.50	5	400

Temperature °C	
Storage Temperature	-55 to 150
Maximum Junction Temperature	150

¹25°C ambient temperature unless stated otherwise.

Drawings

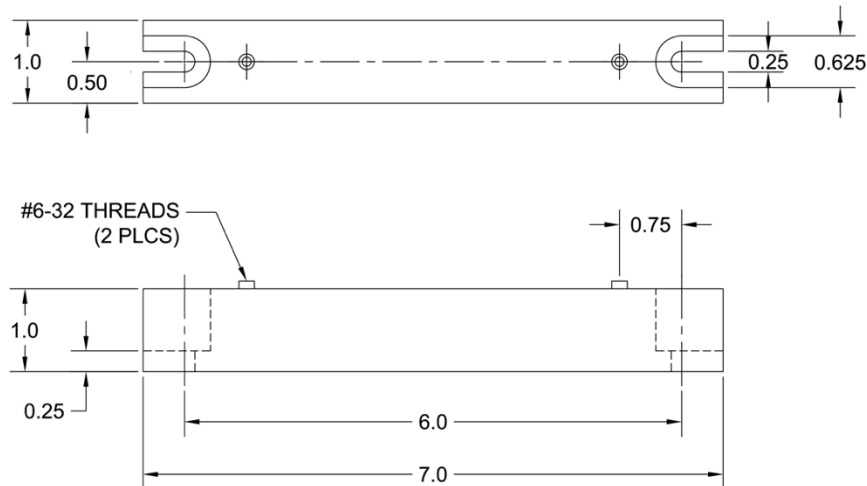

Dimensions in inches, tolerances ± 0.020 except as noted

Specification Definitions

Specifications	Conditions
V_{RRM} Maximum Repetitive Reverse Voltage	-
V_F Maximum Forward Voltage Drop	At I_{FAVM}
I_{FAVM} Maximum Average Forward Current	At $T_A = 55^\circ C$
I_R Maximum Leakage Current	At V_{RRM}
I_{FSM} Maximum Surge Current	At 8.3 mS, Single Half Sine



Note: Specifications subject to change without notice. Photo is representation only.