

**C1Z3.3B THRU C1Z91B**  
**SILICON ZENER DIODE**  
**3.3 VOLTS THRU 91 VOLTS**  
**1.0 W, 5% TOLERANCE**

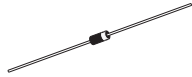

**DO-15 CASE**

# Central<sup>TM</sup>

**Semiconductor Corp.**

**DESCRIPTION:**

The CENTRAL SEMICONDUCTOR C1Z3.3B Series Silicon Zener Diode is a high quality epoxy molded voltage regulator designed for use in industrial, commercial, entertainment and computer applications.

**MARKING: FULL PART NUMBER**

**MAXIMUM RATINGS:**

Power Dissipation ( $T_A=50^\circ\text{C}$ )  
 Operating and Storage Temperature

**SYMBOL**

$P_D$  1.0  
 $T_J, T_{stg}$  -65 to +150

**UNITS**

W  
 $^\circ\text{C}$

**ELECTRICAL CHARACTERISTICS:** ( $T_A=25^\circ\text{C}$ )  $V_F=1.0\text{V MAX @ } I_F=500\text{mA}$  (for all types)

Type	Zener Voltage			Test Current	Maximum Reverse Leakage Current	
	$V_Z @ I_{ZT}$			$I_{ZT}$	$I_R @ V_R$	
	MIN V	NOM V	MAX V	mA	$\mu\text{A}$	V
C1Z3.3B	3.14	3.3	3.47	76	100	1.0
C1Z3.6B	3.42	3.6	3.78	69	100	1.0
C1Z3.9B	3.71	3.9	4.10	64	50	1.0
C1Z4.3B	4.09	4.3	4.52	58	10	1.0
C1Z4.7B	4.47	4.7	4.94	53	10	1.0
C1Z5.1B	4.85	5.1	5.36	49	10	1.0
C1Z5.6B	5.32	5.6	5.88	45	10	2.0
C1Z6.2B	5.89	6.2	6.51	41	10	3.0
C1Z6.8B	6.46	6.8	7.14	37	10	4.0
C1Z7.5B	7.13	7.5	7.88	34	10	5.0
C1Z8.2B	7.79	8.2	8.61	31	10	6.0
C1Z9.1B	8.65	9.1	9.56	28	10	7.0
C1Z10B	9.50	10	10.50	25	10	7.6
C1Z11B	10.45	11	11.55	23	5.0	8.4
C1Z12B	11.40	12	12.60	21	5.0	9.1
C1Z13B	12.35	13	13.65	19	5.0	9.9
C1Z14B	13.30	14	14.70	18	5.0	10.6
C1Z15B	14.25	15	15.75	17	5.0	11.4
C1Z16B	15.20	16	16.80	15.5	5.0	12.2
C1Z17B	16.15	17	17.85	14.8	5.0	12.9
C1Z18B	17.10	18	18.90	14	5.0	13.7
C1Z19B	18.05	19	19.95	13.3	5.0	14.4
C1Z20B	19.00	20	21.00	12.5	5.0	15.2
C1Z22B	20.90	22	23.10	11.5	5.0	16.7
C1Z24B	22.80	24	25.20	10.5	5.0	18.2
C1Z25B	23.75	25	26.25	10.2	5.0	19.0
C1Z27B	25.65	27	28.35	9.5	5.0	20.6

ELECTRICAL CHARACTERISTICS - Continued: ( $T_A=25^\circ\text{C}$ )  $V_F=1.0\text{V MAX @ } I_F=500\text{mA}$  (for all types)

Type	Zener Voltage			Test Current $I_{ZT}$	Maximum Reverse Leakage Current $I_R @ V_R$	
	$V_Z @ I_{ZT}$				$\mu\text{A}$	V
	MIN V	NOM V	MAX V	mA		
C1Z30B	28.50	30	31.50	8.5	5.0	22.8
C1Z33B	31.35	33	34.65	7.5	5.0	25.1
C1Z36B	34.20	36	37.80	7.0	5.0	27.4
C1Z39B	37.05	39	40.95	6.5	5.0	29.7
C1Z43B	40.85	43	45.15	6.0	5.0	32.7
C1Z47B	44.65	47	49.35	5.5	5.0	35.8
C1Z50B	47.50	50	52.50	5.1	5.0	37.3
C1Z51B	48.45	51	53.55	5.0	5.0	38.8
C1Z56B	53.20	56	58.80	4.5	5.0	42.6
C1Z62B	58.90	62	65.10	4.0	5.0	47.1
C1Z68B	64.60	68	71.40	3.7	5.0	51.7
C1Z75B	71.25	75	78.75	3.3	5.0	56
C1Z82B	77.90	82	86.10	3.0	5.0	62.2
C1Z91B	86.45	91	95.55	2.8	5.0	69.2

**DO-15 CASE - MECHANICAL OUTLINE**

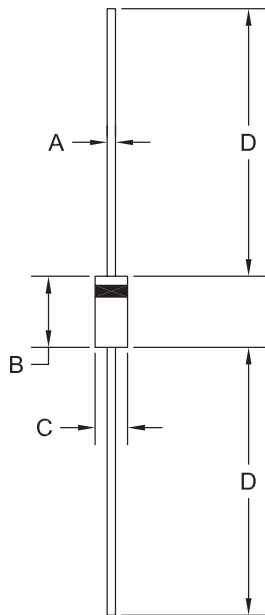

SYMBOL	DIMENSIONS			
	INCHES		MILLIMETERS	
	MIN	MAX	MIN	MAX
A	0.028	0.034	0.71	0.86
B	0.230	0.300	5.84	7.62
C	0.104	0.140	2.64	3.56
D	1.000	-	25.40	-

DO-15 (REV: R1)

R1

R0 (29-July 2009)