

.156" (3.96mm) Single Row Through Hole, Vertical Headers

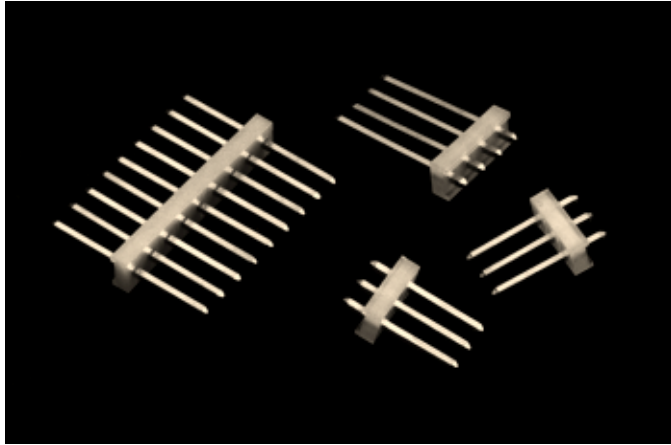

3100 SERIES ("TERMACON")

PART NUMBER LEGEND

31XX-1-XXX-XX

- PIN NUMBER, DIMS "A" & "B" (SEE TABLE II)
- NUMBER OF PINS (SEE TABLE I)
- PIN STYLE: "1" IS .045 SQ., "2" IS .045 RD.
- INSULATOR TYPE (STRAIGHT)
- PIN PLATING (SEE NOTE 3)
- INSULATOR MATERIAL (SEE NOTE 1)

MATING CONNECTORS: 3000 SERIES AND 3300 SERIES CRIMP OR IDC STYLE CONNECTORS

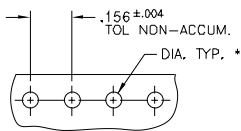
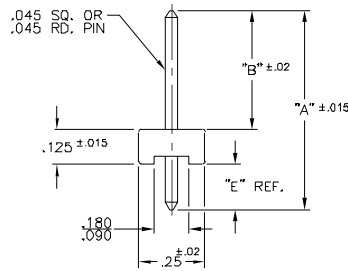
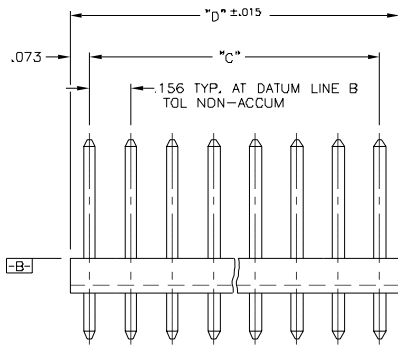

RECOMMENDED P.C. BOARD LAYOUT

- * .060 DIA. FOR .045 RD. PIN
- .070 DIA. FOR .045 SQ. PIN

NOTES:

- 1) INSULATOR MATERIAL: 31X0 - NYLON 6/6, UL 94V-2, COLOR: WHITE
31X - NYLON 6/6, UL 94V-0, COLOR: WHITE
- 2) PIN MATERIAL: BRASS, ALLOY 260.
- 3) PIN FINISH: 31X0 - BRITE TIN OVER NICKEL PLATE.
31X2 - .000015 GOLD OVER NICKEL PLATE.
31XZ - .000030 GOLD OVER NICKEL PLATE.

PART No.	No. OF POS.	DIM "C"	DIM "D"
31XX-1-X02-XX	2	.156	.302
-X03	3	.312	.458
-X04	4	.468	.614
-X05	5	.624	.770
-X06	6	.780	.926
-X07	7	.936	1.082
-X08	8	1.092	1.238
-X09	9	1.248	1.394
-X10	10	1.404	1.550
-X11	11	1.560	1.706
-X12	12	1.716	1.862
-X13	13	1.872	2.018
-X14	14	2.028	2.174
-X15	15	2.184	2.330
-X16	16	2.340	2.486
-X17	17	2.496	2.642
-X18	18	2.652	2.798
-X19	19	2.808	2.954
-X20	20	2.964	3.110
-X21	21	3.120	3.266
-X22	22	3.276	3.422
-X23	23	3.432	3.578
31XX-1-X24-XX	24	3.588	3.734

PIN No.	DIM "A"	DIM "B"	DIM "E"
-01	.750	.450	.175 REF.
-02	.750	.480	.145 REF.
-03	.812	.560	.127 REF.
-04	.937	.640	.172 REF.
-05	.937	.560	.252 REF.
-06	1.000	.690	.185 REF.
-07	1.187	.890	.172 REF.
-08	1.187	.940	.122 REF.
-09	1.187	.530	.532 REF.
-10	1.250	.450	.675 REF.
-11	1.375	1.080	.170 REF.
-12	1.375	.620	.630 REF.
-13	1.562	.760	.687 REF.
-14	1.562	1.280	.157 REF.
-15	1.562	.620	.817 REF.
-16	1.750	.720	.905 REF.
-19	1.290	1.180	—
-20	1.000	.445	.430 REF.
-21	.937	.625	.187 REF.
-22	.750	.437	.188 REF.
-23	1.812	.950	.737 REF.
-24	1.750	1.25	.375 REF.
-26	.937	.530	.282 REF.
-27	1.400	1.085	.190 REF.
-28	1.125	.825	.175 REF.
-29	1.290	1.055	.110 REF.
-30	1.031	.812	.094 REF.
-31	1.250	.940	.185 REF.
-32	.937	.600	.212 REF.
-33	1.250	1.000	.125 REF.
-34	.937	.375	.437 REF.
-36	1.670	.550	.995 REF.
-39	.812	.480	.207 REF.
-40	.750 REF.	.510	.115 ±.015
-41	1.200	.450	.625 REF.
-42	.812	.530	.157 REF.
-43	.660	.425	.110 REF.
-46	1.750	1.500	.125 REF.

PIN No.	DIM "A"	DIM "B"	DIM "E"
-47	1.560	1.310	.125 REF.
-48	1.031	.450	.456 REF.
-49	2.000	1.750	.125 REF.
-51	1.812	1.562	.125 REF.
-53	1.125	.450	.550 REF.
-54	.750	.390	.235 REF.
-56	1.125 REF.	.890	.115 ±.015
-57	1.400	.637	.638 REF.
-58	1.250	.715	.410 REF.
-60	1.312	1.012	.175 REF.
-67	1.000	.760	.115 REF.
-72	1.000	.720	.155 REF.
-77	1.437	1.137	.175 REF.
-79	1.670	1.370	.175 REF.
-80	1.150	.850	.175 REF.
-81	2.000	1.690	.185 REF.
-82	.625	.382	.118 REF.
-83	1.125	.875	.125 REF.
-84	.937	.690	.122 REF.
-85	.875 REF.	.625 ±.015	.125 ±.015
-86	.690	.450	.115 REF.
-87	.700 REF.	.450 ±.015	.125 ±.015
-88	1.125	.975	.026 REF.
-89	1.100	.590	.386 REF.
-90	1.031	.745	.161 REF.
-91	1.400	1.130	.145 REF.
-92	.700	.400	.175 REF.
-93	1.880	1.550	.205 REF.
-94	.812	.640	.047 REF.
-95	.750	.312	.312 REF.
-96	.812	.687	—
-97	1.800	1.565	.110 REF.
-98	1.000 REF.	.435	.440 ±.015
-99	.812 REF.	.605	.082 ±.015
-100	1.812	.950	.737 REF.
-101	.937	.675	.137 REF.