

CUSTOMER COPY

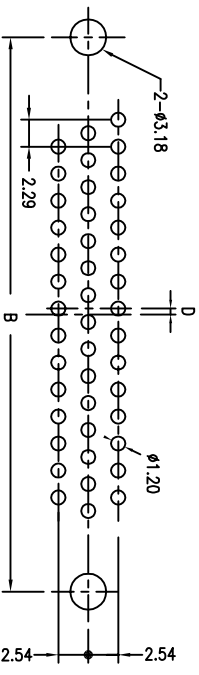

P.C.B LAYOUT

POS NO	A	B	C	D	E	F
14590XX15X	30.81	24.99	16.33	0.25	2.29	11.8
14590XX26X	39.14	33.32	24.66	0.51	2.29	11.8
14590XX44X	53.04	47.04	38.40	0.51	2.29	11.8
14590XX62X	69.32	63.52	54.80	0.58	2.41	11.8

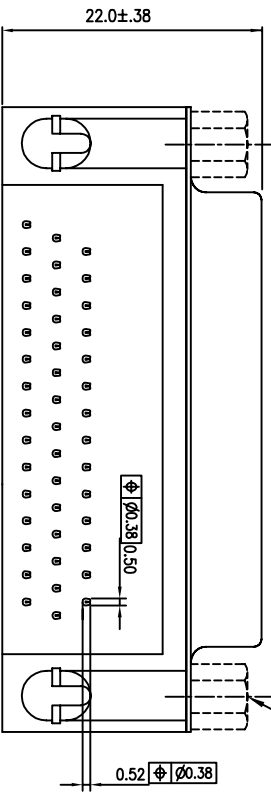
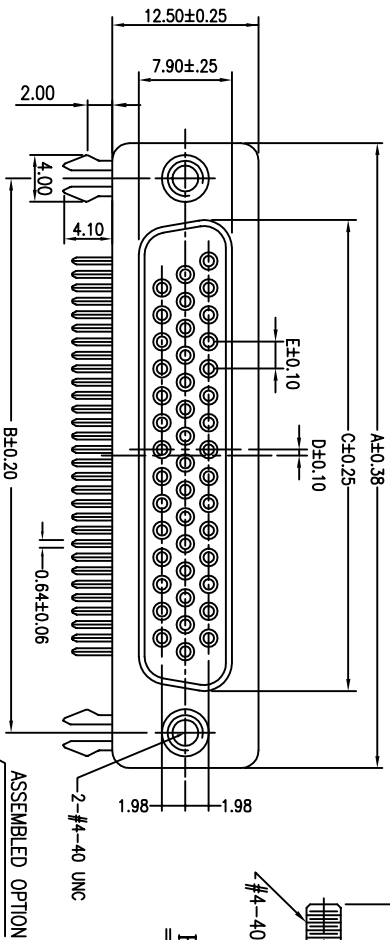
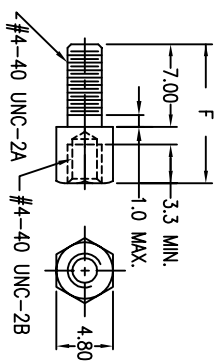

FEMALE SCREWLOCK

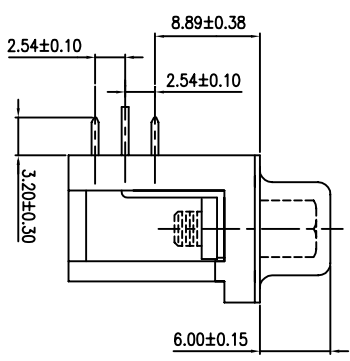

ASSEMBLED OPTION

ORDER INFORMATION
1459 0 X X X X X

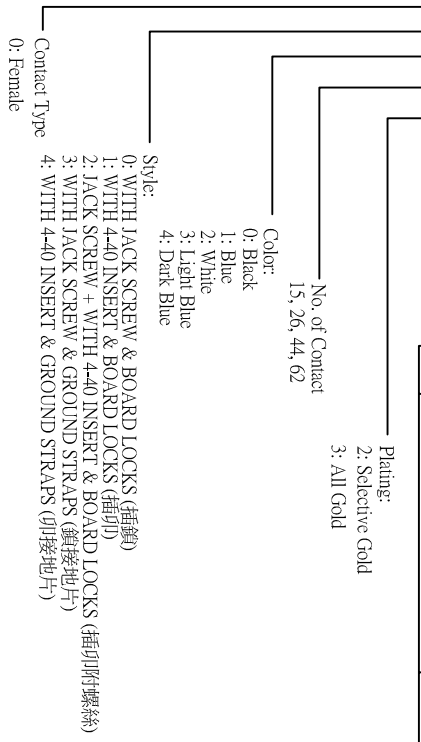

REV	ECN NO.	APP.	DATE
A	NEW DESIGN		

MATERIAL:

SHELL: Steel.
INSULATOR: PBT with 25% Glass Fiber, UL 94V-0,
CONTACT: Phosphor Bronze.
BOARDLOCKS: Brass.
THREADED INSERTS: Brass.

FINISH:

SHELL: Nickel plated.
CONTACT: Gold plated on contact area & 100 m" Min. Tin/lead plated on soldering end over 30 or 50 m" Nickel under-plating.
BOARDLOCKS: Tin/lead plated on soldering end over Nickel under-plating.
THREADED INSERTS: Nickel plated.

SPECIFICATION:

Current Rating: 2A Max.
Dielectric Strength: 1000V AC RMS for 1 minute.
Contact Resistance: 20 mΩ Max.
Insulator Resistance: 1000MΩ Min.
Temperature: -55°C to +105°C



ACMELUX CO., LTD.
TEL:886-2-85124595 FAX:886-2-85124322

0.01	0.30	SCALE:	
0.001	0.20	UNIT:	MM
0.000±0.10		TITLE:	D-SUB CONNECTOR H.D. Right Angle Type (FEMALE)
		MATL:	CHK BY:
		DWG. NO. C14590XXXXX	DR BY: JACK LIN