

Tous droits strictement reserves. Reproduction ou communication a des tiers interdite sous quelque forme que ce soit sans autorisation ecrite du proprietaire. Propriete de c FCI. Droits de reproduction FCI.

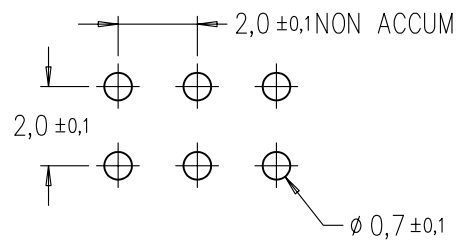

All rights strictly reserved. Reproduction or issue to third parties in any form whatever is not permitted without written authority from the proprietor. Property of FCI. Copyright FCI.

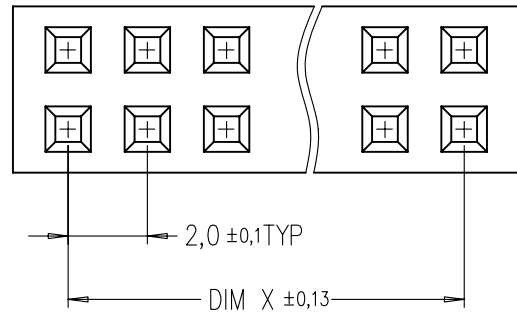

PC BOARD THK : 0,9 TO 1,3  
RECOMMENDED MOUNTING HOLE LAYOUT

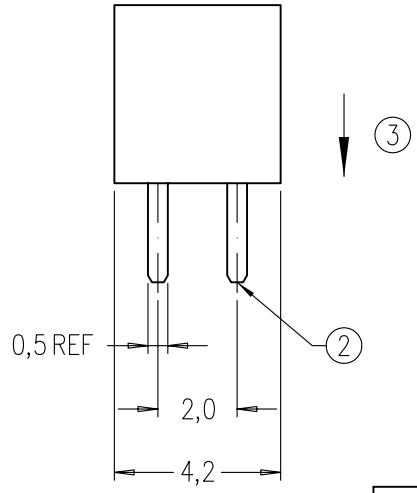
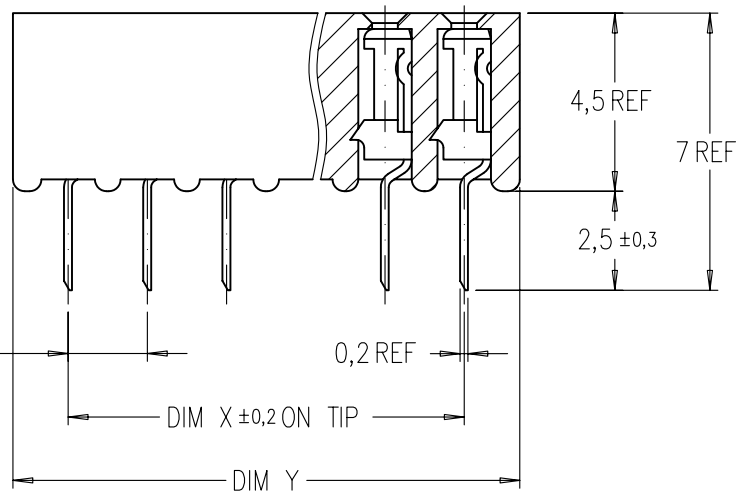

CONFIDENTIAL

mat'l. code				tolerances unless otherwise specified				CUSTOMER COPY		FCI www.fciconnect.com	
ltr	ecn no	dr	date	linear	±0.25			projection	title MINITEK II VCC (HTP)		
A	S0399	SET	1/16/90								
B	S10029	MLC	1/31/91								
				angles	MM			product family		code	
C	S00100	SCT	5/30/00					MINITEK		-	
D	S05-0064	KBM	3/1/05					size dwg no		-	
				dr	JANET	5/30/00	scale	A		sheet 1 of 2	
				engr	JPEH	6/1/00		87173			
				chr	KB MAH	3/1/05		10:1			
				appd	JOEY NG	3/1/05					
sheet index	revision sheet	D	D					cage code			
		1	2					22526			

ACAD

PDM: Rev:D

STATUS: Released

Printed Jul 20, 2005

Tous droits strictement reserves. Reproduction ou communication a des tiers interdite sous quelque forme que ce soit sans autorisation ecrite du proprietaire. Propriete de c FCI. Droits de reproduction FCI.



All rights strictly reserved. Reproduction or issue to third parties in any form whatever is not permitted without written authority from the proprietor. Property of FCI. Copyright FCI.

PRODUCT NO ⑤	POS	DIM X	DIM Y
87173-X02	2X1	- OBSOLETE -	
X04	2X2	2	4,8
X06	2X3	4	6,8
X08	2X4	6	8,8
X10	2X5	8	10,8
X12	2X6	10	12,8
X14	2X7	12	14,8
X16	2X8	14	16,8
X18	2X9	16	18,8
X20	2X10	18	20,8
X22	2X11	20	22,8
X24	2X12	22	24,8
X26	2X13	24	26,8
X28	2X14	26	28,8
X30	2X15	28	30,8
X32	2X16	30	32,8
X34	2X17	32	34,8
X36	2X18	34	36,8
X38	2X19	36	38,8
X40	2X20	38	40,8
X42	2X21	40	42,8
X44	2X22	42	44,8
X46	2X23	44	46,8
X48	2X24	46	48,8
X50	2X25	48	50,8

NOTES

- 1 MATERIAL  
BODY : GLASS FILLED PCT UL 94V-0 BEIGE  
TERMINAL : PHOSPHOR BRONZE
- ② CUT SURFACE IS UNPLATED
- ③ TERMINAL RETENTION FORCE 0,5 Kg MIN
- 4 TOLERANCE UNLESS OTHERWISE NOTED ±0,25
- ⑤ PRODUCT DESCRIPTION CODE :  
XXXXX-XXXLF  
  - LEAD FREE ⑥ ⑨
  - TOTAL POSITIONS
  - CONTACT AREA PLATING
  - BASE NUMBER
- ⑥ SOLDER TAIL PLATING:  
a) SOLDER TAIL OF 87173-XXX IS TIN/LEAD PLATED.  
a) SOLDER TAIL OF 87173-XXXLF IS 100% MATTE TIN PLATED.
- 7 THE HOUSING WILL WITHSTAND EXPOSURE TO 255° C PEAK TEMPERATURE FOR 10 SECONDS IN A CONVECTION, INFRA-RED OR VAPOR PHASE REFLOW OVEN.
- 8 THE HOUSING WILL WITHSTAND EXPOSURE TO 260° C PEAK TEMPERATURE FOR 10 SECONDS IN A WAVE SOLDER APPLICATION WITH A 1.57MM MINIMUM THICK CIRCUIT BOARD.
- ⑨ THIS PRODUCT MEETS EUROPEAN UNION DIRECTIVES AND OTHER COUNTRY REGULATIONS AS DESCRIBED IN GS-22-008.

CONTACT AREA PLATING	DESCRIPTION
0	0,2 um Au
1	0,76 um Au
2	UNASSIGNED
3	0,38 um Au
4	UNASSIGNED
5	UNASSIGNED
6	UNASSIGNED

CONFIDENTIAL

mat'l. code				tolerances unless otherwise specified			CUSTOMER COPY		www.fciconnect.com			
ltr	ecn no	dr	date	linear	±0.25			projection	title			
D									MINITEK II VCC (HTP)			
				angles				product family	MINITEK			
				dr					JANET	5/30/00	size	dwg no
				enrg				JPEH	6/1/00	A		87173
				chr				KB MAH	3/1/05		sheet	
				appd	JOEY NG	3/1/05	scale		1:1			
sheet index	revision sheet											

cage code 22526

PDM: Rev:D

STATUS Released

Printed Jul 20, 2005

ACAD