

.100" (2.54mm) Single Row, Through Hole Vertical, Polarizing, Locking Headers (Tall Back)

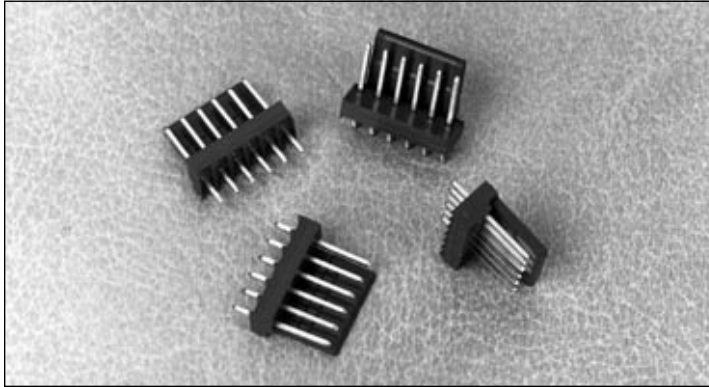

1100 SERIES "TERMACON"

PART NUMBER LEGEND

11XX-28-1XX-XX

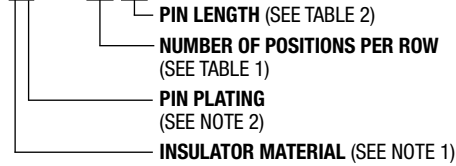

MATING CONNECTORS: 1300 SERIES CRIMP OR IDC STYLE CONNECTORS

NOTES :

- MATERIALS: INSULATOR : 110X - NYLON 6/6, UL94V-0, (PAM-011) COLOR: NATURAL (RED)
AVAILABLE ON 2 POS. THRU 8 POS. ONLY.
111X - POLYESTER (PCT) 30% CLASS-FILLED, UL94V-0, (PAM-003) COLOR : NATURAL
PIN : PHOSPHOR BRONZE
- PIN PLATING:
11X0 - BRITE TIN OVER NICKEL PLATE.
11X2 - .000015 GOLD OVER .000030 NICKEL PLATE.
11X8 - .000050 NICKEL PLATE ALL OVER;
.000015 SEL. GOLD PLATE AS INDICATED;
.0001-.0002 SEL. TIN/LEAD AS INDICATED.
11XF - .000050 NICKEL PLATE ALL OVER;
.000030 SEL. GOLD PLATE AS INDICATED;
.0001-.0002 SEL. TIN/LEAD AS INDICATED.
- ALL DIMENSIONS ARE IN IN./ (MM.).
- FOR CIRCUITS 2 THRU 6 LOCKING RAMP WILL BE SOLID.

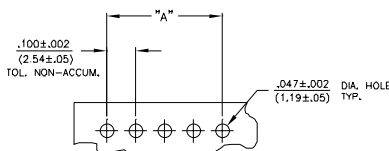
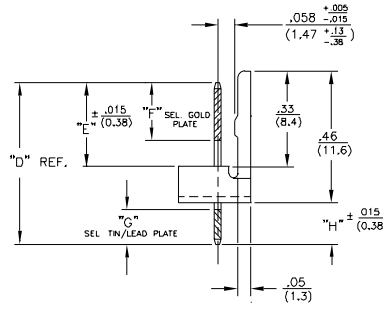
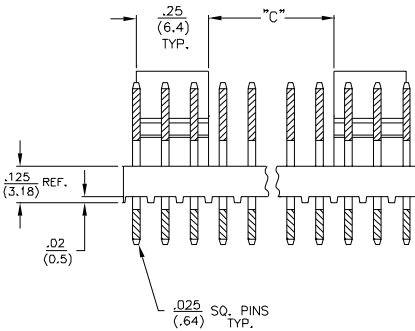
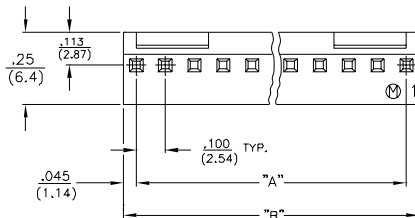

RECOMMENDED P.C. BOARD LAYOUT

PART NUMBER	No. OF POS.	"A" ±.010 (±.25)	"B" ±.010 (±.25)	"C" ±.010 (±.25)
11XX-28-102-XX	2	.190 (4.83)	.190 (4.83)	SEE NOTE 5.
↑ -103- ↑	3	.290 (7.37)	.290 (7.37)	↑
↑ -104- ↑	4	.390 (9.91)	.390 (9.91)	↑
↑ -105- ↑	5	.490 (12.45)	.490 (12.45)	↑
↑ -106- ↑	6	.590 (14.99)	.590 (14.99)	SEE NOTE 5.
↑ -107- ↑	7	.690 (17.53)	.690 (17.53)	.100 (2.54)
↑ -108- ↑	8	.790 (20.07)	.790 (20.07)	.200 (5.08)
↑ -109- ↑	9	.890 (22.61)	.890 (22.61)	.300 (7.62)
↑ -110- ↑	10	.990 (25.15)	.990 (25.15)	.400 (10.16)
↑ -111- ↑	11	1.090 (27.69)	1.090 (27.69)	.500 (12.70)
↑ -112- ↑	12	1.190 (30.23)	1.190 (30.23)	.600 (15.24)
↑ -113- ↑	13	1.290 (32.77)	1.290 (32.77)	.700 (17.78)
↑ -114- ↑	14	1.390 (35.31)	1.390 (35.31)	.800 (20.32)
↑ -115- ↑	15	1.490 (37.85)	1.490 (37.85)	.900 (22.86)
↑ -116- ↑	16	1.590 (40.39)	1.590 (40.39)	1.000 (25.40)
↑ -117- ↑	17	1.690 (42.93)	1.690 (42.93)	1.100 (27.94)
↑ -118- ↑	18	1.790 (45.47)	1.790 (45.47)	1.200 (30.48)
↑ -119- ↑	19	1.890 (48.01)	1.890 (48.01)	1.300 (33.02)
↑ -120- ↑	20	1.990 (50.55)	1.990 (50.55)	1.400 (35.56)
↑ -121- ↑	21	2.090 (53.09)	2.090 (53.09)	1.500 (38.10)
↑ -122- ↑	22	2.190 (55.63)	2.190 (55.63)	1.600 (40.64)
↑ -123- ↑	23	2.290 (58.17)	2.290 (58.17)	1.700 (43.18)
↑ -124- ↑	24	2.390 (60.71)	2.390 (60.71)	1.800 (45.72)
↑ -125- ↑	25	2.490 (63.25)	2.490 (63.25)	1.900 (48.26)
↑ -126- ↑	26	2.590 (65.79)	2.590 (65.79)	2.000 (50.80)
↑ -127- ↑	27	2.690 (68.33)	2.690 (68.33)	2.100 (53.34)
↑ -128- ↑	28	2.790 (70.87)	2.790 (70.87)	2.200 (55.88)

PART NUMBER	DIM. D REF.	DIM. E	DIM. F	DIM. G	DIM. H
11XX-28-1XX-01	.340 (8.63)	.28 (7.1)	.20 (5.1)	.12 (3.0)	.125 (3.18)
11XX-28-1XX-02	.340 (8.63)	.29 (7.4)	—	—	.125 (3.18)
11XX-28-1XX-03	.340 (8.63)	.23 (5.8)	—	—	.125 (3.18)
11XX-28-1XX-04	.340 (8.63)	.29 (7.4)	—	—	.125 (3.18)
11XX-28-1XX-05	.340 (8.63)	.30 (7.6)	—	—	.125 (3.18)
11XX-28-1XX-06	.340 (8.63)	.29 (7.4)	—	—	.125 (3.18)
11XX-28-1XX-07	1.100 (27.94)	.29 (7.4)	—	—	.125 (3.18)
11XX-28-1XX-08	.825 (20.95)	.29 (7.4)	.20 (5.1)	.12 (3.0)	.125 (3.18)



North and South America:
Methode Electronics, Inc. Connector Products
 1700 Hicks Road • Rolling Meadows, IL 60008 USA
 847-392-3500 • Toll Free: 800-323-6864 • Fax: 847-392-9404
 Email: info@methode.com • Web: www.methode.com/connector/index.html

Europe:
Methode Electronics Ireland, Ltd.
 Unit H, Crossagalla Business Park, Ballysimon Rd. • Limerick, Ireland
 +353 (0) 61 401222 • Fax: +353 (0) 61 401942
 Email: info@methode.ie • Web: ireland.methode.com/main.html

Far East:
Methode Electronics Far East, Pte. Ltd.
 1 Tuas Lane, Jurong Town • Singapore 638610
 65-68615444 • Fax: 65-68614777
 Email: sales@methode.com.sg • Web: www.methode.com/mefe/index.html