

**Flat Cable  
Commercial  
D-Subminiature**

**.109" (2.77mm)  
Mass Terminated IDC  
For .050" Flat Cable**

**CINCH**

**Features**

- Back cover fastens to shell with metal latches instead of plastic, for higher reliability especially at elevated temperatures
- .050" (1.27mm) conductor pitch compatible termination
- Metal shells with conductive tin or zinc with yellow chromate plating
- Contact positions: 9, 15, 25, and 37
- Minimum "front-to-back" depth: with cover—.605" (15.36mm)/with cover and strain relief—.720" (18.28mm)
- Intermateable with all D-Subminiature connectors of comparable pin count and complying dimensionally with MIL-C-24308

**Performance Data**

**Materials**

**Insulation Material:** UL 94V-0 rated, glass-filled polyester, gray

**Shell Material:** Steel; plated with conductive tin with indents on plugs or yellow chromate without indents

**Contact Material:** Beryllium copper

**Contact Plating:** Gold flash over nickel in contact area

**Electrical Characteristics**

**Withstanding Voltage:** 500 VAC rms (@ sea level)

**Current Rating:** 1 Amp

**Contact Resistance:** 15 Milliohms maximum

**Insulation Resistance:** 1000 Megohms

**Wire Accommodation:** 28 AWG stranded and 30 AWG solid

**Environmental Characteristics**

**Shock:** Per EIA RS 364-27, Condition H

**Operating Temperature:** -55°C to +85°C limited by PVC insulation on ribbon cable

**Vibration:** Per EIA RS 364-28, Condition I

**Humidity:** Per EIA RS 364-31, Condition A, Method II

**Tools**

For termination tooling, see pages 46 through 49.

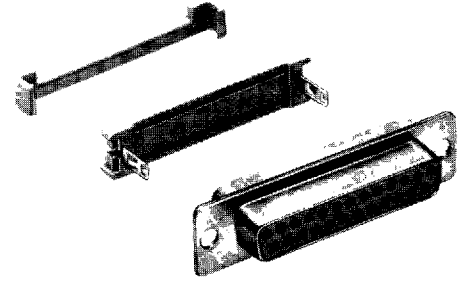

**Ordering Information**

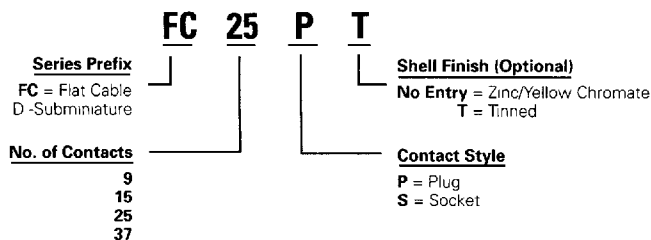

**Flat Cable  
Commercial  
D-Subminiature**

**.109" (2.77mm)  
Mass Terminated IDC  
For .050" Flat Cable**

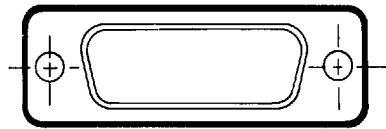
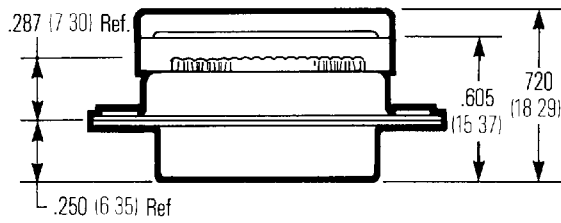
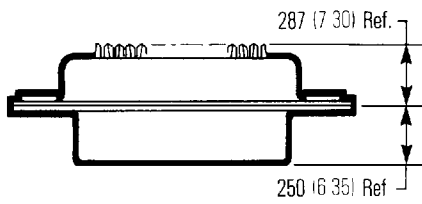
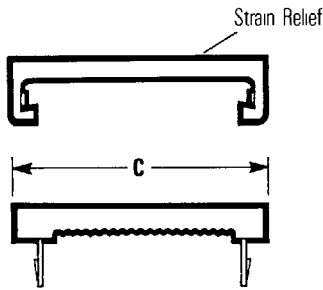
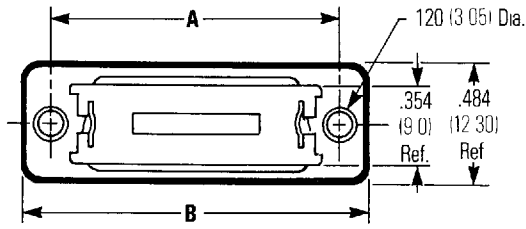

For standard panel cutouts see page 6

**Dimensions**

No. of Contacts	A		B		C	
	in	mm	in	mm	in	mm
9	.984	24.99	1.203	30.56	.799	20.30
15	1.312	33.32	1.531	38.89	1.126	28.60
25	1.852	47.04	2.078	52.78	1.669	42.40
37	2.500	63.50	2.719	69.06	2.315	58.80