

SPECIFICATIONS

Current Rating: 9A AC,DC
 Voltage Rating: 600V AC,DC
 Temperature Range: -25°C ~ +85°C
 Contact Resistance: 10mΩ Max
 Insulation Resistance: 1000MΩ Min
 Withstanding Voltage: 1500V AC/minute
 Pin Material: Brass/Tin-plated
 Material: Nylon 66,UL94V-2
 Color: Natural(Translucent)

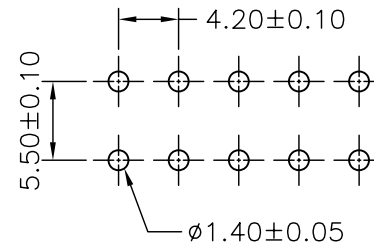

P.C.B LAYOUT

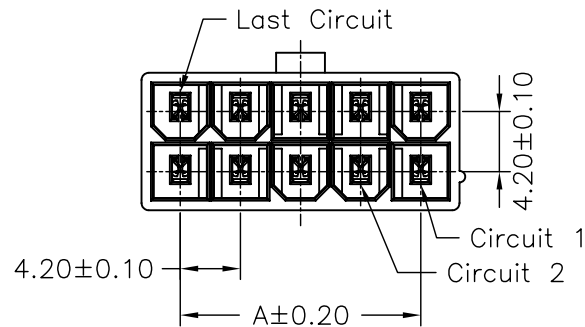
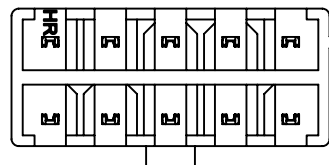
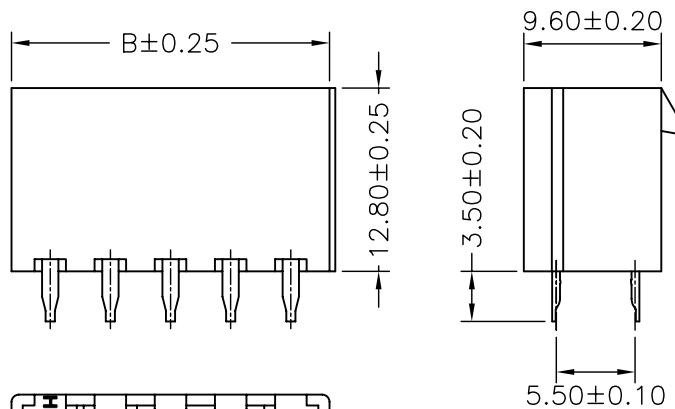

Ordering Information & Dimensions

PART NO.	Dimensions	
	A	B
C4255WVA-2X01P	---	5.40
C4255WVA-2X02P	4.20	9.60
C4255WVA-2X03P	8.40	13.80
C4255WVA-2X04P	12.60	18.00
C4255WVA-2X05P	16.80	22.20
C4255WVA-2X06P	21.00	26.40
C4255WVA-2X07P	25.20	30.60
C4255WVA-2X08P	29.40	34.80
C4255WVA-2X09P	33.60	39.00
C4255WVA-2X10P	37.80	43.20
C4255WVA-2X11P	42.00	47.40
C4255WVA-2X12P	46.20	51.60

			UNIT	SCALE	SHEET	TITLE:	
			mm		1 of 1		
			DRAWN BY	APPROVED BY		<p style="text-align: center;">4.20mm PITCH 180° WAFER, MINI-FIT</p>	
			董正一	董正一			
			2001.02.01	2001.02.01			
			GENERAL TOLERANCE				
			X. X±0.25	ANGLE±		DRAW NO. : C4255WVA-2XNP	
B0			X. XX±0.15				REV. B0
REV.			X. XXX±0.05				
NEW RELEASE			2006.06.07				
DESCRIPTION			DATE				