

CFS01 1.27mm FEMALE HEADER, SMT TYPE

Pitch: 1.27mm x 1.27mm

Profile: 2.2mm , 3.6mm , 4.5mm

SPECIFICATION

Current Rating: 1.5 Amp
 Insulation Resistance: 2000 Megohms min
 Contact Resistance: 20 m ohms Max
 Dielectric Withstanding: AC 500 V
 Operating Temperature: -40 ° C to +105° C
 Max Processing Temp: 260 ° C for 6 seconds
 Contact Material: Phosphor Bronze
 Insulator Material: Polyester, UL 94V-0
 © Standard : LCP

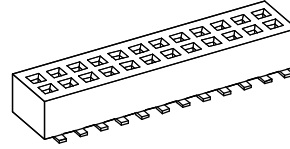

RoHS compliant

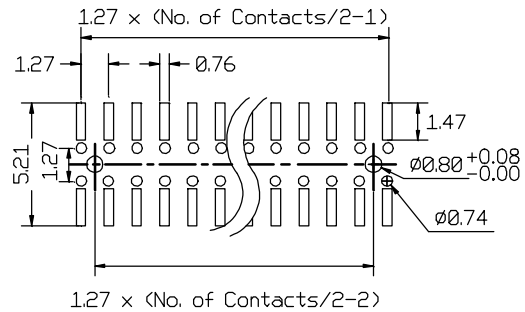
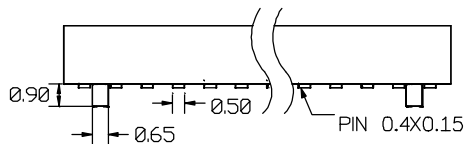
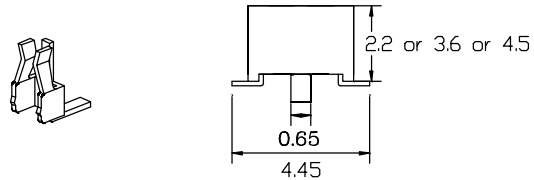
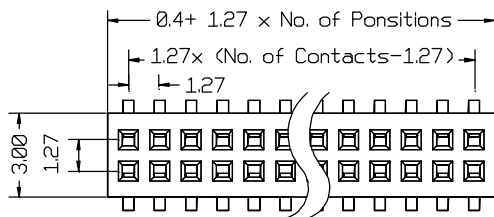

1.27 x (No. of Contacts/2-2)

Recommended P.C.Board
SMD Layout

HOW TO ORDER

CFS01 - [X] - [X] - [X] - [X]

NO. OF CONTACT
06 TO 100

SPECIAL FUNCTION
A: Profile 2.2mm
B: Profile 3.6mm
C: Profile 4.5mm

CONTACT PLATING
A : Gold Flash
B : 10u" Gold
C : 15u" Gold
D : 30u" Gold
© Standard: A

CODE PACKING
A: Tube
B: Pad + Tube
G: Pad + Reel