

**SPECIFICATIONS**

Current Rating: 3A AC,DC  
 Voltage Rating: 250V AC,DC  
 Temperature Range: -25°C ~ +85°C  
 Contact Resistance: 10mΩ Max  
 Insulation Resistance: 1000MΩ Min  
 Withstanding Voltage: 800V AC/minute  
 Pin Material: Brass/Tin-plated  
 Material: Nylon 66,UL94V-0  
 Color: Natural(White)

**Ordering Information & Dimensions**

PART NO.	Dimensions	
	A	B
A2502WV-02P2	2.50	7.50
A2502WV-03P2	5.00	10.00
A2502WV-04P2	7.50	12.50
A2502WV-05P2	10.00	15.00
A2502WV-06P2	12.50	17.50
A2502WV-07P2	15.00	20.00
A2502WV-08P2	17.50	22.50
A2502WV-09P2	20.00	25.00
A2502WV-10P2	22.50	27.50
A2502WV-11P2	25.00	30.00
A2502WV-12P2	27.50	32.50
A2502WV-13P2	30.00	35.00
A2502WV-14P2	32.50	37.50
A2502WV-15P2	35.00	40.00

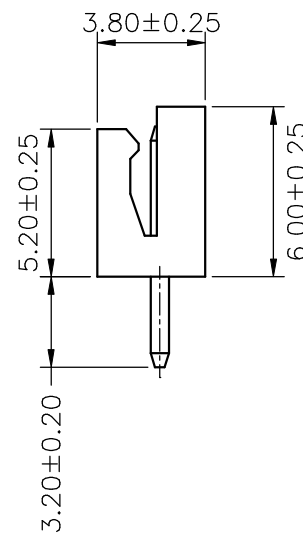
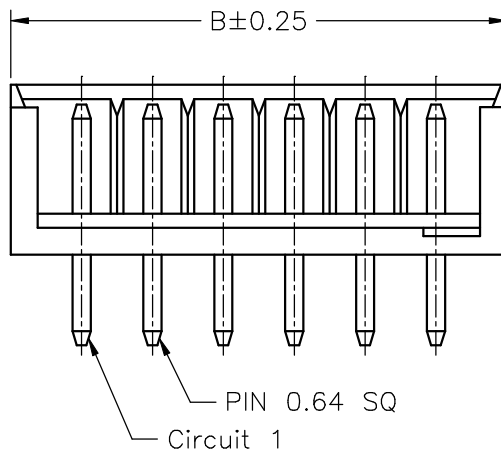
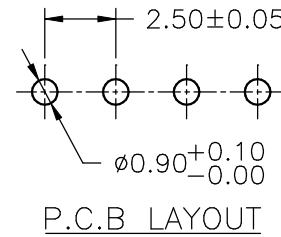
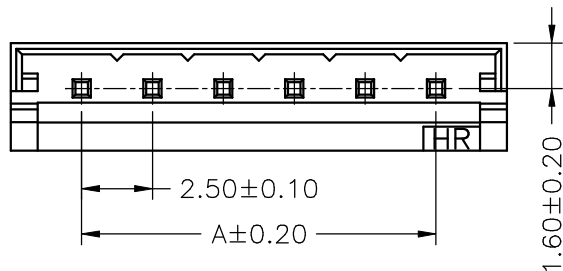

			UNIT	SCALE	SHEET	TITLE:
			mm		1 of 1	<b>2.50mm PITCH 180° WAFER</b>
			DRAWN BY	APPROVED BY		
			李勤	董正一		
			2006.06.02	2006.06.02		
			GENERAL TOLERANCE			
			X. X±0.25	ANGLE±		DRAW NO. : A2502WV-XP2
A0	NEW RELEASE	2006.06.02	X. XX±0.15			
REV.	DESCRIPTION	DATE	X. XXX±0.05			