

**PIN HEADER 2,54mm 1,5mm insulator**

**ID: 338**

STL 1-XXXXG-15 / STL 2-XXXXG-15

Series 400

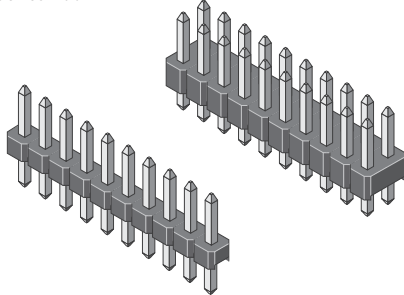

**TECHNICAL DATA**

Pitch	2,54 mm
Insulating Material	high temp. thermoplast UL94V-0
Contact Material	copper alloy
Rated Current	3 Amp.
Rated Voltage	250 V <sub>AC/DC</sub>
Withstanding Voltage	1000 V <sub>AC</sub> for one minute
Operating Temperature	-40°C to +105°C
Maximum Soldering Temperature	260°C for 10 seconds

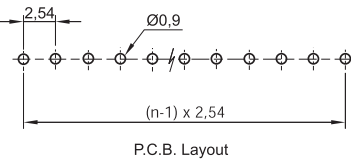
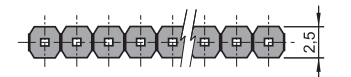
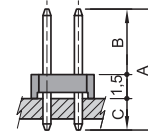
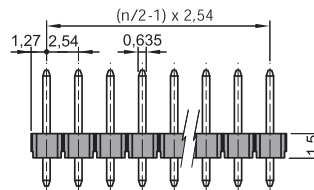
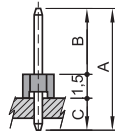
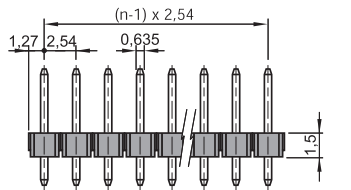

P.C.B. Layout

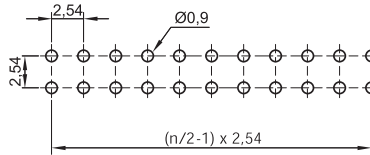

P.C.B. Layout

Code	A	B	C
1000	10,00	6,00	2,50
1060	10,60	6,60	2,50
1110	11,10	6,30	3,30
1380	13,80	9,00	3,30
1430	14,30	9,50	3,30
1460	14,60	9,80	3,30
1680	16,80	12,00	3,30
1960	19,60	14,80	3,30
2140	21,40	16,60	3,30
2260	22,60	17,80	3,30
2470	24,70	19,90	3,30
Custom			

All dimensions in mm.  
Other dimensions upon request.

**STL X - XXXX G XX - 15 - XX U**

Rows: 1 = 1 row  
2 = 2 rows

Code: see table

G: straight contacts

Plating: TT = Sn  
GT = Sel. Au  
GG = Au

U: RoHS-compliant with high temp. plastic

Pins: 1 row: 1 - 40 poles possible  
2 rows: 2 - 80 poles possible

15: Insulator height 1,5mm