

# LP Series 2.5mm Pitch



## ■ Features

1. Only 10mm height and 5.9mm width when mated.
2. Two types of plugs are available (straight or right-angle) and ranging from 2P to 15P.
3. A locking structure is utilized for the socket and plug housing to ensure connection and prevent improper plug insertion.

## ■ Specification

1. Rating : 3A, 50V AC/DC
2. Contact Resistance : 20mΩ max., initially
3. Insulation Resistance : 1000MΩ min. at 500V DC
4. Withstanding Voltage : 1000V AC (for one minute)
5. Operating Temperature Range : -25°C to +85°C

## ■ 特 長

1. ソケットとプラグの結合高さ10.0mm、厚さ5.9mmの小型タイプです。
2. 極数は2～15P、プラグはストレートタイプとライトアングルタイプがあります。
3. ソケットとプラグはロック機構付きで、確実なロックと誤挿入を防止します。

## ■ 仕 様

1. 定格電圧電流 : AC/DC 50V 3A
2. 接 触 抵 抗 : 初期20mΩ以下
3. 絶 縁 抵 抗 : DC 500V 1000MΩ 以上
4. 耐 電 圧 : AC 1000V (1分間)
5. 使用温度範囲 : -25°C～+85°C

## ■ Mating Diagram

嵌合図

Straight Type

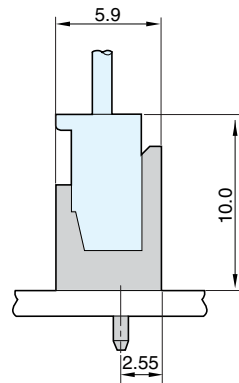

Right-Angle Type

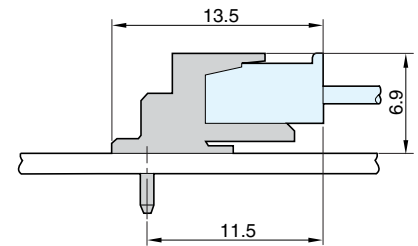

## ■ P.C. Board Dimension ( t = 1.6 )

取付基板参考図

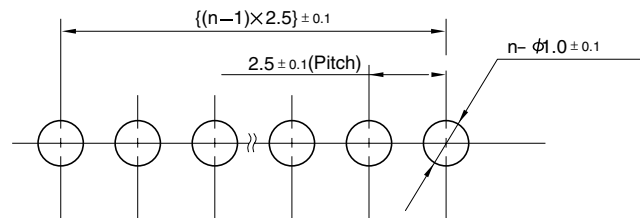

## ■ Structural Configuration Diagram

構造図

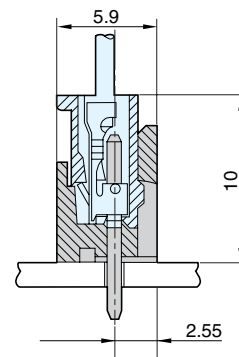

● Socket  
● Terminal

Part No. 図番	Applicable Electrical Wire Size 適合電線範囲 (AWG)	Electrical Wire Sheath Dia. 電線被覆外径 (mm)	Material 材質	Plating 表面処理	No. of Terminal/ Reel 個数/ リール
W-T0873-11#01F	22~30	φ 1.7~0.8	Cu Alloy 銅合金	Sn (Reflow Treatment) すずめっき (リフロー処理)	15,000

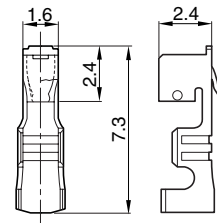

● Housing

□□ No. of Pins	Part No.	A	B
2	W-A3202-2B#01	2.5	5.0
3	W-A3203-2B#01	5.0	7.5
4	W-A3204-2B#01	7.5	10.0
5	W-A3205-2B#01	10.0	12.5
6	W-A3206-2B#01	12.5	15.0
7	W-A3207-2B#01	15.0	17.5
8	W-A3208-2B#01	17.5	20.0
9	W-A3209-2B#01	20.0	22.5
10	W-A3210-2B#01	22.5	25.0
11	W-A3211-2B#01	25.0	27.5
12	W-A3212-2B#01	27.5	30.0
13	W-A3213-2B#01	30.0	32.5
14	W-A3214-2B#01	32.5	35.0
15	W-A3215-2B#01	35.0	37.5

W-A 32□□-2B#01

↑ No. of Pins

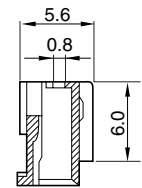
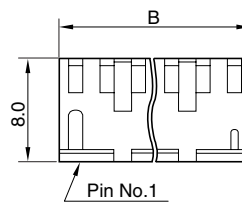
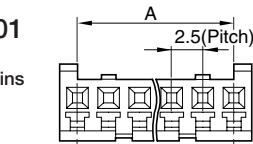

■ Material and Plating

● Housing : Thermoplastic Resin, Beige, 94V-0

■ 材質・表面処理

●ハウジング：熱可塑性樹脂 ベージュ 94V-0

● Plug

□□ No. of Pins	Straight Type	Right-Angle Type	A	B
2	CLP2502-0101F	W-P9102#51F	2.5	4.7
3	CLP2503-0101F	W-P9103#51F	5.0	7.2
4	CLP2504-0101F	W-P9104#51F	7.5	9.7
5	CLP2505-0101F	W-P9105#51F	10.0	12.2
6	CLP2506-0101F	W-P9106#51F	12.5	14.2
7	CLP2507-0101F	W-P9107#51F	15.0	17.2
8	CLP2508-0101F	W-P9108#51F	17.5	19.7
9	CLP2509-0101F	W-P9109#51F	20.0	22.2
10	CLP2510-0101F	W-P9110#51F	22.5	24.7
11	CLP2511-0101F	W-P9111#51F	25.0	27.2
12	CLP2512-0101F	W-P9112#51F	27.5	29.7
13	CLP2513-0101F	W-P9113#51F	30.0	32.2
14	CLP2514-0101F	W-P9114#51F	32.5	34.7
15	CLP2515-0101F	W-P9115#51F	35.0	37.2

Straight Type

CLP 25□□-0101F

↑ No. of Pins

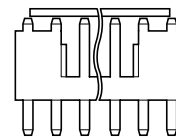
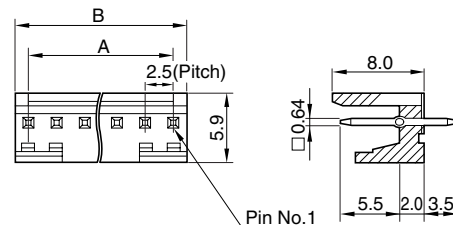

Right-Angle Type

W-P91□□#51F

↑ No. of Pins

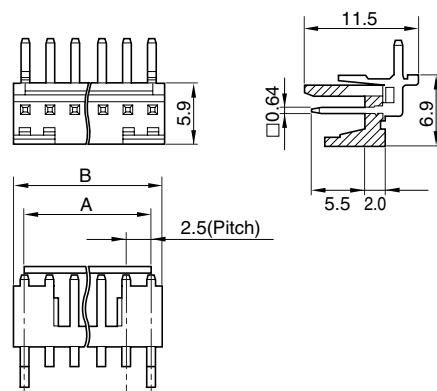

■ Material and Plating

● Housing : Thermoplastic Resin, Beige, 94V-0

● Plug Pin : Cu Alloy, Sn Plating

■ 材質・表面処理

●ハウジング：熱可塑性樹脂 ベージュ 94V-0

●プラグピン：銅合金 すずめっき