



## 2.5mm WAFER RIGHT ANGLE / STRAIGHT TYPE

### SPECIFICATIONS

Current Rating: 3A AC,DC  
 Voltage Rating: 250V AC,DC  
 Temperature Range: -25°C ~ +85°C  
 Contact Resistance: 10mΩ Max  
 Insulation Resistance: 1000MΩ Min  
 Withstanding Voltage: 800V AC/minute  
 Pin Material: Brass/Tin-plated  
 Material: Nylon 66,UL94V-0  
 Color: Natural(White)

PART NO.	Dimensions	
	A	B
2505R-02TW-L	2.50	7.50
2505R-03TW-L	5.00	10.00
2505R-04TW-L	7.50	12.50
2505R-05TW-L	10.00	15.00
2505R-06TW-L	12.50	17.50
2505R-07TW-L	15.00	20.00
2505R-08TW-L	17.50	22.50
2505R-09TW-L	20.00	25.00
2505R-10TW-L	22.50	27.50
2505R-11TW-L	25.00	30.00
2505R-12TW-L	27.50	32.50
2505R-13TW-L	30.00	35.00
2505R-14TW-L	32.50	37.50
2505R-15TW-L	35.00	40.00

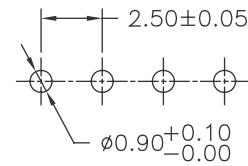
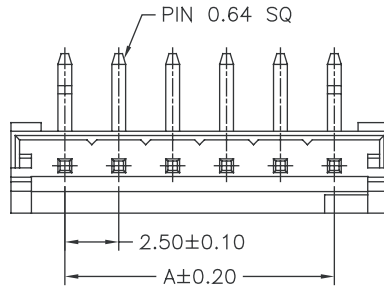

P.C.B LAYOUT

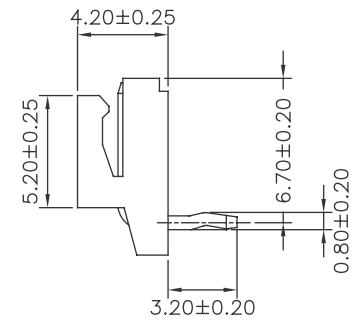
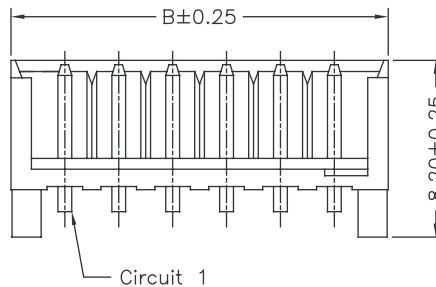

### Part No.:2505R-XXTW-L

### SPECIFICATIONS

Current Rating: 3A AC,DC  
 Voltage Rating: 250V AC,DC  
 Temperature Range: -25°C ~ +85°C  
 Contact Resistance: 10mΩ Max  
 Insulation Resistance: 1000MΩ Min  
 Withstanding Voltage: 800V AC/minute  
 Pin Material: Brass/Tin-plated  
 Material: Nylon 66,UL94V-0  
 Color: Natural(White)

PART NO.	Dimensions	
	A	B
2505S-02TW-L	2.50	7.50
2505S-03TW-L	5.00	10.00
2505S-04TW-L	7.50	12.50
2505S-05TW-L	10.00	15.00
2505S-06TW-L	12.50	17.50
2505S-07TW-L	15.00	20.00
2505S-08TW-L	17.50	22.50
2505S-09TW-L	20.00	25.00
2505S-10TW-L	22.50	27.50
2505S-11TW-L	25.00	30.00
2505S-12TW-L	27.50	32.50
2505S-13TW-L	30.00	35.00
2505S-14TW-L	32.50	37.50
2505S-15TW-L	35.00	40.00

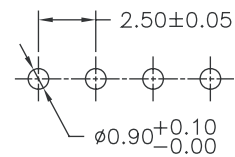
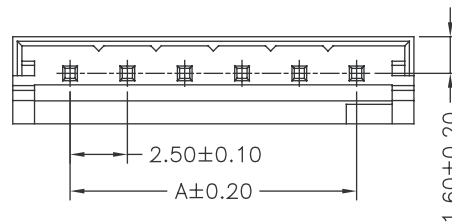

P.C.B LAYOUT

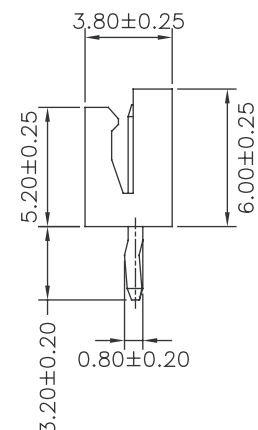
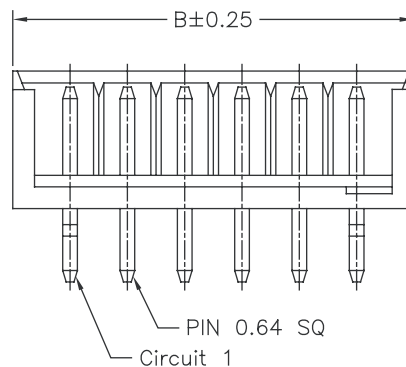

### Part No.:2505S-XXTW-L