

		REVISIONS			
SYM	DESCRIPTION	DATE	APPROVED	SYM	DESCRIPTION
Δ	NOTE ROHS STANDARD	31/MAR/06	AARON	Δ	
Δ				Δ	

**\*\*CUSTOMER DRAWING FOR REFERENCE ONLY, SAMPLES APPROVAL ARE REQUIRED!!**

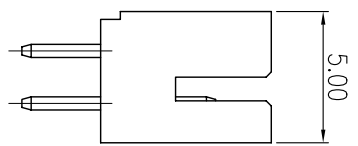
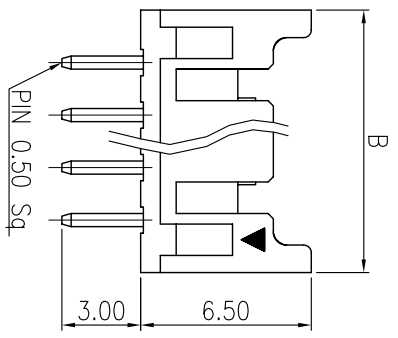
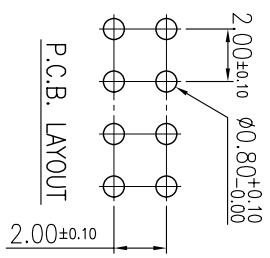
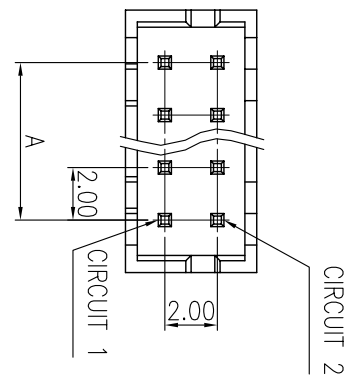

PART NO.	Contacts	DIMENSIONS(mm)	
		A	B
MCB005-P0202T	2X2	2.00	6.00
MCB005-P0302T	2X3	4.00	8.00
MCB005-P0402T	2X4	6.00	10.00
MCB005-P0502T	2X5	8.00	12.00
MCB005-P0602T	2X6	10.00	14.00
MCB005-P0702T	2X7	12.00	16.00
MCB005-P0802T	2X8	14.00	18.00
MCB005-P0902T	2X9	16.00	20.00
MCB005-P1002T	2X10	18.00	22.00
MCB005-P1102T	2X11	20.00	24.00
MCB005-P1202T	2X12	22.00	26.00
MCB005-P1302T	2X13	24.00	28.00
MCB005-P1402T	2X14	26.00	30.00
MCB005-P1502T	2X15	28.00	32.00
MCB005-P1602T	2X16	30.00	34.00
MCB005-P1702T	2X17	32.00	36.00
MCB005-P1802T	2X18	34.00	38.00
MCB005-P1902T	2X19	36.00	40.00
MCB005-P2002T	2X20	38.00	42.00

**SPECIFICATIONS**  
 CURRENT RATING: 1A AC,DC  
 VOLTAGE RATING: 130V AC,DC  
 TEMPERATURE RANGE: -25°C ~ +85°C  
 CONTACT RESISTANCE: 20MΩ MAX.  
 INSULATION RESISTANCE: 1000MΩ MIN.  
 WITHSTAND VOLTAGE : 800V AC / MINUTE  
 PIN MATERIAL: BRASS / TIN-PLATED  
 MATERIAL: NYLON 66, UL94V-0, LEAD FREE

**ORDER INFORMATION**  
 MCB005-PXX02T  
 MC: WAFER SERIES  
 b: PITCH = 2.00mm  
 005: SERIES NO.  
 P: POB TYPE, STRAIGHT  
 XX: NO. OF CONTACTS  
 02: DOUBLE ROWS  
 T: CONTACT PLATING, TIN  
 PLATED OVER ALL

MATING	HOUSING	MCB005-XX02-H	TERMINAL	MCB005-T
TOLERANCES UNLESS OTHERWISE SPECIFIED ±0.30	SIGNATURES	DATE	TITLE	MODEL
DRAWN VVI	09/DEC/03	09/DEC/03	WAFER	
CHECKED ZOJA	APPROVALS	NO.	MCB005-P__02T	
SYMBOL UNIT mm	SCALE 5/1			

MMT CORPORATION