

Recommended PCB Layout

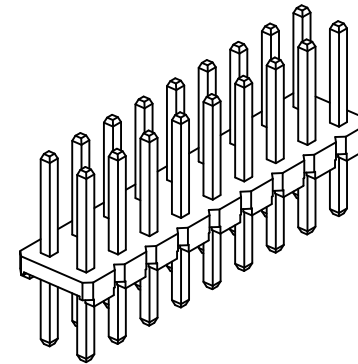
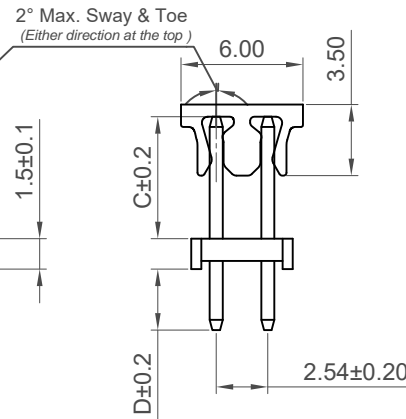
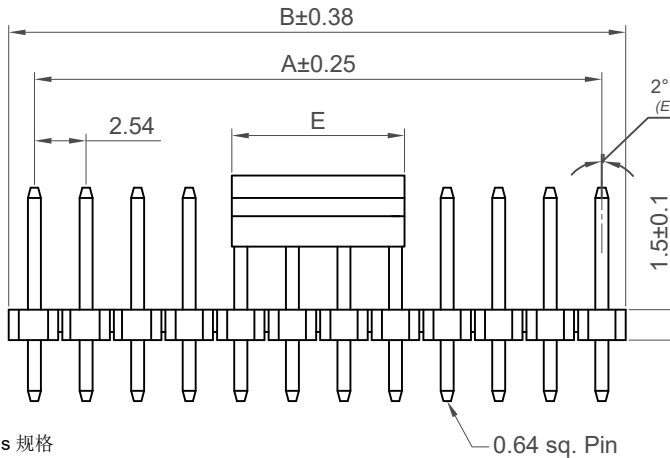

Specifications 规格

Material 物料

Insulator material 绝缘体:  
Standard 标准物料: Polyamide, Nylon 6T, UL94V-0  
Option 可选物料: Polyester, LCP, UL94V-0

Contact Terminal 接触端子: Copper Alloy  
Metallic Shell 金属外壳: Stainless Steel

Plating 电镀

See ordering grid

Electrical 电气

Current Rating 电流额定值: 3 Amp per pin  
Contact Resistance 接触电阻值: 20 mΩ max  
Insulation Resistance 绝缘电阻值: 1000 MΩ min.  
Dielectric Withstand Voltage 耐电压: 600 V AC

Mechanical & Environmental 机械 & 环境

Operating Temperature 工作温度: -40°C to +105°C  
Soldering Process 可焊性:

Nylon 6T (Standard 标准物料)

IR Reflow 回流焊: 260°C for 10 sec.

Wave 波峰焊: 230°C for 5-10 sec.

Manual Solder 人工焊接: 350°C for 3-5 sec

LCP (Option 可选物料)

IR Reflow 回流焊: 260°C for 10 sec.

Wave 波峰焊: 250°C for 5-10 sec.

Manual Solder 人工焊接: 350°C for 3-5 sec

Mates with 配套之母座 (Subject to pin length)

BG120	BG121	BG140	BG150	BG151
BG152	BG160	BG165	BG166	BG170
BG175	BG180	BG185	BG190	BG195
BG200	BG210	BG215	BG216	BG220
BG225				

Ordering Grid

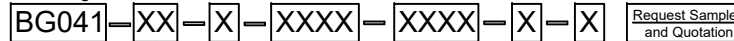

Contact Plating

**A = Gold Flash All Over (Standard)**  
B = Selective Gold Flash Contact Area/ Tin On Tail  
C = Tin All Over  
G = 10µ" Gold Contact Area/Tin On Tail  
I = 30µ" Gold Contact Area/Tin On Tail

Dimension C (1/100mm) (Post Height)

**0600 = 6.00mm (Standard)**  
Or specify custom Post Height  
eg. 0250 = 2.50mm

Packing Options

**G = Plastic Box (Standard)**  
B = Tape & Reel with Cap  
D = Tube  
E = Tube with Cap

Insulator Material

**N = Nylon 6T (Standard)**  
L = LCP

Dimension D (1/100mm) (Tail Length)

**0300 = 3.00mm (Standard)**  
Or specify custom Tail Length  
eg. 0250 = 2.50mm

Number of Contacts	Dimensions		
	A	B	E
4	2.54	5.08	5.00
6	5.08	7.62	6.00
8	7.62	10.16	
10	10.16	12.70	
12	12.70	15.24	
14	15.24	17.78	
16	17.78	20.32	
18	20.32	22.86	8.50
20	22.86	25.40	
22	25.40	27.94	
24	27.94	30.48	
26	30.48	33.02	
28	33.02	35.56	
30	35.56	38.10	
32	38.10	40.64	
34	40.64	43.18	
36	43.18	45.72	
38	45.72	48.26	
40	48.26	50.80	
42	50.80	53.34	
44	53.34	55.88	
46	55.88	58.42	
48	58.42	60.96	
50	60.96	63.50	
52	63.50	66.04	
54	66.04	68.58	
56	68.58	71.12	
58	71.12	73.66	
60	73.66	76.20	
62	76.20	78.74	
64	78.74	81.28	
66	81.28	83.82	
68	83.82	86.36	
70	86.36	88.90	
72	88.90	91.44	
74	91.44	93.98	
76	93.98	96.52	
78	96.52	99.06	
80	99.06	101.60	

Part Number		Product Description	
BG041		2.54mm Pitch Pin Header	
Drawing Date		Dual Row, Through Hole, Vertical, Low Profile	
13th April 2007			
By	AJO	Tolerances (Except as Noted)	Units:
Detail	Drawing Release	Length: X. ± 0.30	Metric (mm)
Revision	A1	Angle: X.X ± 0.20	
Date	04/02/15	X.XX ± 0.15	
		X.XXX ± 0.10	



This drawing is confidential and copyright of Global Connector Technology, Ltd (GCT). This drawing must not be copied or disclosed without written consent. E & OE

**GCT**  
Global Connector Technology  
www.gct.co

Not to Scale | Drawn By BC | Sheet No. 1/1

H  
G  
F  
E  
D  
C  
B  
A