

Series: SH

2mm Stamped In-Line Socket Strip

- ❖ Accepts square or round post
- ❖ Side and end stackable
- ❖ Single row 2 - 40 positions
- ❖ Dual row 4 - 80 positions

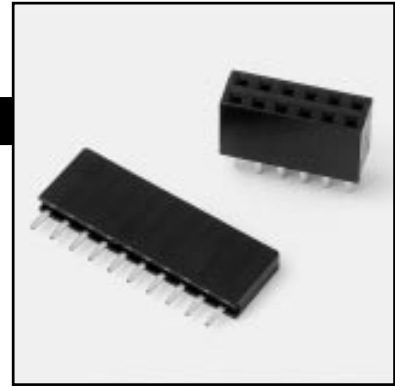

SHA

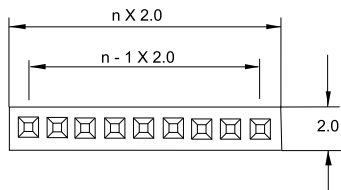

SHB

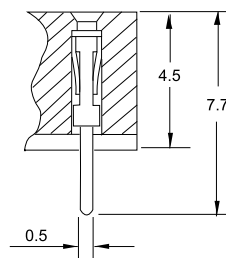
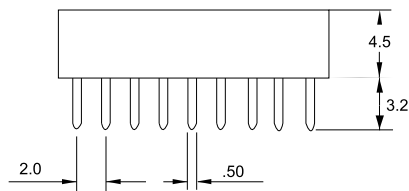
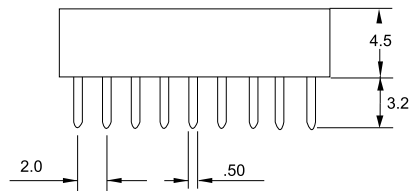
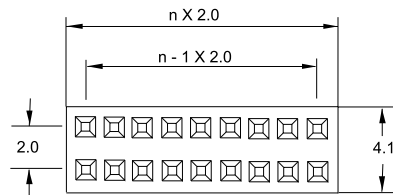

Ordering example: **SHA - 09 G**

Specifications

Stamped In-Line Socket Strip Series:

SH

Ratings:

Current	1A
Dielectric strength	AC 500 V for 1 minute
Contact resistance	30 mΩ max. at 100 mA DC
Insulator resistance	1000 MΩ min. at 500 V DC

Material:

Plastic	PBT Glass-filled, UL94V-0
Color	Black
Contact	Phosphor Bronze
Temperature range	-55°C / +105°C

ORDERING PROCEDURE

 1 - 2 3

- 1) Series
- 2) Number of Positions (see series page for available positions)
- 3) Plating:

Z = Tin
G = Gold

Please refer to following pages for ordering examples.