

REV.	SPECIFICATION	ECN NO.	APPD.
R5		ECN170528	

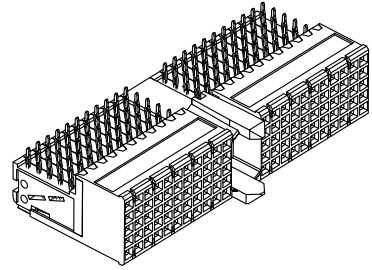
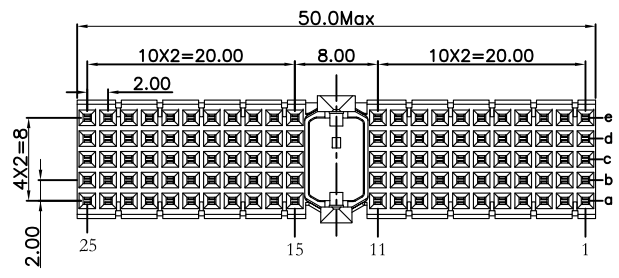

**Material:**  
Housing: Thermoplastic Polyester Glass Filled UL94V-0.  
Contacts: Copper Alloy

**Electrical Characteristics:**  
Current Rating: 1 AMP.  
Dielectric Withstanding Voltage: AC 750V For 1 minute.  
Insulator Resistance: 10000MΩ min. at DC 500V.  
Contact Resistance: 20mΩ max. at DC 100mA.  
Operating Temperature: -55°C ~+125°C .

**\*RoHS Compliant**  
Notes:  
No Post.

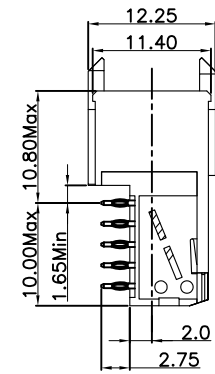
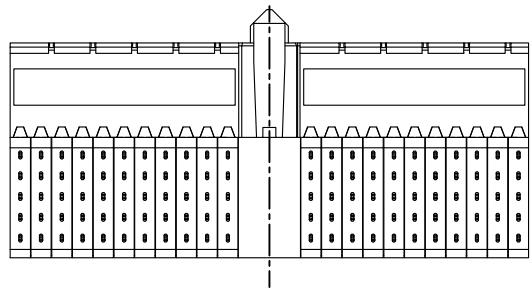

None Shielded

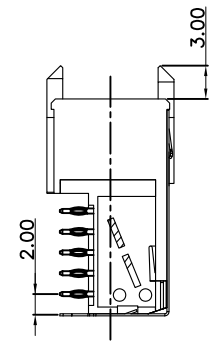

With Top Body Shielded

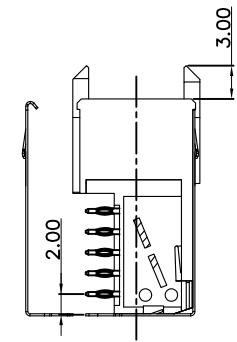

With Top Body Shielded and Bottom Shielded

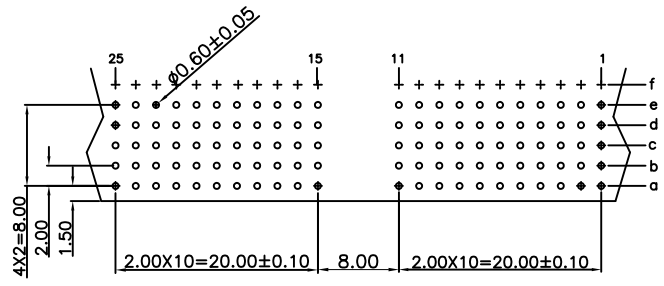

P.C. Board Layout  
(Top View)

9111- 7 2 A 110 x Cxx U -A001

Series: 9111-  
7Row:  
2: Female  
A: Type A  
Position: 110  
x: Cxx  
U: U  
-A001: Internal Code

U: Tube Package  
Cxx: Dip Tin Contact Gold  
10: 10u"  
30: 30u"  
CB30: Dip Tin Contact Au+Pd/Ni  
30: 30u"

1: None Shielded  
2: Top Body Shielded  
3: Top Body Shielded and Bottom Shielded (Package Separately)

<b>Tolerances</b>	<b>Dwg. No.</b>	9111D72013	<b>Title:</b>		<b>OUPIN</b> OUPIN ELECTRONIC(KUNSHAN) CO., LTD. P/N: 9111-72A110xCxxU-A001			
x = ±0.5	<b>Projection</b>		9111 Series Hard Metric Connector Female Right Angle Type A					
.x = ±0.25	<b>Unit</b>	mm			<b>Scale</b>	1:1		
.xx = ±0.15	<b>Drawn By</b>	LQ 05/17'17						