

ALL PLASTIC RECEPTACLES

.590 RIGHT ANGLE P.C. MOUNT CONNECTORS

GENERAL DESCRIPTION

Widely used in computer, telecom-communications and instrumentation equipment applications, Viking's all-plastic, right-angle D-Subminiature receptacles provide an ideal, low-cost method of interfacing P.C. boards to I/O cable connectors, either directly or through back panels. All-plastic construction allows mounting directly over P.C. board traces without sacrificing shielded input connector grounding capability in panel applications. Rigid contact tails increase board insertion rates while generous lead-ins and chamfers provide self-alignment with up to .030" mismatching.

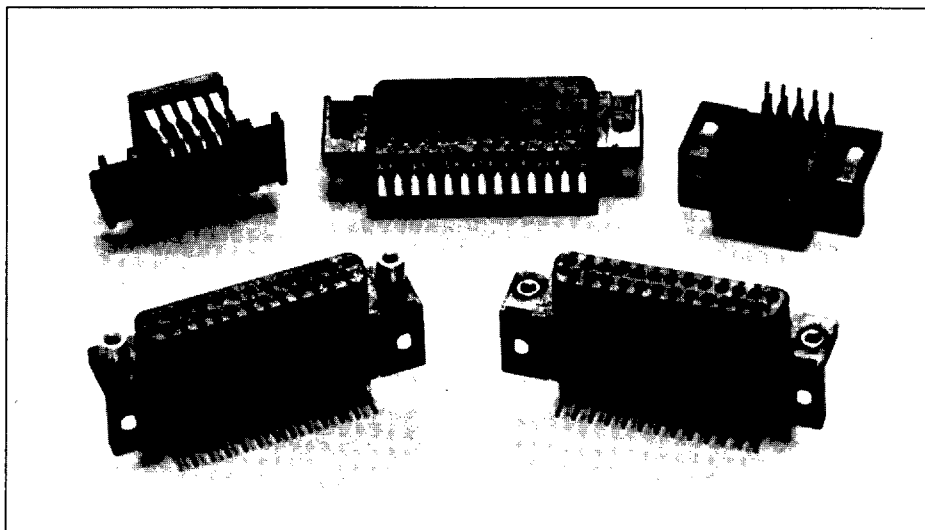

PRODUCT FEATURES

DESIGN FLEXIBILITY

- Fully intermateable with any other standard crimp, solder, or IDC D-Subminiature connectors
- Generous lead-in and chamfered edges make these connectors ideal for blind mating applications
- 9, 15, 25, 37 contact configurations
- 2 choices of selective gold plating (10 or 30 micro-inches)

- 3 mounting options available
- All-plastic construction allows direct mounting over circuit traces

COST SAVERS

- Competitively priced
- Short lead times reduce user inventory costs

RUGGED CONSTRUCTION

- Insulator is high-quality, U.L. 94V-0 approved, flame-retardant thermoplastic
- Rigid U-channel contact tails for fast, easy insertion into P.C. boards
- U.L. listed, C.S.A. certified

ORDERING INFORMATION

DS	R	ST	25	RA	05
----	---	----	----	----	----

SERIES ORDER CODE: _____

DS: All plastic
D-Subminiature Series

PART IDENTIFIER CODE: _____

R: Receptacle

CONTACT PLATING CODES: _____

ST: .000010 selective gold
plating over nickel

ZT: .000030 selective gold
plating over nickel

MOUNTING STYLE
CODES:

- 01:** Thru Hole
- 05:** Threaded Insert
- 09:** Round Standoff

FOOTPRINT CODES:

RA: .590 Right Angle

NUMBER OF
CONTACTS CODES:

(Code number equals
number of contacts.)

09, 15, 25, 37

ALL PLASTIC D-SUBMINIATURE RECEPTACLES

.590 RIGHT ANGLE P.C. CONNECTORS

DESIGN INFORMATION

09, 15, 25 AND 37 POSITION ASSEMBLIES

RIGHT ANGLE FOOTPRINT (ORDER CODE: RA)

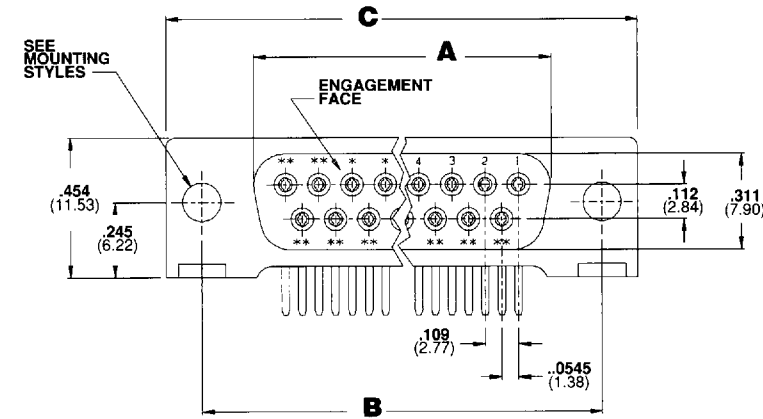

CONTACT TERMINATION CROSS SECTION

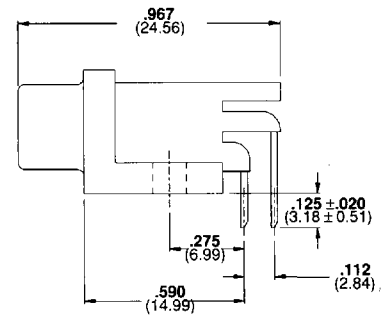
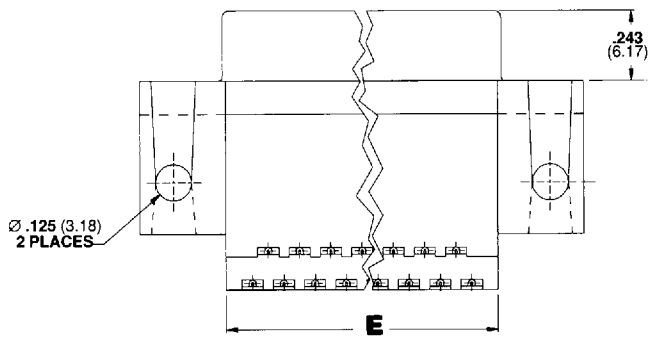
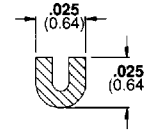

RECOMMENDED P.C.B. HOLE PATTERN

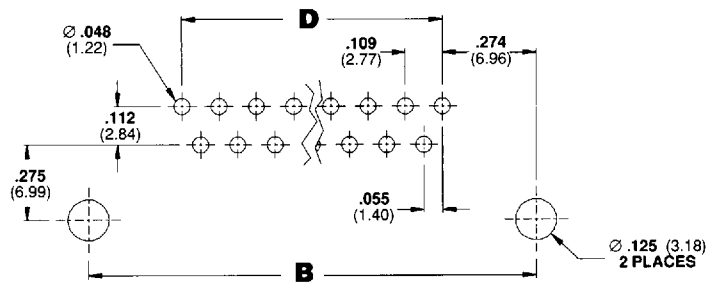

TABLE OF DIMENSIONS: Receptacles

NUMBER OF POSITIONS	A $\pm .005$ (0.13)	B $\pm .005$ (0.13)	C $\pm .010$ (0.25)	D BSC	E $\pm .010$ (0.25)
9	.643 (16.33)	.984 (24.99)	1.218 (30.94)	.436 (11.07)	.625 (15.88)
15	.971 (24.66)	1.312 (33.32)	1.546 (39.27)	.763 (19.38)	.953 (24.21)
25	1.511 (38.38)	1.852 (47.04)	2.086 (52.98)	1.308 (33.22)	1.493 (37.92)
37	2.159 (54.84)	2.500 (63.50)	2.734 (69.44)	1.962 (49.83)	2.141 (54.38)

NOTE: Dimensions are in inches and (millimeters). Tolerance $\pm .010$ (.25) unless otherwise specified.

ALL PLASTIC RECEPTACLES

.590 RIGHT ANGLE P.C. MOUNT CONNECTORS

SPECIFICATIONS

ELECTRICAL

Current Rating: 5 amps max.

Insulation Resistance:
5000 megohms min.

Contact Resistance:
10 milliohms max., mated

Dielectric Withstanding Voltage:
1000 VAC min.

MECHANICAL

Contact Retention: 3 lbs. min.

Durability, Mating Cycles:

CODE ST: 100 cycles

CODE ZT: 500 cycles

Ambient Temperature Range:
-67°F to +257°F (- 55°C to +125° C)

ENGAGEMENT & SEPARATION FORCES

Insertion: 12 oz. max. per contact

Withdrawal: 0.7 oz. min. per contact

MATERIALS AND FINISHES

INSULATOR:

Glass-filled thermoplastic, U.L.
Rated 94V-0; Color, black

CONTACT: Copper Alloy

CONTACT FINISH:

Underplate:

Nickel all over (.000050 min. thick)

Engagement Area:

CODE ST: .000010 gold

CODE ZT: .000030 gold

Termination Area: .000150 min.
thick tin-lead

MOUNTING HARDWARE:

Brass with nickel plate

APPROVALS, CERTIFICATIONS

U.L.

All D-Subminiature connectors are listed under the component program of Underwriters Laboratories, Inc., File E 74125.

CSA

CSA Certified. Certification report available from factory. File No. LR61763.

Specifications contained herein are subject to change without notice. Consult Viking for current data.

PRODUCT OPTIONS

NUMBER OF CONTACTS

ORDER CODES: 09, 15, 25, 37

(Code equals number of contacts.)

CONTACT PLATING

ORDER CODE ST: .000010 selective gold over nickel

ORDER CODE ZT: .000030 selective gold over nickel

MOUNTING STYLES

Viking offers three mounting styles for .590 all plastic D-Subminiature connectors: Code 01, Thru Hole; Code 05, 4-40 UNC-2B threaded insert; Code 09, 4-40 UNC-2B Round Stand-off. Key performance characteristics include 15 lbs. minimum axial force and torque retention of 6 inch-pounds minimum.

THRU HOLE

ORDER CODE:
01

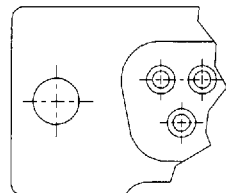

Ø .125 (3.18)
CLEARANCE HOLE

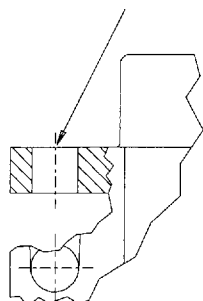

THREADED INSERT

ORDER CODE:
05

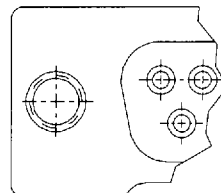

4-40 UNC-2B
THREADED INSERT

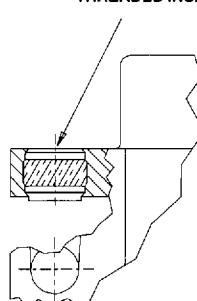

ROUND STAND-OFF

ORDER CODE:
09

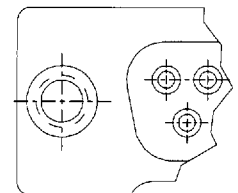

4-40 UNC-2B
ROUND STAND OFF

