

8 7 6 5 4 3 2 1

NOTE: THIS DEVICE IS ROHS COMPLIANT.

SYM	DESCRIPTION	DATE	APPROVED	SYM	DESCRIPTION	DATE	APPROVED
△	NOTE ROHS STANDARD	19/Jun/05'	CONNIE	△			

****CUSTOMER DRAWING FOR REFERENCE ONLY, SAMPLES APPROVAL ARE REQUIRED!!**

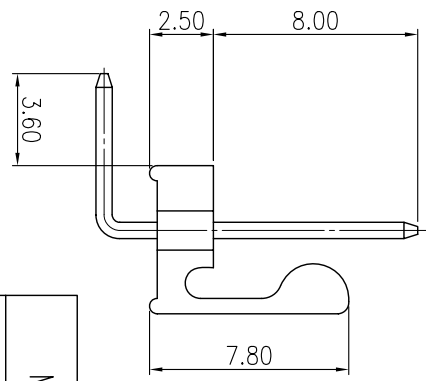
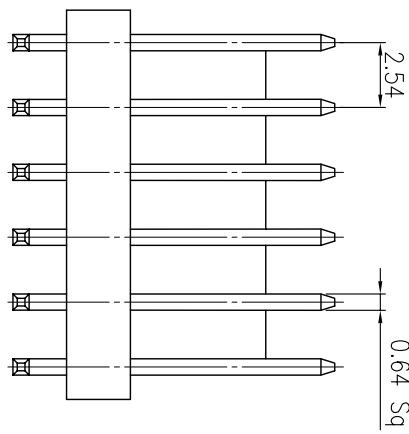
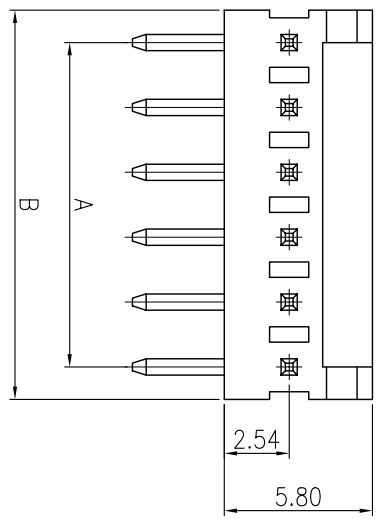

SPECIFICATIONS
 POLES : 2 - 28
 VOLTAGE RATING : 250V AC, DC
 CURRENT RATING : 2A, AC, DC
 WITHSTANDING VOLTAGE: 1000V AC/MINUTE
 INSULATION RESISTANCE: 1000MEGΩHMS min.
 TEMPERATURE RANGE: -25°C ~ +85°C

MATERIAL :
 CONTACT : COPPER ALLOY, TIN PLATED
 BASE : NYLON UL94V-0

ORDER INFORMATION:
 MCd006-PdXXT
 MC: WAFER SERIES, WAFER
 g: PITCH: 2.54 mm
 006: SERIES NO.
 Po: PCB TYPE, RIGHT ANGLE TYPE
 XX: NO. OF CONTACTS
 T: PLATING, TIN PLATING

PART NO.	CIRCUITS	DIMENSION	
		A	B
MCd006-Pd02T	2	2.54	5.08
MCd006-Pd03T	3	5.08	7.62
MCd006-Pd04T	4	7.62	10.16
MCd006-Pd05T	5	10.16	12.70
MCd006-Pd06T	6	12.70	15.24
MCd006-Pd07T	7	15.24	17.78
MCd006-Pd08T	8	17.78	20.32
MCd006-Pd09T	9	20.32	22.86
MCd006-Pd10T	10	22.86	25.40
MCd006-Pd11T	11	25.40	27.94
MCd006-Pd12T	12	27.94	30.48
MCd006-Pd13T	13	30.48	33.02
MCd006-Pd14T	14	33.02	35.56
MCd006-Pd15T	15	35.56	38.10
MCd006-Pd16T	16	38.10	40.64
MCd006-Pd17T	17	40.64	43.18
MCd006-Pd18T	18	43.18	45.72
MCd006-Pd19T	19	45.72	48.26
MCd006-Pd20T	20	48.26	50.80
MCd006-Pd21T	21	50.80	53.34
MCd006-Pd22T	22	53.34	55.88
MCd006-Pd23T	23	55.88	58.42
MCd006-Pd24T	24	58.42	60.96
MCd006-Pd25T	25	60.96	63.50
MCd006-Pd26T	26	63.50	66.04
MCd006-Pd27T	27	66.04	68.58
MCd006-Pd28T	28	68.58	71.32

MATING		MCd006 HOUSING SERIES		TERMINAL		MODEL	
TOLERANCES UNLESS OTHERWISE SPECIFIED		IDC CONNECTOR DcCd101-FXXT		MCd006-T		MCd006-T	
OTHERWISE SPECIFIED		SIGNATURES		DATE		TITLE	
±0.25		DRAWN TONY		26/NOV/02'		WAFER	
CHECKED ZOLA		APPROVALS		26/NOV/02'		NO.	
SCALE 5/1						MCd006-Pd__T	

MMT CORPORATION

TEL: (510) 979-2188 www.mmtmachrone.com FAX: (510) 979-2189