

New Product New Package, ZP

Power Surface Mount Type Package 'ZP' only 2.5mm thick

SANYO new package ZP of surface mount type holds the power chip of 50W within 10X10X2.5mm³ to meet the need for smaller and thinner systems.

- * Adopting step-sectioned lead-frame structure eliminates solder bridge resulting in high quality surface mounting.
- * Formingless leads assure accurate lead form.
- * Enables to realize low consumption, power saving, smaller and thinner sets.
- * Power MOSFETs and SBDs. are available.

Because of new products, please contact Product Planning Department if you have a plan to use these new products.

Power MOSFETs Features

- * Low on-resistance.
- * High-speed switching.
- * Low voltage drive.

VDSS 30V system

For P-channel, "-" sign is omitted.

Type No.	Absolute Maximum Ratings /Ta=25°C					Electrical Characteristics /Ta=25°C			Type No.
	V _{DSS} (V)	V _{GSS} (V)	I _D (A)	I _{DP} (A) Tc=25°C	P _D (W)	V _{GS(off)} min (V)max	R _{DS(on)} VGS=10V typ/max(Ω)	C _{iss} typ (pF)	
2SJ437	30	±20	35	120	50	2.7 (typ)	16m (typ)	4300	2SJ437
2SK2432			35	140	50	1 ~ 2	15m/25m	2000	2SK2432
2SK2464			50	180	50	2 ~ 4	9m/12m	3000	2SK2464

Case Outlines (unit:mm)

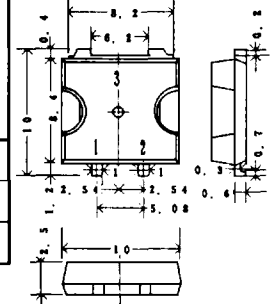

Top view: MOSFET
1: Gate, 2: Source, 3: Drain
S. B. D
1: Anode, 2: Anode,
3: Cathode

VDSS 60V system

2SJ414	60	±20	15	72	50	1 ~ 2	60m/80m	1900	2SJ414
2SJ415			8	40	40		0.11/0.15	1230	2SJ415
2SK2433			25	120	50		30m/40m	1900	2SK2433

VDSS 250V system (With built-in recovery diode)

2SJ454	250	±30	5	20	40	2 ~ 4	0.98/1.3	1150	2SJ454
2SJ455			7	28	45		0.65/0.9	1650	2SJ455
2SJ456			9	36	50		0.45/0.62	2500	2SJ456
2SK2531			6	24	30		0.6/0.8	550	2SK2531
2SK2532			10	40	40		0.3/0.4	1150	2SK2532
2SK2533			12	48	45		0.22/0.28	1650	2SK2533
2SK2534			16	64	50		0.15/0.2	2500	2SK2534

FRD: Fast recovery diode

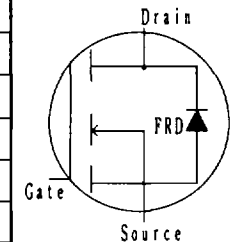

VDSS 450V system

2SK2434	450	±30	5	20	40	2 ~ 3	1/1.4	700	2SK2434
---------	-----	-----	---	----	----	-------	-------	-----	---------

VDSS 800V system

2SK2435	800	±30	3.5	10.5	40	3.5 ~ 5.5	2.8/3.6	700	2SK2435
2SK2436			7	21	50		1.4/1.8	1500	2SK2436

Schottky Barrier Diodes (Ta=25°C) (twin type · cathode common)

Features

- * Low forward voltage.
- * Short recovery time.
- * Low switching noise.
- * high reliability planar structure.
- * Enables assembly time reduction and miniaturization due to high density assembly. Available for surface mount assembly.

Type No.	Absolute Maximum Ratings				Electrical Characteristics			Type No.
	V _{RRM} (V)	I _O (A)	I _{FSM} (A)	I _F (A)	V _F max (V)	V _R (V)	I _R max (mA)	
SBA100-04ZP	40	10	100	5	0.55	20	0.2	SBA100-04ZP
SBA160-04ZP	40	16	120	8	0.55	20	0.3	SBA160-04ZP

Electrical connection

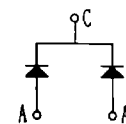

These specifications are subject to change without notice.