

PRODUCT NUMBER
SEE TABLE

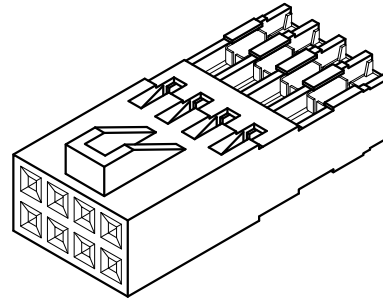
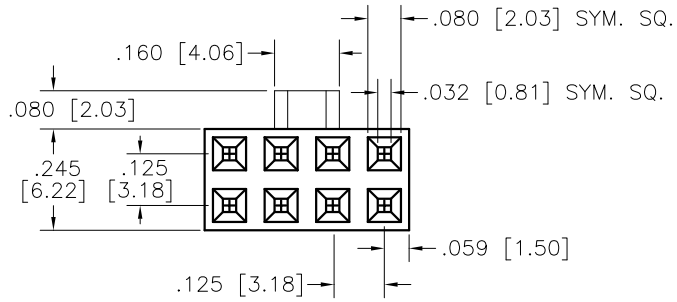
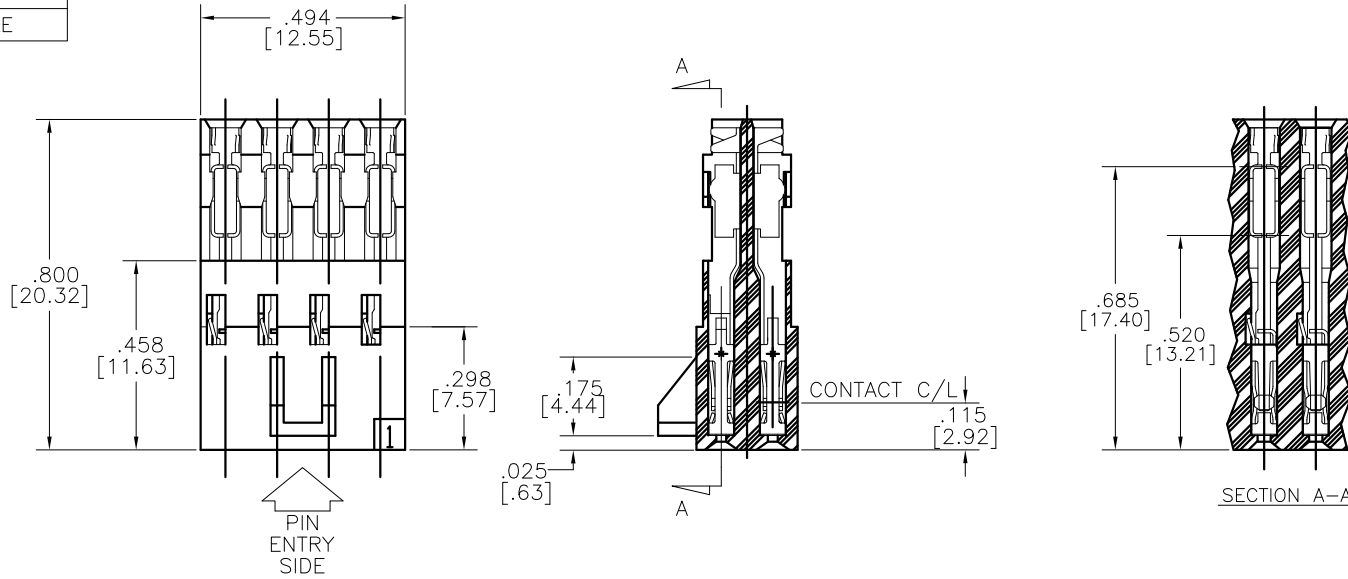

mat'l. code		surface		tolerance		projection		product family	
SEE NOTE 1		ASME Y14.5		ASME Y14.5		INCH/MM		NORCON	
ltr	ecm no	dr	date	tolerances unless otherwise specified		scale N.T.S.		title	
B	V05-0899	HTB	2005-09-20	angles	xxx+.005/XX+.13			CABLE CONNECTORS - CID02	
C	V06-0662	JRV	2006-07-10	inclin				2x4/2X12 POL. .125" GRID	
D	V06-0988	HTB	2006-09-26					dwg no	
E	V09-0115	HTB	2009-03-23	dr	T. BREWBAKER	2005-09-20	sheet 1 of 2		size
				engr	T. BREWBAKER	2005-09-20	54320		A4
				chr	T. BREWBAKER	2005-09-20	FCI		
				appd	T. BREWBAKER	2005-09-20	type		CUSTOMER Drawing
sheet index	revision sheet	E	E						
		1	2						

PRODUCT NO.	ENG. CODE	DESCRIPTION	
A0370057	CID02BA24AB00LNPOL	24 POSITIONS (2x12) MADE OF 2 REGULAR 2x4 CONNECTORS (A0329312) AND 1 POLARIZED 2x4 CONNECTOR (A0376308) DIMENSIONS AS ON SHEET 1 OVERALL LENGTH 1.494" [37.95]	OBSOLETE
A0370057LF	-	24 POSITIONS (2x12) MADE OF 2 REGULAR 2x4 CONNECTORS (A0329312LF) AND 1 POLARIZED 2x4 CONNECTOR (A0376308LF) DIMENSIONS AS ON SHEET 1 OVERALL LENGTH 1.494" [37.95]	OBSOLETE
A0376308	CID02BA08AB00LNPOL	8 POSITIONS (2x4) WITH POLARIZATION KEY	
A0376308LF	-	8 POSITIONS (2x4) WITH POLARIZATION KEY	

FEATURES:

- * .125" (3.175 mm) GRID - 2 ROWS
- * 8 CONTACTS
- * PART OF A 2x12 CONNECTOR KIT (24 CONTACTS)
- * STACKABLE BOTH SIDE BY SIDE AND END TO END
- * BIFURCATED CONTACT DESIGN (N/S ORIENTATION)
- * SELECTIVELY PLATED GOLD CONTACT
- * POLARIZED KEYING FEATURE ON BODY
- * IDC WITH STRAIN RELIEF FOR 24-26 AWG WIRE
- * INTENDED FOR USE WITH .025/0.64 SQUARE PINS

ASSOCIATED COMPONENTS:

- * APPLICATION TOOLING
 - NT-230 DESKTOP SEMI-AUTOMATIC CRIMPING MACHINE
 - HT-138E CRIMPING HAND TOOL
- * 2x4 COVER: SEE DRAWING 54323
- * 2x4 POLARIZED COVER: SEE DRAWING 54323
- * 2x12 COVER: SEE DRAWING 54324
- * 2x4 COVER 90° WIRE ENTRY: SEE DRAWING 54326

OPTIONS:

- * SHORTED POSITIONS SEE DRAWING 54322

SPECIFICATIONS-MECHANICAL:

- * INSERTION FORCE - 150 G/CONTACT MAX
- * WITHDRAWAL FORCE: 20 G/CONTACT MIN
- * CONTACT RETENTION: 1200 G/CONTACT MIN
- * CONTACT NORMAL FORCE: 120 G/CONTACT MIN
- * DURABILITY: 200 CYCLES
- * OPERATING TEMPERATURE: -55°C TO +85°C

SPECIFICATIONS-ELECTRICAL:

- * CURRENT RATING(CONTINUOUS): 1 AMP/CONTACT MAX
- * CONTACT RESISTANCE: 20 MILLIOHMS MAX
- * INSULATION RESISTANCE: 5000 MEGOHMS MIN
- * DIELECTRIC WITHSTAND VOLTAGE: 1000V RMS

NOTES:

- ① HOUSING MATERIAL: PBT, GLASS FIBER REINFORCED, FLAME RETARDANT PER UL 94V-0, COLOR: BLACK.
TERMINAL MATERIAL: CA510 ALLOY
CONTACT FINISH: 50u"/1.27u Au
CONTACT UNDERPLATE: 100u"/2.54u Ni
IDC FINISH: 50u"/1.27u Ni
OVERALL UNDERPLATE: 20u"/0.51u Ni
2. PACKAGED IN ANTI-STATIC TRAYS.
3. PART NUMBERS WITH AN LF SUFFIX MEET EUROPEAN UNION DIRECTIVES AND OTHER COUNTRY REGULATIONS AS DESCRIBED IN GS-22-008.
4. THIS PRODUCT IS NOT INTENDED TO BE EXPOSED TO MANUFACTURING SOLDER PROCESSES.

mat'l. code		surface		tolerance		projection		product family	
SEE NOTE 1		ASME Y14.5		ASME Y14.5				NORCON	
ltr	ecn no	dr	date	tolerances unless otherwise specified		INCH/MM		file	
E				angles	imp	XXX+005/XX+13		CABLE CONNECTORS - CID02	
						scale N.T.S.		2x4/2x12 POL. .125" GRID	
		dr	T. BREWBAKER	2005-09-20				dwg no	
		engr	T. BREWBAKER	2005-09-20				sheet 2 of 2	
		chr	T. BREWBAKER	2005-09-20				size	
		appd	T. BREWBAKER	2005-09-20				A4	
sheet index		revision sheet						type	
								CUSTOMER Drawing	