

**AMPHENOL D-SUBMINIATURE
FIXED PRECISION FORMED CONTACT CONNECTOR**

17SD SERIES
A-61-11
A-17-05

Amphenol's 17SD series is the lowest cost member of the fixed contact family.

The 17SD connector features precision formed contacts available in a broad range of solder terminations. This series gives you Amphenol's high standards of quality and reliability to meet all of your commercial requirements.

Filter connectors available—
contact factory.

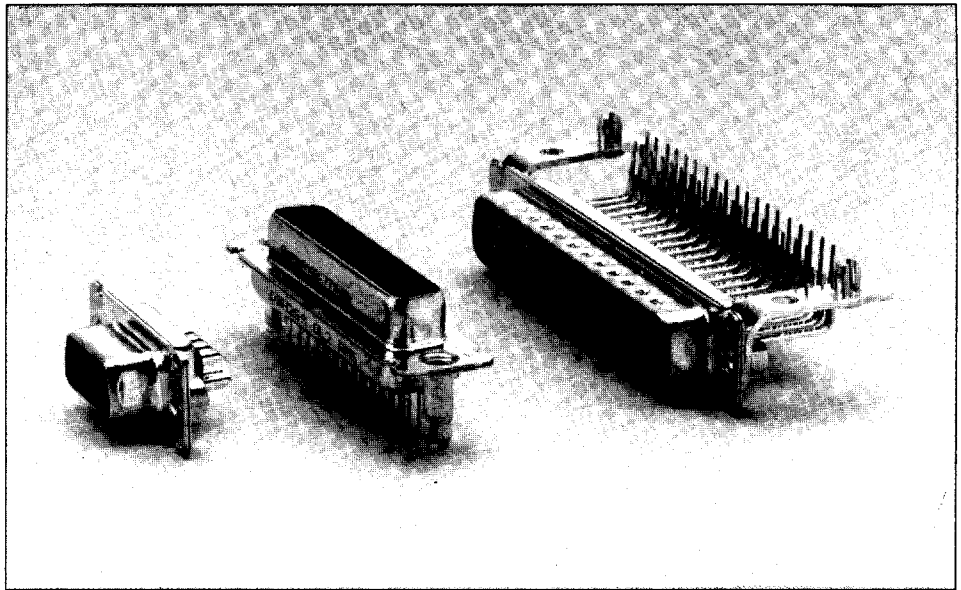

SPECIFICATIONS:

Temperature Range:
-55° C to +105° C

Voltage Rating:
300 V RMS to 50Hz

Current Rating:
7.5 Amph

Dielectric:
Two-piece black thermoplastic UL 94 VO

Insulation Resistance:
> 5000 megaohms

Shells:
Steel/tin-plated, grounding indents on plug front shell or zinc/yellow chromate

Dielectric Withstanding Voltage:
> 1000V RMS to 50Hz

DIMENSIONS:
See page 47

Contacts:
Precision formed copper alloy

Contact Plating:
Gold over Nickel

Insertion Force:
4.3 oz. < F < 9.0 oz. per contact

Contact Resistance:
< 5 milliohms

ORDERING INFORMATION:

17SD - A - X - 15 - P - XXXX

Contact & Shell Plating Prefix

Contact Plating	Shell Plating		
	Yellow Chromate	Tinned	Tinned & Indents*
.000010" gold over nickel	17SD	77SD	717SD
.000020" gold over nickel	117SD	177SD	777SD

*plug only

Shell Size

- E (9)
- A (15)
- B (25)
- C (37)
- D (50)

Code
P Pin
S Socket

Number of contacts
9,15,25,37,50

Mounting Type

- Blank .122 (3.1) dia. mounting holes
- F float bushings (front or rear mount)
- G M3 rear clinch nut
- H #4-40 rear clinch nut
- K .165 (4.2) dia. mounting holes

Code
Blank solder cup
T straight pc (see next page)
OL2 straight pc (see next page)
AJ4 right angle pc (see next page)
AM4 right angle pc (see next page)
AM4B right angle pc (see next page)
1AON right angle pc (see next page)
1AMN right angle pc (see next page)
1APN right angle pc (see next page)
1ATN right angle pc (see next page)
1AUN right angle pc (see next page)

**AMPHENOL D-SUBMINIATURE
FIXED PRECISION FORMED CONTACT CONNECTOR**

17SD SERIES

Printed Circuit Terminations

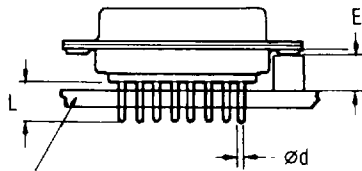

PC BOARD

Termination	Ø d	L	E
T	.024 (0.60)	.157 (4.0)	.185 (4.7)
OL2	.024 (0.60)	.217 (5.5)	.240 (6.1)

Right Angle Printed Circuit Terminations

TERMINATION	CODE	PC TAIL DIA. Inches (mm)	DESCRIPTION OF MOUNTING OPTIONS
figure 1 .283 Footprint	AJ4 AM4	.024 (0.60) .024 (0.60)	with plastic bracket with metal bracket Note: Also see 617 series (.318 foot print) on page #13.
figure 2 .370 Footprint	1AON 1AMN 1APN 1ATN 1AUN	.024 (0.60) .024 (0.60) .024 (0.60) .024 (0.60) .024 (0.60)	without bracket with riveted metal bracket with riveted plastic bracket with metal bracket and non-removable 4-40 front clinch nut with plastic bracket and non-removable 4-40 front clinch nut
figure 3 .545. Footprint	AM4B	.024 (0.60)	with metal bracket Note: Also see 617 series (.590 foot print) on page #13.

Grounding Tab Options

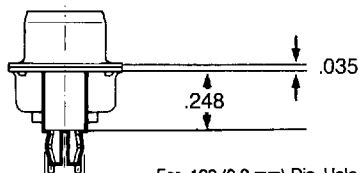

For .120 (3.2 mm) Dia. Hole: Add Suffix "(RM5)" for Straight P.C. Mount
For Tin-Plated Shells Only
Must be ordered with "OL2" termination:
77SDXXXS-OL2 (RM5)
717SDXXXP-OL2 (RM5)

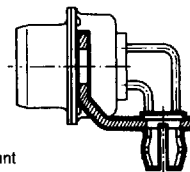

For .120 (3.2 mm) Dia. Hole:
Add Suffix "(RM6)" for Right Angle P.C. Mount
For Tin-Plated Shells & Metal Bracket Only
77SD or 717SD Prefix

**AMPHENOL D-SUBMINIATURE
DIMENSIONS**

17 SERIES

Rigid mount

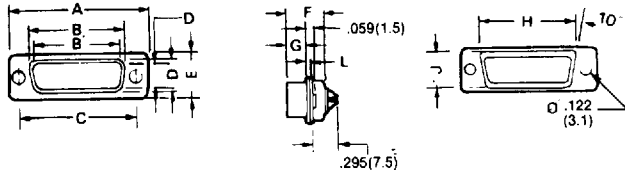

Float mount

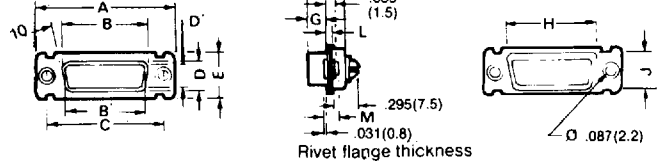

Contact Arrangements

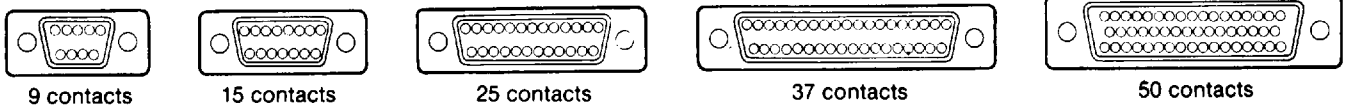

Shells	Contacts	A	B (S)	B (P)	C	D (S)	D (P)	E	F (S)	F (P)	G (S)	G (P)	H	J	L	M
E (9)	P	1.209 (30.7)		.661 (16.80)	.984 (24.99)		.318 (8.1)	.488 (12.4)		.407 (10.34)		.233 (5.94)	.767 (19.5)	.433 (11)	.039 (1)	.129 (3.3)
	S		.642 (16.3)			.307 (7.8)			.416 (10.57)		.242 (6.17)					
A (15)	P	1.535 (39)		.989 (25.12)	1.311 (33.32)		.318 (8.1)	.488 (12.4)		.407 (10.34)		.233 (5.94)	1.098 (27.9)	.433 (11)	.039 (1)	.129 (3.3)
	S		.970 (24.65)			.307 (7.8)			.416 (10.57)		.242 (6.17)					
B (25)	P	2.083 (52.9)		1.529 (38.84)	1.851 (47.04)		.318 (8.1)	.488 (12.4)		.403 (10.34)		.229 (5.84)	1.637 (41.6)	.433 (11)	.039 (1)	.129 (3.3)
	S		1.510 (38.35)			.307 (7.8)			.416 (10.57)		.242 (6.17)					
C (37)	P	2.724 (69.2)		2.177 (55.30)	2.500 (63.50)		.318 (8.1)	.488 (12.4)		.403 (10.34)		.229 (5.84)	2.283 (58)	.433 (11)	.039 (1)	.129 (3.3)
	S		2.157 (54.8)			.307 (7.8)			.416 (10.57)		.242 (6.17)					
D (50)	P	2.630 (66.8)		2.074 (52.68)	2.405 (61.11)		.425 (10.8)	.600 (15.25)		.403 (10.24)		.229 (5.84)	2.188 (55.6)	.543 (13.8)	.039 (1)	.129 (3.3)
	S		2.063 (52.4)			.419 (10.65)			.416 (10.57)		.242 (6.17)					

AMPHENOL D-SUBMINIATURE CONTACT ARRANGEMENTS

17/117 SERIES

Printed Circuit Board Cutouts

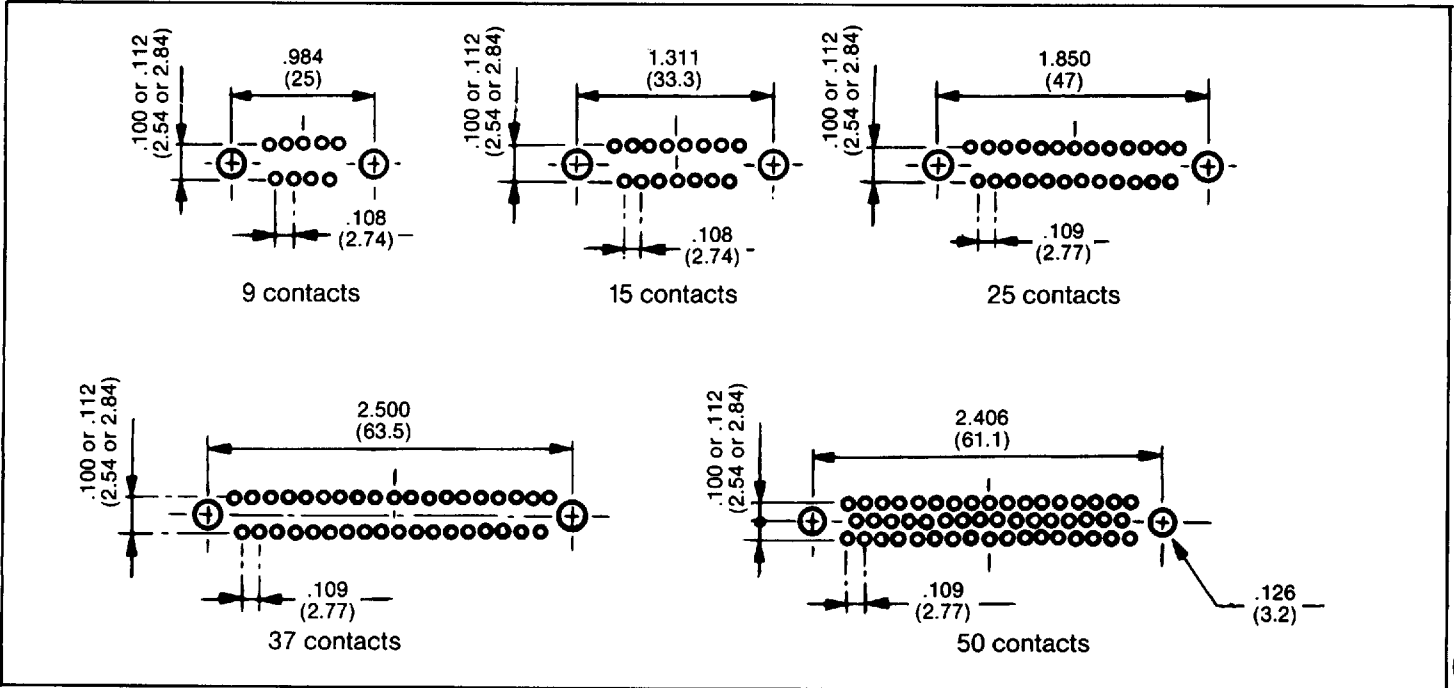

Solder pin diameter	.024(0.6)	.030(0.76)	.040(1.02)
P/C board hole diameter	.030(0.75) min	.035(0.9) min	.047(1.20) min

Contact Spacing

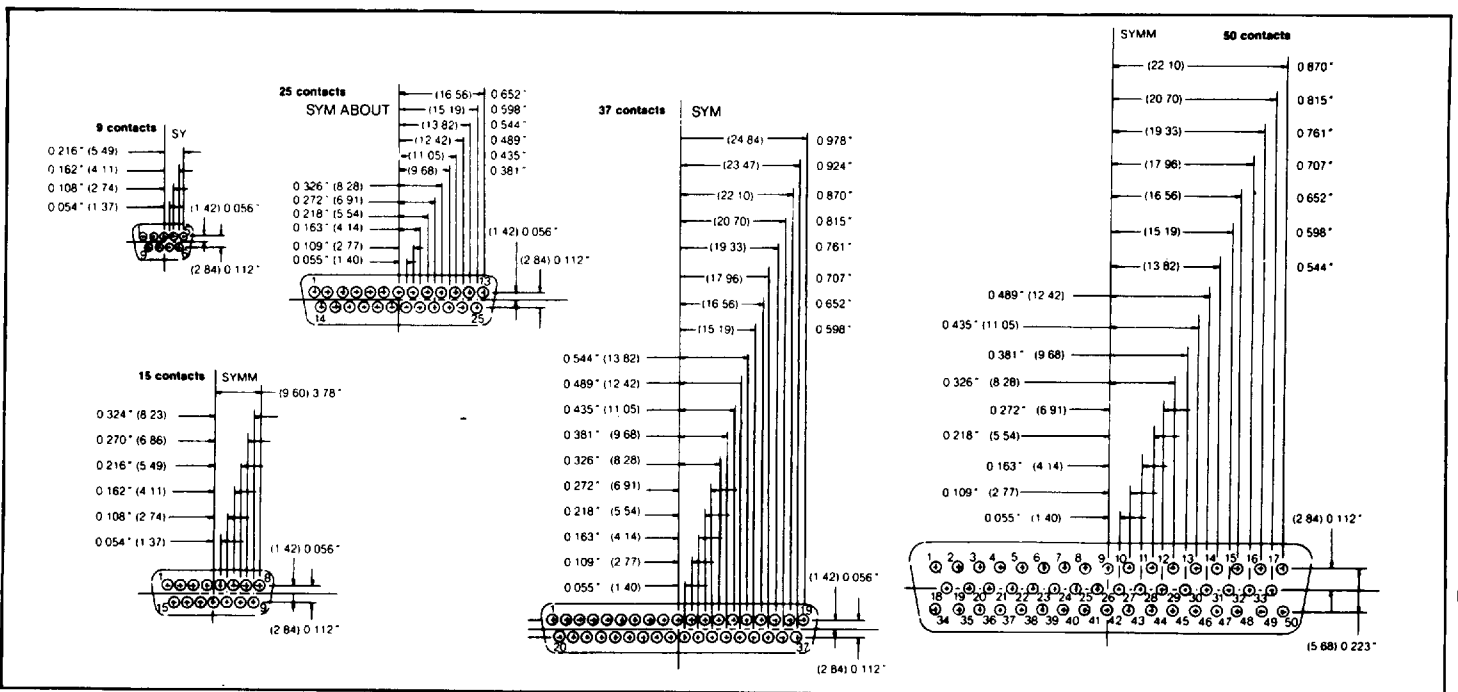

All dimensions: inches (millimeters)