

PRODUCT DESCRIPTION

Male Connectors are designed to mate with Female Socket Transition Connectors. Used primarily for in-line cable splice and "T" tap applications, they are available with optional mounting ears for I/O applications. Retainer/ejector latches provide a convenient means of disconnect.

DESIGN ADVANTAGES

- 13 connector sizes—10,14,16, 20, 24, 26, 34, 40, 44, 50, 56, 60 and 64-position.
- Available with or without mounting ears.
- Contact Material—Beryllium copper with 30 micro inches min. gold over 50 micro inches min. nickel plating.
- 30 μ " (minimum) gold plating in contact mating areas.
- Box shape assures polarization and protects mating pins.
- Connector designed for center bump and dual slot polarizing methods.
- Solid .025" square posts for strength and durability.
- Strain relief available for both connector versions.
- Optional polarizing key.

MALE CONNECTORS

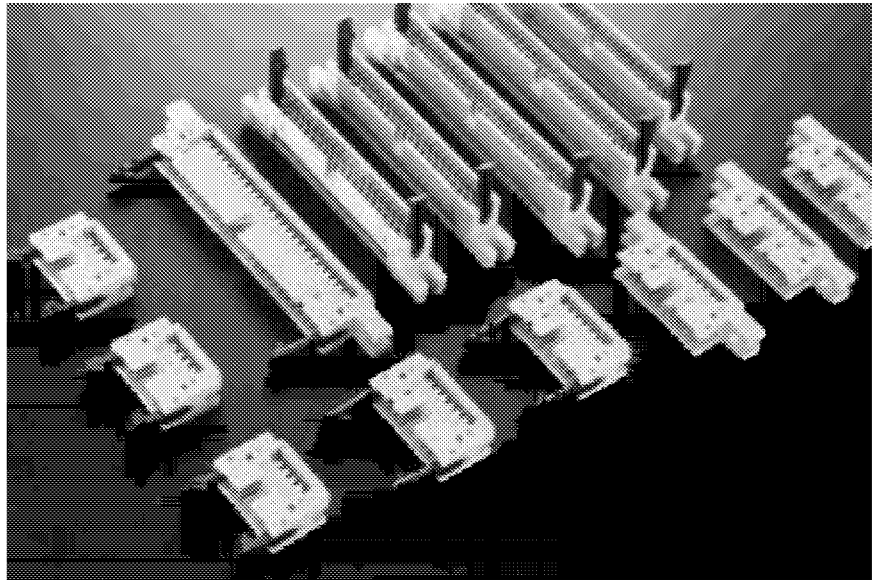
**MALE CONNECTORS INDEX**

Male connectors 10 to 64 pos. w/o mounting ears	46
Male connectors 10 to 64 pos. w/half mounting ears	47

MALE CONNECTOR 10 TO 64 POSITIONS WITHOUT MOUNTING EARS



LR92984 E60980

PHYSICAL PROPERTIES

INSULATION MATERIAL: Glass filled thermoplastic rated UL 94V-0

COLOR: Blue

CONTACT MATERIAL: Beryllium copper, 30µ inches min. gold over 50µ inches min. nickel in contact zone; tin/lead over nickel in termination area.

ELECTRICAL PROPERTIES

CURRENT RATING: 1 Amp

INSULATION RESISTANCE: >1 x 10⁹ Ohms @ 500 VDC

DIELECTRIC STRENGTH: >1000 VRMS @ sea level

ENVIRONMENTAL PROPERTIES

TEMPERATURE RATING: -55°C TO 125°C

APPLICATION TOOLING

HAND TOOL	779-2100
use Die	779-2168A
BENCH PRESS (MANUAL)	779-3200
use Platen	779-3130
use Base Plate	779-3168A
BENCH PRESS (PNEUMATIC)	779-3500XT
use Platen	779-3130
use Base Plate	779-3168A

CABLE

See pages 108-120

MATING CONNECTORS

See pages 9-12

ACCESSORIES

POLARIZING KEY: See page 44

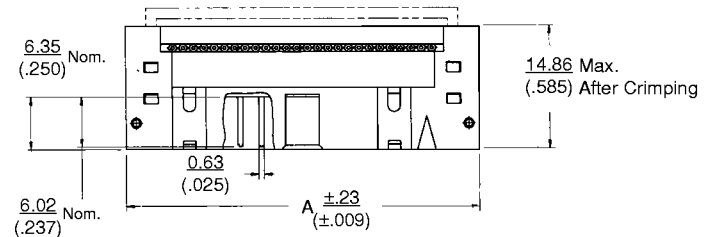
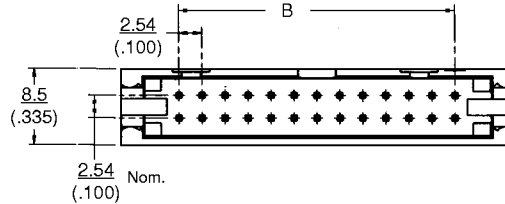
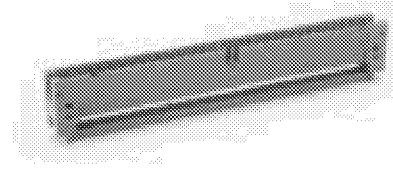

Ejector Latch Ordering Information

SUFFIX	DIMENSIONS IN MM (INCHES)		FINISH	FOR USE WITH
	C	D		
E	10.54 (.415)	22.22 (.875)	Black Oxide	Female Socket Connector without strain relief
ES	14.63 (.576)	26.31 (1.036)	Black Oxide	Female Socket Connector with strain relief

Ordering Information

CATALOG NUMBER	NO. OF POS.	DIMENSIONS IN MM (INCHES)		POLARIZATION
		A	B	
622-1006A	10	23.10 (.906)	10.16 (.400)	MIL-TYPE ONLY
622-1006	10	23.10 (.906)	10.16 (.400)	CENTER SLOT ONLY
622-1406	14	28.09 (1.106)	15.24 (.600)	
622-1606	16	30.63 (1.206)	17.78 (.700)	
622-2006	20	35.71 (1.406)	22.86 (.900)	
622-2406	24	40.79 (1.606)	27.94 (1.100)	
622-2606	26	43.33 (1.706)	30.48 (1.200)	
622-3406	34	48.41 (1.906)	40.64 (1.600)	MIL-TYPE AND
622-4006	40	56.03 (2.206)	48.26 (1.900)	CENTER SLOT
622-4406	44	66.19 (2.606)	53.34 (2.100)	
622-5006	50	73.81 (2.906)	60.96 (2.400)	
622-5606	56	81.43 (3.206)	68.58 (2.700)	
622-6006	60	86.51 (3.406)	73.66 (2.900)	
622-6406	64	91.59 (3.606)	78.74 (3.100)	

For long ejectors, add suffix ES (-XXXES). For short ejectors, add suffix E (-XXXE)

Optional Ejector Latch

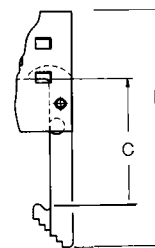

Strain Relief

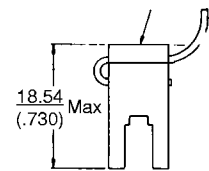

622-XX 66

Strain Relief
Ordering Info
(Optional)

Number of Positions

MALE CONNECTOR 10 TO 64 POSITIONS WITH HALF MOUNTING EARS



PHYSICAL PROPERTIES

INSULATION MATERIAL: Glass filled thermoplastic rated UL 94V-0

COLOR: Blue

CONTACT MATERIAL: Beryllium copper, 30µ inches min. gold over 50µ inches min. nickel in contact zone; tin/lead over nickel in termination area.

ELECTRICAL PROPERTIES

CURRENT RATING: 1 Amp

INSULATION RESISTANCE: >1 x 10⁹ Ohms @500 VDC

DIELECTRIC STRENGTH: >1000 VRMS @sea level

ENVIRONMENTAL PROPERTIES

TEMPERATURE RATING: -55°C TO 125°C

Recommended Panel Cutout Dimensions

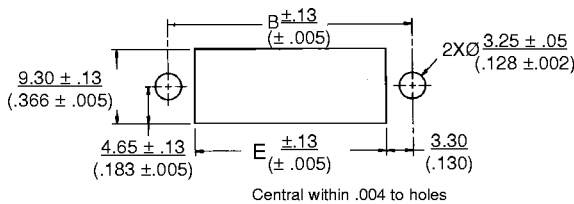

Ejector Latch Ordering Information

SUFFIX	DIMENSIONS IN MM (INCHES)		FINISH	FOR USE WITH
	F	G		
E	10.54 (.415)	22.22 (.875)	Black Oxide	Female Socket Connector without strain relief
ES	14.63 (.576)	26.31 (1.036)	Black Oxide	Female Socket Connector with strain relief

Ordering Information

CATALOG NUMBER	NO. OF POS.	DIMENSIONS IN MM (INCHES)					POLARIZATION
		A	B	C	D	E	
622-1016A	10	38.48 (1.500)	38.48 (1.200)	23.10 (.906)	10.16 (.400)	23.88 (.940)	MIL-TYPE ONLY
622-1016	10	38.48 (1.500)	38.48 (1.200)	23.10 (.906)	10.16 (.400)	23.88 (.940)	CENTER SLOT ONLY
622-1416	14	43.18 (1.700)	35.56 (1.400)	28.09 (1.106)	15.24 (.600)	28.96 (1.140)	
622-1616	16	45.72 (1.800)	38.10 (1.500)	30.63 (1.206)	17.78 (.700)	31.50 (1.240)	
622-2016	20	50.80 (2.000)	43.18 (1.700)	35.17 (1.406)	22.86 (.900)	36.58 (1.440)	
622-2416	24	55.88 (2.200)	48.26 (1.900)	40.79 (1.606)	27.94 (1.100)	41.66 (1.640)	
622-2616	26	58.42 (2.300)	50.80 (2.000)	43.33 (1.706)	30.48 (1.200)	43.18 (1.740)	
622-3416	34	68.58 (2.700)	60.96 (2.400)	53.49 (2.106)	40.64 (1.600)	54.36 (2.140)	MIL-TYPE AND
622-4016	40	76.20 (3.000)	68.58 (2.700)	61.11 (2.406)	48.26 (1.900)	61.98 (2.440)	CENTER SLOT
622-4416	44	81.28 (3.200)	73.66 (2.900)	66.19 (2.606)	53.34 (2.100)	67.06 (2.640)	
622-5016	50	88.90 (3.500)	81.28 (3.200)	73.81 (2.906)	60.96 (2.400)	74.68 (2.940)	
622-5616	56	96.52 (3.800)	88.90 (3.500)	81.43 (3.206)	68.58 (2.700)	82.30 (3.240)	
622-6016	60	101.60 (4.000)	93.98 (3.700)	86.51 (3.406)	73.66 (2.900)	87.38 (3.440)	
622-6416	64	106.68 (4.200)	99.06 (3.900)	91.59 (3.606)	78.74 (3.100)	92.46 (3.640)	

For long ejectors, add suffix ES (-XXXES). For short ejectors, add suffix E (-XXXE)

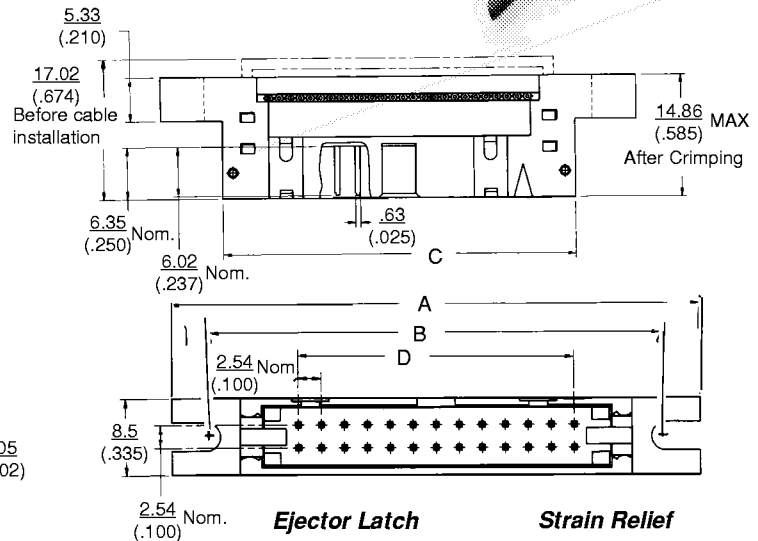
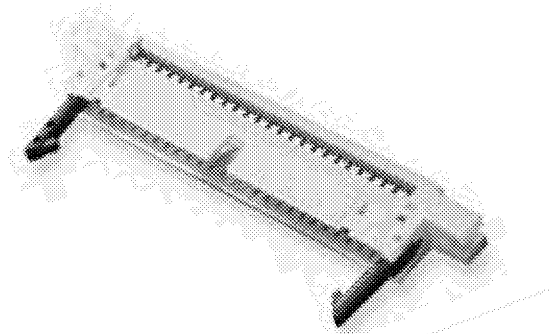

Ejector Latch

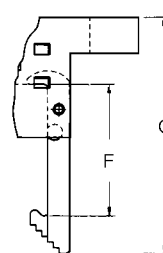

Strain Relief

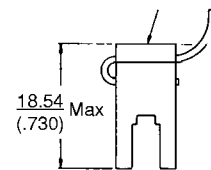

622-XX 66

Strain Relief
Ordering Info
(Optional)

Number of Positions