

SECTION B-B

Pin	Signal Name	Mating Sequence	Pin	Signal Name	Mating Sequence
A1	GND	First	B12	GND	First
A2	SSTXp1	Second	B11	SSRXp1	Second
A3	SSTXn1	Second	B10	SSRXn1	Second
A4	V _{bus}	First	B9	V _{bus}	First
A5	CC1	Second	B8	SBU2	Second
A6	Dp1	Second	B7	Dn2	Second
A7	Dn1	Second	B6	Dp2	Second
A8	SBU1	Second	B5	CC2	Second
A9	V _{bus}	First	B4	V _{bus}	First
A10	SSRXn2	Second	B3	SSTXn2	Second
A11	SSRXp2	Second	B2	SSTXp2	Second
A12	GND	First	B1	GND	First
SHELL	GND	SHELL	GND	SHELL	GND

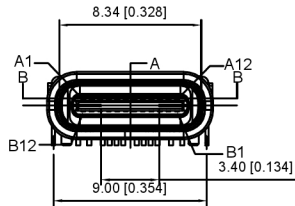

SECTION A-A

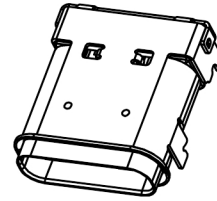
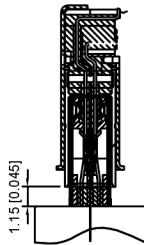
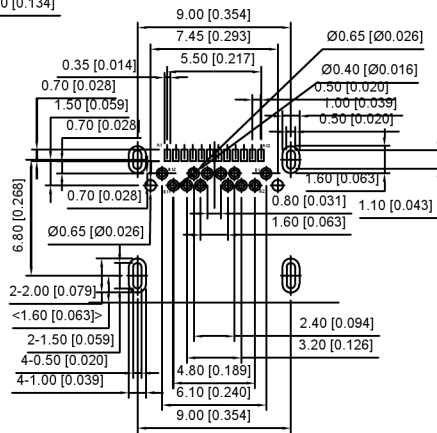
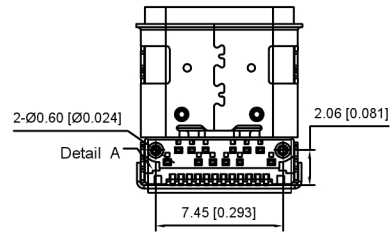

Material 材料
 Housing Material 塑胶材料: High temperature thermoplastic
 Contact Terminal 接触端子: High Grade Copper Alloy
 Metallic Shell 金属壳: Stainless Steel
 Cover Shell 覆盖壳: Iron
 Inner Ground Cover Shell 盖壳: Stainless Steel
 Mid Plate 中板: Stainless Steel
 Plating 电镀
 Data Contact 数据联系
 Underplating 底镀: 50µ" Min. Nickel
 Contact Plating 接触电镀: 1µ" Gold
 Solder Area 焊接区域: 80µ" Matte Tin
 Shell 外壳
 Metallic Shell 金属壳: 50µ" Min. Nickel
 Cover Shell 盖壳
 Metallic Shell 金属壳: 80µ" Min. Nickel
 Inner Ground Cover Shell 内里盖壳
 Metallic Shell 金属壳: 50µ" Min. Nickel
 Electrical 电气
 Voltage Rating 额定电压: 20V DC
 Current Rating 额定电流: V_{bus} pins collectively 5.00A, GND pins collectively 6.25A, B5 pin 1.25A, Other pins 0.25A per pin.
 Contact Resistance 接触电阻: 40mΩ Max.
 Insulation resistance 绝缘电阻: 100 MΩ MIN.
 Dielectric withstanding voltage 耐介电电压: 100V AC/Minute
 Mechanical 机械
 Durability 耐用性: 10,000 cycles
 Mating Force 插入力: 5 to 20N
 Unmating Force 拔出力: 8 to 20N (post test)

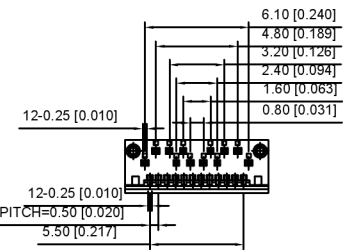

RECOMMEND P.C.B LAYOUT (COMPONENT SIDE)
 TOLERANCE FOR PCB LAYOUT IS ± 0.05
 KEEP OUT AREA

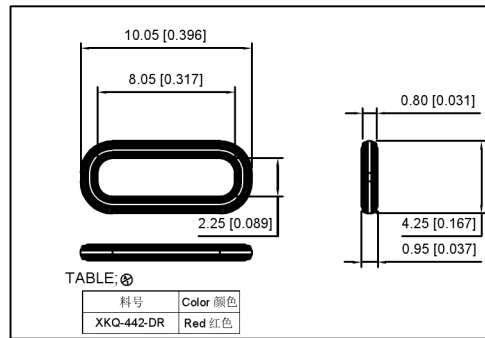
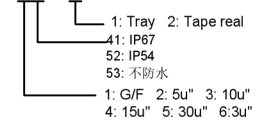

TABLE: Ⓞ

料号	Color 颜色
XKQ-442-DR	Red 红色

USB31-TYPEC-33X41- XFS



广东星坤科技股份有限公司

△X	日期
△X	日期
△X	日期
MARK	DESCRIPTION

文件工程章

REVISIONS	DATE	REVISED	APPROVED

UNSPECIFIED TOLERANCES	
------------------------	--

ANGLAR	±5°
L ≤ 4	±0.2
4 < L ≤ 16	±0.3
16 < L ≤ 63	±0.4
L > 63	±0.5



DSND	SCALE: N/A
DWN	VIEW:
CHKD	UNIT: mm/in
APPD	SIZE: A4

MODEL TYPE:	Type-C 3.1	
PART NO.:	XKQ-442-DR	
DWG NO.:	USB31-TYPEC-33X41-XFS	
WEIGHT	SHEET	REVISIO
	1/1	A0