

PART NO. CA-XXDSD-X

CA-25DSD SHOWN

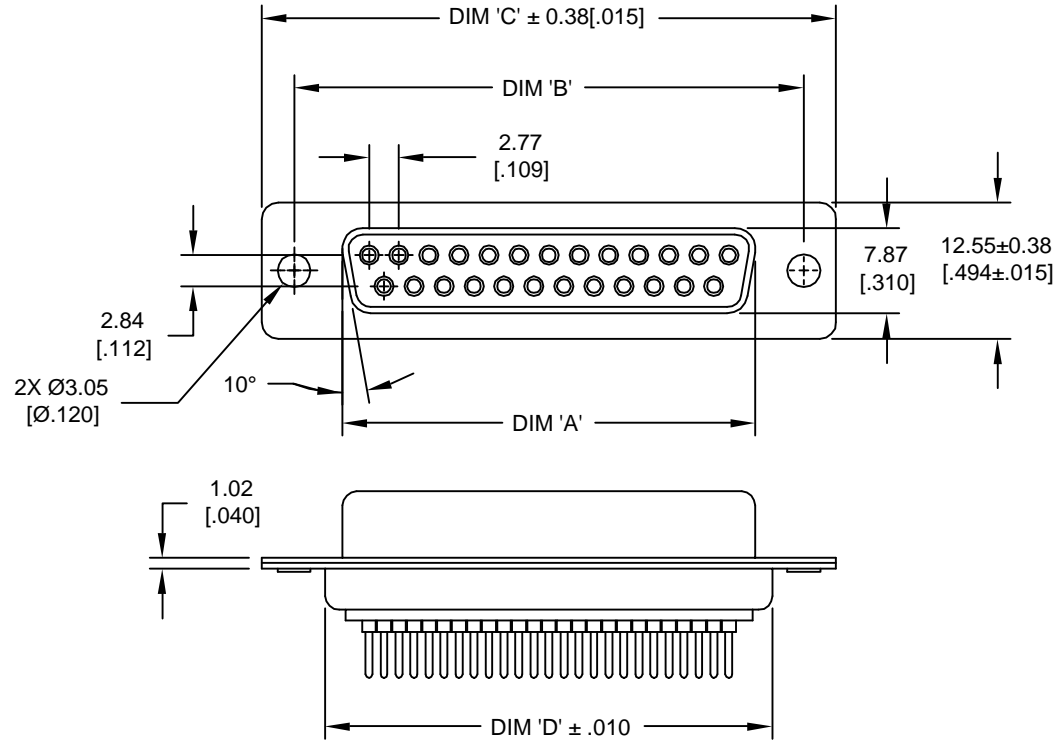

REVISIONS			
LTR	DESCRIPTION	DATE	APPROVED
A	INITIAL RELEASE SEE ECR 558	09-21-87	A.J.
B	SEE DO 4485	NT 05-17-01	A.J.
C	SEE DO 4945	CP 08-20-02	A.J.
D	SEE DO 5364	CP 01-05-04	A.J.
E	SEE DO 7030	CP 11-18-10	I.M.
F	SEE DO 7176	CP 02-06-12	I.M.

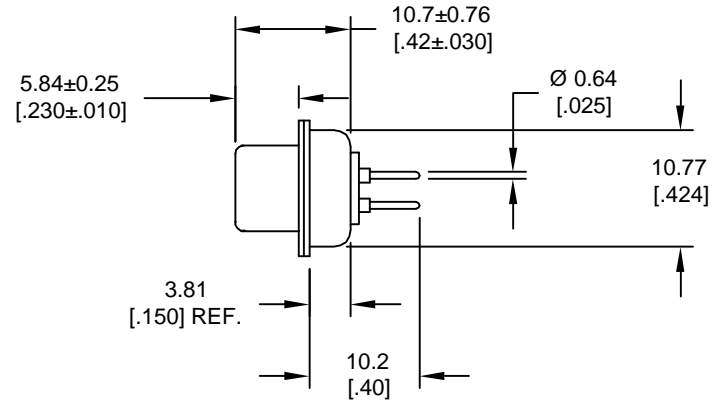

6. MEETS THE REQUIREMENTS OF DIRECTIVE 2002/95/EC OF THE EUROPEAN PARLIAMENT AND OF THE COUNCIL OF 27 JANUARY 2003 ON THE RESTRICTION OF THE USE OF CERTAIN HAZARDOUS SUBSTANCES IN ELECTRICAL AND ELECTRONIC EQUIPMENT. (ROHS)

5. CA-25DSD SHOWN FOR ILLUSTRATION ONLY.

4. TABULATION:

NO OF POSITON	DIM 'A'		DIM 'B'		DIM 'C'		DIM 'D'	
	MM	IN	MM	IN	MM	IN	MM	IN
9	16.33	0.643	24.99	0.984	30.81	1.213	19.28	0.759
15	24.66	0.971	33.32	1.312	39.14	1.541	27.51	1.083
25	38.38	1.511	47.04	1.852	52.96	2.085	41.28	1.625
37	54.84	2.159	63.50	2.500	69.32	2.729	57.71	2.272

3. SHELL MATERIAL: SPCC-SD, NICKEL & TIN PLATED.

2. CONTACT MATERIAL: BRASS, PLATING: SEE ORDERING NOMENCLATURE

1. INSULATOR MATERIAL: POLYESTER GLASS FILLED, UL94V-0, COLOR BLACK

NOTES : UNLESSS OTHERWISE SPECIFIED

ORDERING NOMENCLATURE:

CA- XXDSD-X

NO OF POSITION _____
 "D" SUBMINIATURE SOCKET _____
 CONTACT TYPE _____
 D = DIP SOLDER
 CONTACT PLATING _____
 BLANK = CONTACT AREA : GOLD PLATED
 TAIL AREA: TIN
 UNDERPLATE: NICKEL
 F = CONTACT AREA: 0.00076 [0.00030"] GOLD
 TAIL AREA: TIN
 UNDERPLATE: NICKEL

DIMENSIONS ARE IN MILLIMETERS TOLERANCES ARE: DECIMALS ANGLES .X ± .25 °3' .XX ± .13	APPROVALS DRAWN IAN MORRELL	DATE 9-21-87	CIRCUIT ASSEMBLY CORP. 18 THOMAS ST., IRVINE, CALIFORNIA 92618-2777
	CHECKED ART JOCHEN	DATE 9-21-87	
DIMENSIONS IN BRACKETS [XX] ARE INCHES TOLERANCES ARE: DECIMALS ANGLES .XX ± .010 °3' .XXX ± .005	THE INFORMATION AND DESIGN DISCLOSED HEREIN WAS ORIGINATED BY AND IS THE PROPERTY OF CIRCUIT ASSEMBLY CORPORATION. CIRCUIT ASSEMBLY CORPORATION RESERVES ALL PATENT, PROPRIETARY, DESIGN, MANUFACTURING, REPRODUCTION, USE AND SALES RIGHTS THERE TO, AND TO ANY ARTICLE DISCLOSED HEREIN EXCEPT TO THE EXTENT RIGHTS ARE EXPRESSLY GRANTED TO OTHERS. THIS FOREGOING DOES NOT APPLY TO VENDOR PROPRIETARY RIGHTS.		CONNECTOR ASSEMBLY - "D" SUMINIATURE TYPE: CA-DSD, P.C.B. MOUNT. "ROHS"
DO NOT SCALE DRAWING	SIZE C	CODE IDENT NO. 52072	DRAWING NO. 610123 REV. F
	SCALE: NONE		SHEET 1 OF 1