

1

2

3

4

5

6

7

Male

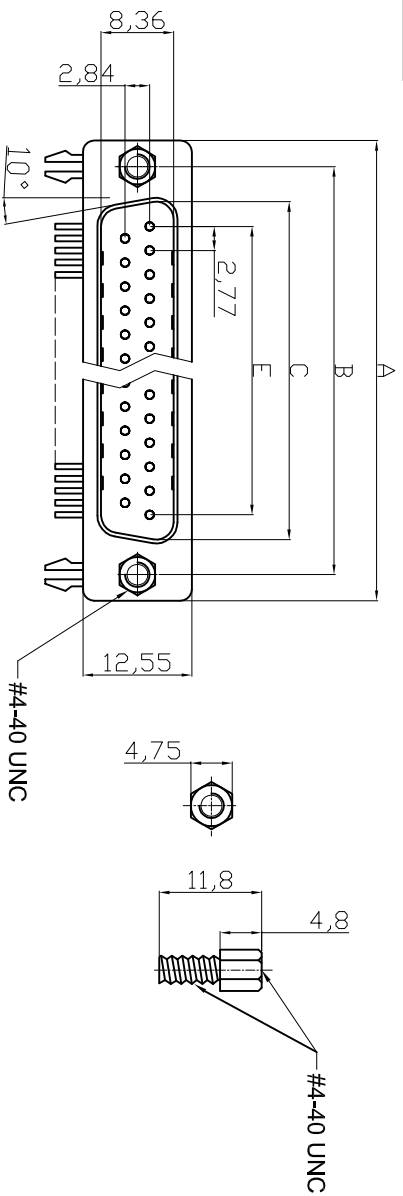

NOTES:

MATERIAL

- 1. Insulator Material: Glass-Filled Thermoplastic PBT, UL 94V-0-Black
- 2. Contact Material : Brass
- 3. Contact plating : Gold flash full gold
- 4. Shell : Steel, 100u" Tin over 50u" min copper
- 5. Clinch Nut : Copper alloy, Nickel plated
- 6. Boardlock : Brass, Tin plated
- 7. Screwlock: Steel, Nickel plated

ELECTRICAL

- 1. Current Rating : 3AMP
- 2. Voltage Rating : 250V AC/rms 60Hz
- 3. Contact Resistance: 20mΩ max at 1 AMP DC
- 4. Insulation Resistance : 1000MΩ at 500 V DC
- 5. Withstand Voltage : 1000V AC/rms 60Hz for 1 minute
- 6. Operating Temperature: -55°C--105°C
UL No. E149426

Order Code:

A-Dx xx A/K-G-xx

* on request

- Contact style:
 - F - Female
 - S - Male
- No. of Contacts
09 / 15 / 25 / 37
- Version
 - T2 - with locking bolts UNC (Gold flash full gold)
 - T2S - with locking bolts UNC (Gold flash selective gold)
 - T4 - without locking bolts *(Gold flash full gold)
 - T4S - without locking bolts *(Gold flash selective gold)
- Standard: Quality class III

Recommended PCB Layout

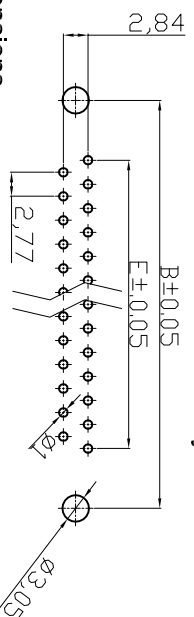

Dimensions

Positions	A	B	C	E
09	30.81	24.99	16.92	11.08
15	39.20	33.30	25.25	19.39
25	53.05	47.04	38.96	33.24
37	69.40	63.50	55.42	49.86

7.2mm Footprint

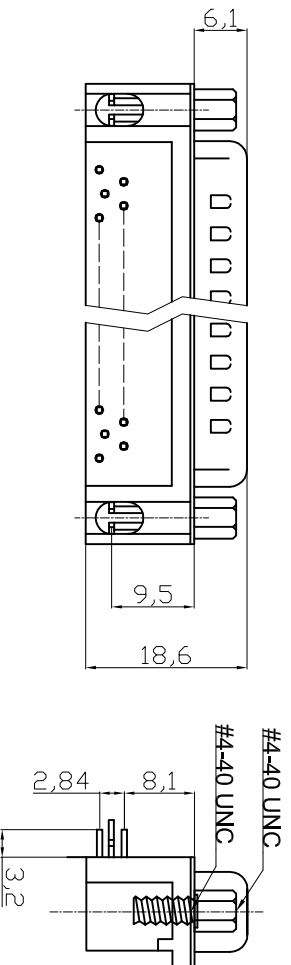

ROHS compliant
Unit: mm

Scale	Free								
TOLERANCE									
X.	±0.38								
X.X	±0.25								
X.XX	±0.13	Ⓢ	Update the operating temperature	05.06.2013	Winnie				
DIM	TOL	Ⓢ	Update	24.10.2012	Winnie				
X.°	±3°	Ⓢ	Drawn	15.08.2012	Lucas				
X.X°	±1.0°	Ⓢ							
Angle	TOL	Id.	Modification	Date	Name				

1

2

3

4

5

6

7



ASS 4888 CO rev02

Replace Sheet 1/2

G

G

F

F

E

E

D

D

C

C

B

B

A

A

1

2

3

4

5

6

7

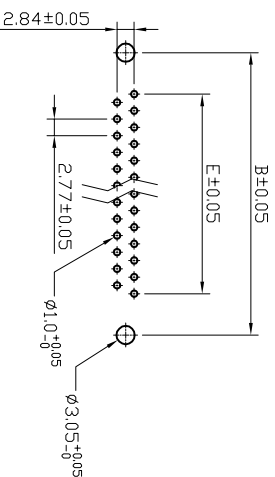
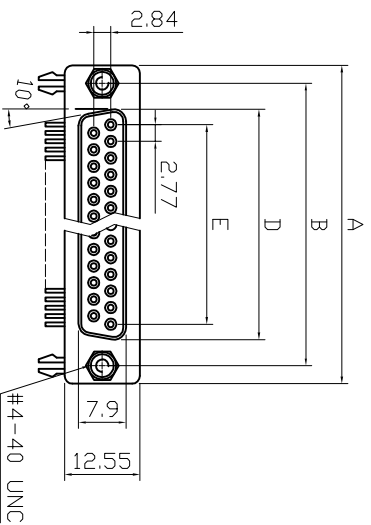
Female**RECOMMENDED PCB LAYOUT**

- Product Specification**
- Material**
 Insulator : Glass-Filled thermoplastic PBT UL 94V-0 Black
 Contact : Copper alloy
 Contact Plating : Gold flash full gold
- Shell : Steel, 100u" Tin over 50u" min copper**
Boardlock : Brass, Tin Plated
Screwlock : Steel, Nickel Plated
- Electrical**
 Contact Resistance : 20 milliohms, Max at 1 AMP DC.
 Insulation Resistance : 1000 megohms at 500 VDC
 Dielectric Withstanding Voltage : 1000 VAC/rms 60Hz for 1 minute
 Current Rating : 3AMP
 Voltage Rating : 250 VAC/rms 60Hz
 OPERATING TEMPERATURE:-55°C+105°C
 UL No. E149426

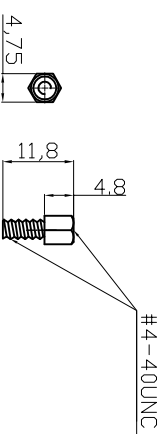
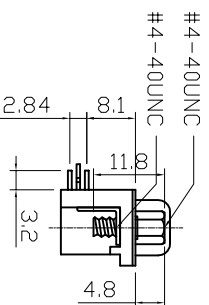
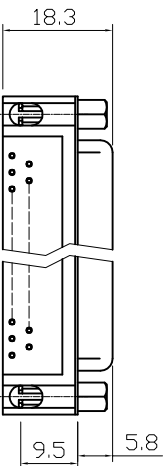

#4-40 unc screwlock installed

Dimensions

Positions	A	B	D	E
9	30.81	24.99	16.33	11.08
15	39.20	33.30	24.70	19.39
25	53.05	47.04	38.40	33.24
37	69.40	63.50	54.80	49.86

7.2mm Footprint**RoHS compliant**

Unit: mm

Scale	Free
TOLERANCE	
X.	±0.38
X.X	±0.25
X.XX	±0.13
DIM	TOL
X.°	±3°
X.X°	±1.0°
Angle	TOL

Free	Id.	Modification	Date	Name
		Update the operating temperature	05.06.2014	Winnie
		Update	24.10.2012	Winnie
		Drawn	15.08.2012	Lucas

Customer-No.

Date

Name

Date

Name

Drawing-No.

ASSMANN WSW-No.

A-Dx xx A/KG-T2/T2S/T4/T4S

ASSMANN

ASS 4888 CO

rev02

ASSMANN
WSW/ components

Replace

Sheet 2/2

1

2

3

4

5

6

7

H

G

G

H