

PN Gold Mounted Ball Bearings **SEALMASTER**®

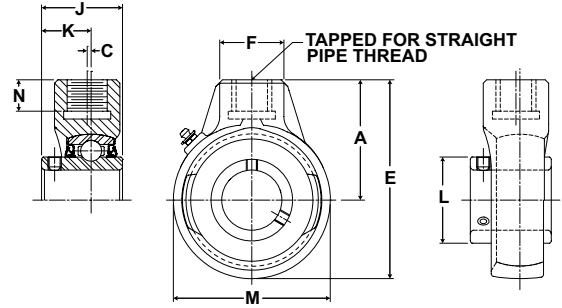

- Duty:** Standard
- Housing:** Flouropolymer Coated Cast Iron
- Self-Alignment:** +/- 2 Degrees
- Lock:** Setscrew
- Seal:** HPS
- Temperature:** -20° to 220°F
- Grease:** Sealmaster GoldPlex-FG



CREHBF-PN Series Hanger Bearing External Lube Setscrew Locking

| Bore Diameter inch | Part No.* | Brg. No. | Basic Dynamic Rating lb/N | Dimensions inch/mm | | | | | | | | Pipe Tap** N.P.S.M. | N Thread Length | Unit Wt. lb/kg |
|-----------------------|--------------|----------|------------------------------|--------------------|--------------|------------------|----------------|-----------------|----------------|-----------------|----------------|------------------------|--------------------|-------------------|
| | | | | A | C | E | F | J | K | L | M | | | |
| 1 | CREHBF-PN16 | PNM-16 | 4381 19488 | 2 1/2 63.5 | - | 4 1/16 103.2 | 1 9/16 39.7 | 1 1/2 38.1 | 7/8 22.2 | 1 19/32 40.5 | 3 1/8 79.4 | 3/4-14 | 13/16 20.6 | 2.2 1.00 |
| 1 1/4 | CREHBF-PN20R | PN-20R | | | | | | | | | | | | |
| 1 1/4 | CREHBF-PN20 | PN-20 | 5782 25720 | 2 3/4 69.9 | - | 4 9/16 115.9 | 1 9/16 39.7 | 1 11/16 42.9 | 1 25.4 | 1 55/64 47.2 | 3 5/8 92.1 | 3/4-14 | 3/4 19.1 | 3.1 1.41 |
| 1 3/8 | CREHBF-PN22 | PN-22 | | | | | | | | | | | | |
| 1 7/16 | CREHBF-PN23 | PNM-23 | 7340 32650 | 2 7/8 73.0 | 3/32 2.4 | 4 3/4 120.7 | 1 9/16 39.7 | 1 15/16 49.2 | 1 3/16 30.2 | 2 1/16 52.4 | 3 3/4 95.3 | 3/4-14 | 3/4 19.1 | 3.4 1.54 |
| 1 1/2 | CREHBF-PN24 | PN-24 | | | | | | | | | | | | |
| 1 15/16 | CREHBF-PN31 | PN-31 | 7889 35092 | 3 1/4 82.6 | 3/16 4.8 | 5 7/16 138.1 | 1 7/8 47.6 | 2 1/32 51.6 | 1 9/32 32.5 | 2 15/32 62.7 | 4 3/8 111.1 | 1-11 1/2 | 13/16 20.6 | 4.5 2.04 |
| 2 | CREHBF-PN32R | PN-32R | | | | | | | | | | | | |
| 2 3/16 | CREHBF-PN35 | PNM-35 | 11789 52440 | 4 101.6 | 11/32 8.7 | 6 13/16 173.0 | 2 5/16 58.7 | 2 9/16 65.1 | 1 9/16 39.7 | 2 63/64 75.8 | 5 5/8 142.9 | 1 1/4-11 1/2 | 1 1/8 28.6 | 9 4.08 |
| 2 7/16 | CREHBF-PN39 | PN-39 | | | | | | | | | | | | |

*Housing is Flouropolymer coated cast iron and housing design does not allow for snap on end cap.

**Use Straight Pipe Thread.

For additional sizes and Skwezloc concentric locking collar availability contact customer service

Metric dimensions for reference only.

Not all parts are available from stock. Please contact customer service for availability (800) 626-2120.

For more information on bearing capabilities outside of our standard offering, please contact Application Engineering (800) 626-2093.