

Mounted Ball Bearings *Browning*

Mtd. Ball Bearings

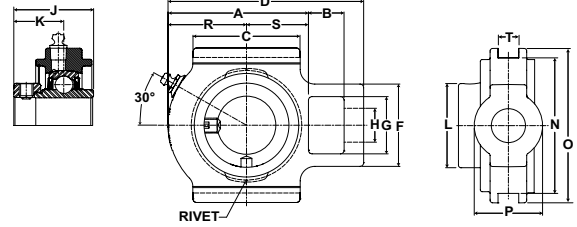

- Duty:** Standard
- Rolling Elements:** Ball
- Housing:** Cast Iron Wide Slot Take Up
- Self Alignment:** +/- 1.5 Degrees
- Lock:** Eccentric
- Seal:** Contact and Flinger
- Temperature:** -20° to 200°F



VTWE 200 Series Standard Duty Wide Slot Take Ups - Eccentric Locking

Bore Diameter inch	Part No.	Bearing Insert No.	Basic Dynamic Rating lb/N	Dimensions inch / mm															Unit Wt. lb/kg		
				A	B	C	D	F	G	H Core	J	K	L	N	O	P Hub	R	S		T	
3/4	VTWE-212	VE-212	2611 11614	3 76.2	5/8 15.9	2 1/4 57.2	4 101.6	1 7/8 47.6	1 1/4 31.8	3/4 19.1	1 23/32 43.7	1 3/64 26.6	1 5/16 33.3	3 76.2	3 1/2 88.9	1 3/8 34.9	1 7/16 36.5	1 9/16 39.7	17/32 13.5	1.8 .82	
7/8	VTWE-214	VE-214	2801 12459	3 5/64 78.2	5/8 15.9	2 1/4 57.2	4 3/32 104.0	1 7/8 47.6	1 1/4 31.8	3/4 19.1	1 3/4 44.5	1 1/16 27.0	1 1/2 38.1	3 76.2	3 1/2 88.9	1 1/2 38.1	1 9/16 39.7	1 17/32 38.9	17/32 13.5	1.9 .86	
15/16	VTWE-215	VE-215																			
1	VTWE-216	VE-216																			
1 1/8	VTWE-218	VE-218	4381	3 3/8	3/4	2 1/2	4 5/8	2 1/8	1 7/16	7/8	1 29/32	1 3/16	1 3/4	3 1/2	4	1 3/4	1 25/32	1 19/32	17/32	2.8	
1 3/16	VTWE-219	VE-219	19487	85.7	19.1	63.5	117.5	54.0	36.5	22.2	48.4	30.2	44.5	88.9	101.6	44.5	45.2	40.5	13.5	1.27	
1 1/4	VTWE-220	VE-220	5782 25718	3 3/4	3/4	2 3/4	5	2 1/8	1 7/16	7/8	2 1/64	1 9/32	2 3/16	3 1/2	4	1 3/4	2	1 3/4	17/32	3.5 1.59	
1 3/8	VTWE-222	VE-222																			
1 7/16	VTWE-223	VE-223																			
1 1/2	VTWE-224	VE-224	7340 32648	4 7/32	3/4	3 1/4	5 19/32	2 3/4	1 15/16	1 1/8	2 7/32	1 3/8	2 3/8	4	4 1/2	2 1/8	2 3/16	2 1/32	11/16	5.2 2.36	
1 5/8	VTWE-226	VE-226	7901 35144	4 3/8	3/4	3 1/4	5 3/4	2 3/4	1 15/16	1 1/8	2 7/32	1 3/8	2 1/2	4	4 1/2	2 1/8	2 1/4	2 1/8	11/16	5.8 2.63	
1 11/16	VTWE-227	VE-227																			
1 3/4	VTWE-228	VE-228																			
1 15/16	VTWE-231	VE-231	7889 35090	4 17/32	3/4	3 3/8	5 29/32	2 3/4	1 15/16	1 1/8	2 15/32	1 1/2	2 3/4	4	4 1/2	2 1/8	2 5/16	2 7/32	11/16	6.1 2.77	
2	VTWE-232	VE-232	9752 43377	5 3/32	1	3 3/4	6 27/32	3 5/8	2 1/2	1 3/8	2 13/16	1 23/32	3	5 1/8	5 3/4	2 1/2	2 9/16	2 17/32	1 1/16	8.7 3.95	
2 3/16	VTWE-235	VE-235																			
2 7/16	VTWE-239	VE-239	11789 52437	5 1/2	1	4	7 1/4	3 5/8	2 1/2	1 3/8	3 1/16	1 27/32	3 3/8	5 1/8	5 3/4	2 1/2	2 27/32	2 21/32	1 1/16	9.6 4.35	

Refer to page G-190 for Frames.

Bore Size	Frame Series
3/4" to 1"	10
1 1/8" to 1 7/16"	23
1 1/2" to 2S"	31
2" to 2 7/16"	39

Metric dimensions for reference only.