

HCMD-10-S-03.00-01

(2.54 mm) .100"

IDC SOCKET & TERMINAL CABLE

Mates with:

TSW, MTSW, TST, HTST, EW, ZST, MTLW, TSM, EJH-02 (HCSD only)

SPECIFICATIONS

For complete specifications and recommended PCB layouts see www.samtec.com?HCSD or www.samtec.com?HCSS

HCSD, HCSS

Insulator Material: Black Liquid Crystal Polymer
Flammability Rating: UL 94V-0

Temperature Range: -20 °C to +105 °C (Rainbow Cable)
 -40 °C to +105 °C (Gray Cable)

Voltage Rating: 425 VAC/600 VDC

Contact: Phosphor Bronze
Plating: 10 μ" (0.25 μm) Au on contact area, 150 μ" (3.81 μm) Sn on balance over 50 μ" (1.27 μm) Ni.

Lead Size Range: .024" (0.61 mm) SQ to .026" (0.66 mm) SQ

Lead Insertion Depth: .185" (4.70 mm) to .250" (6.35 mm)

Wire: 28 AWG 7/36 stranded Tinned Copper
RoHS Compliant: Yes

SPECIFICATIONS

For complete specifications and recommended PCB layouts see www.samtec.com?HCMD or www.samtec.com?HCMS

HCMD, HCMS

Insulator Material: Black Liquid Crystal Polymer
Flammability Rating: UL 94V-0

Temperature Range: -20 °C to +105 °C (Rainbow Cable)
 -40 °C to +105 °C (Gray Cable)

Voltage Rating: 425 VAC/600 VDC

Terminal: Phosphor Bronze
Plating: Sn over 50 μ" (1.27 μm) Ni

Wire: 28 AWG 7/36 stranded Tinned Copper
RoHS Compliant: Yes

Note: IDC assemblies are non-standard, non-returnable.

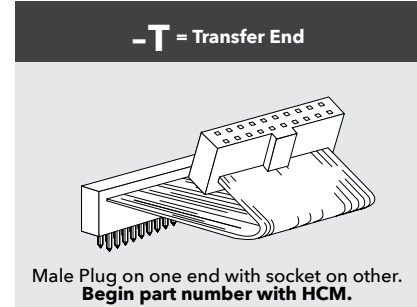
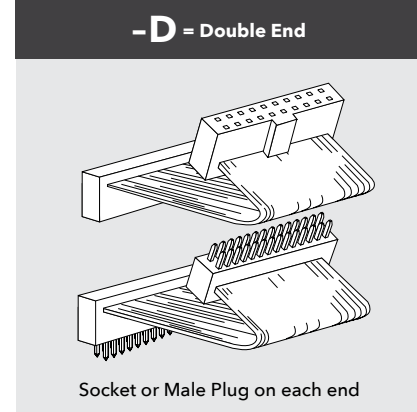
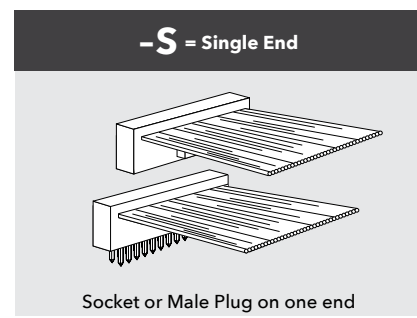
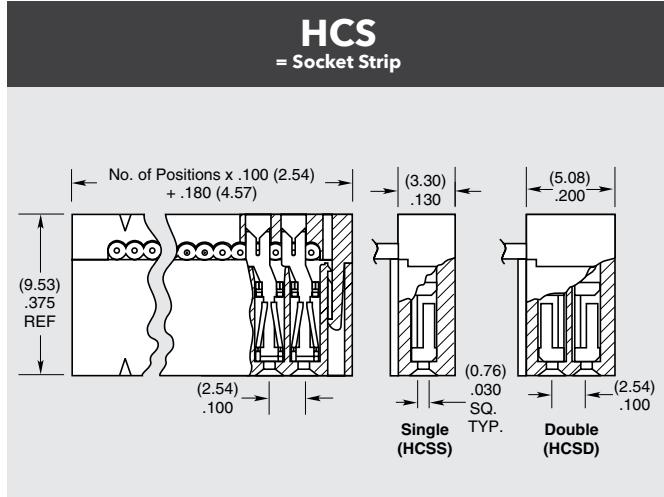
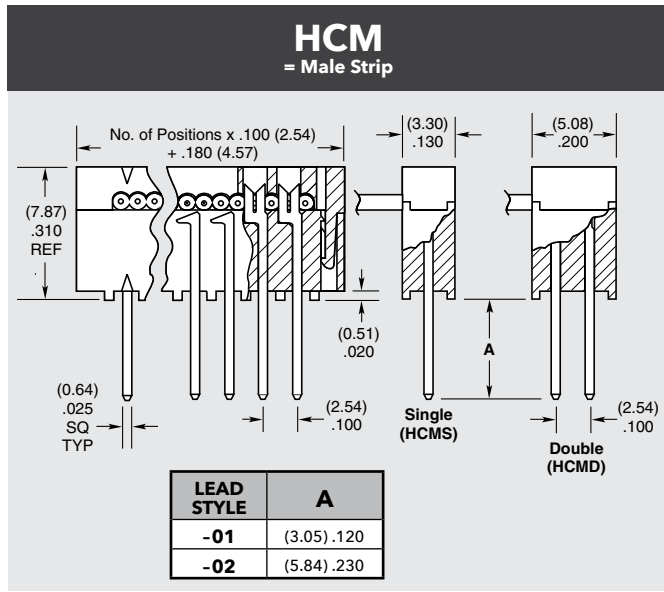
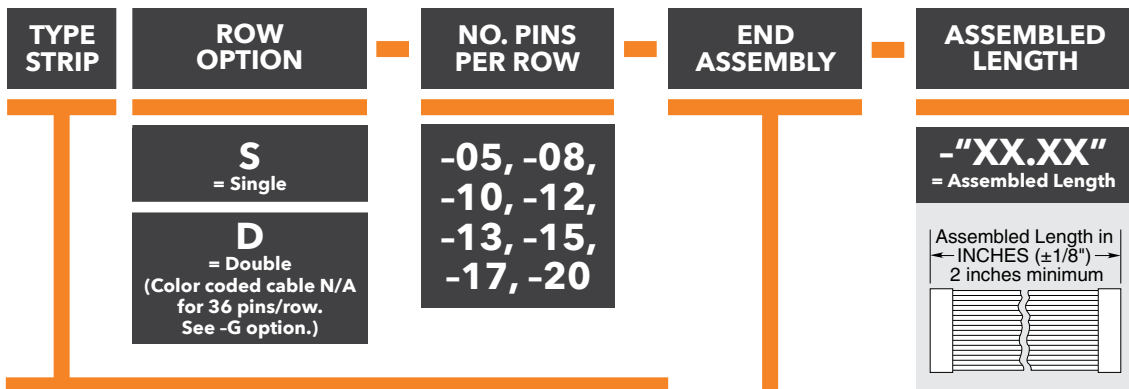

HCSS-15-S-03.00-01-G

HCSD-10-S-03.00-01-T-G

HCMD, HCMS, HCSD, HCSS SERIES

LEAD STYLE

-01

= HCSS/HCSD or (3.05 mm) .120" tail for HCMS/HCMD

-02

= (5.84 mm) .230" tail HCMS/HCMD only

PLATING OPTION

-S

= 10 μm (0.25 μm) Gold on contact area or tail, Tin on balance (Standard on HCSS & HCSD. Leave blank)

-T

= Tin (Standard on HCMS & HCMD. Leave blank)

NOTCH POLARIZATION

-N = Notch Polarization

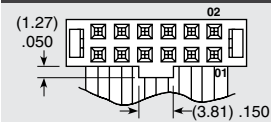

Required for HCSS and HCSD. (Not available on HCMS or HCMD, unless Transfer, then only the socket is polarized.)

OTHER OPTIONS

-P "XX"

= Position Polarization

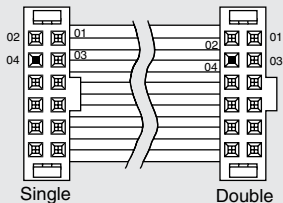

Specify "XX" as position. For Double the same position will be polarized on both ends. (Not available on HCM, unless Transfer, then only the socket is polarized)

-G

= Gray Cable

Standard cable is color coded. Specify -G for Gray cable with one red edge.

-ST "X"

= Stripped & Tinned

Specify Suffix from table. All dimensions are ± 1/16" (1.59 mm). Not available in 28 positions and higher.

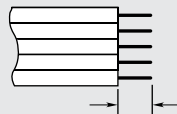

-ST8	1/8" (3.18)
-ST4	1/4" (6.35)
-ST2	1/2" (12.70)
-ST3	3/8" (9.53)

-B "XX"

= Breakout

Specify "XX" as number of conductors to be broken out.

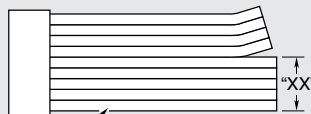

Breakout starts with Number 1 lead indicated by brown wire or red stripe. Shown on top side.

-RW

= Reversed Wiring

#1 wire opposite position #1

-S "XX"

= Daisy Chain Single

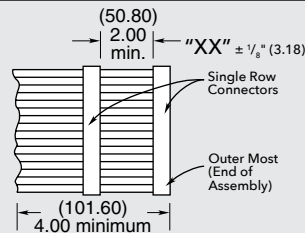

When mating double row connector with two single row connectors, the outer most single will be connected to Conductor #1 and the inside single to Conductor #2.

-D "XX"

= Daisy Chain, Double

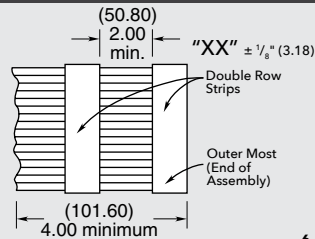

-W "XX"

= Wiring Reversed Daisy Chain, Single

Same as -S "XX" except outer strip connected to conductor #2 and inside strip connected to conductor #1.

-R

= Reversed

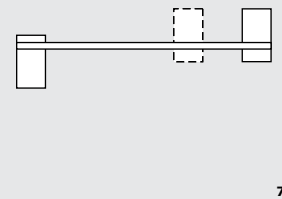

-M

= Middle Reversed

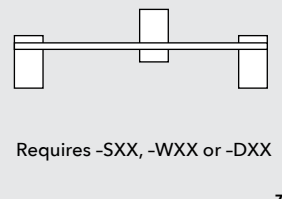

Requires -SXX, -WXX or -DXX

-O

= Outside Reversed

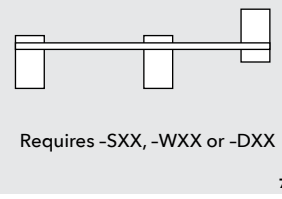

Requires -SXX, -WXX or -DXX

Mouser Electronics

Authorized Distributor

Click to View Pricing, Inventory, Delivery & Lifecycle Information:

Samtec:

[HCMD-21-T-04.00-01-G](#) [HCMD-21-T-04.00-01-T-G](#) [HCMD-22-T-10.00-02](#) [HCMD-25-D-12.00-02](#) [HCMD-25-T-72.00-01-S-N](#) [HCMD-30-D-06.00-01-S](#) [HCMD-30-T-72.00-01-T-N](#) [HCMD-32-D-08.00-02-G](#) [HCMD-32-T-03.00-01-S-N-P53-G](#) [HCMD-36-T-12.00-02-G](#) [HCMD-36-T-02.00-02-S-G](#) [HCMD-36-T-08.00-02-S-N-G](#) [HCMD-25-S-10.00-01](#) [HCMD-25-S-24.00-01](#) [HCMD-25-T-06.00-01](#) [HCMD-25-T-06.00-01-R](#) [HCMD-25-T-06.00-02](#) [HCMD-30-T-06.00-01-G](#) [HCMD-30-T-07.00-01-G](#) [HCMD-32-D-04.00-01-G](#) [HCMD-32-D-04.00-01-S-G](#) [HCMD-32-S-10.00-02-G](#) [HCMD-32-T-06.00-01-S-G](#) [HCMD-32-T-08.00-02-G](#) [HCMD-32-T-10.00-01-G](#) [HCMD-36-T-03.00-02-G](#) [HCMD-25-D-06.00-01](#) [HCMD-25-S-02.00-01-G](#) [HCMD-25-T-02.00-02-G](#) [HCMD-25-T-03.00-01-S-G](#) [HCMD-25-T-24.00-01-N](#) [HCMD-27-T-06.00-02-S-G](#) [HCMD-30-D-04.00-02-S-G](#) [HCMD-30-S-12.00-02](#) [HCMD-32-D-06.00-01-S-G](#) [HCMD-32-D-06.00-02-S-G](#) [HCMD-32-D-24.00-02-G](#) [HCMD-36-S-12.00-02-G](#) [HCMD-36-T-02.00-01-G](#) [HCMD-36-T-18.00-02-G](#) [HCMD-25-D-12.00-01](#) [HCMD-25-D-24.00-02-G](#) [HCMD-25-T-03.00-02-R](#) [HCMD-25-T-08.00-02-S-G-R](#) [HCMD-25-T-10.00-01-N-G](#) [HCMD-25-T-12.00-01](#) [HCMD-25-T-36.00-02](#) [HCMD-25-T-08.00-02-R](#) [HCMD-25-T-12.00-01-R](#) [HCMD-25-T-72.00-02-N-G](#) [HCMD-27-T-10.00-02](#) [HCMD-30-S-20.00-01](#) [HCMD-30-T-03.20-01-S-N-RW-R](#) [HCMD-30-T-12.00-02](#) [HCMD-32-D-07.00-01-G](#) [HCMD-32-D-24.00-01-G](#) [HCMD-32-S-36.00-02-S-G](#) [HCMD-36-S-24.00-01-G](#) [HCMD-36-T-08.00-02-T-G-R](#) [HCMD-25-D-09.00-02-G](#) [HCMD-25-D-36.00-02-G](#) [HCMD-25-T-03.00-02](#) [HCMD-25-T-03.00-02-G](#) [HCMD-30-D-12.00-01](#) [HCMD-30-D-72.00-02](#) [HCMD-30-T-18.00-01-S-N-P04](#) [HCMD-32-D-07.00-02-G](#) [HCMD-32-D-13.00-01-S-G-R](#) [HCMD-32-T-02.00-02-S-G](#) [HCMD-32-T-20.00-01-G](#) [HCMD-32-T-24.00-02-G](#) [HCMD-36-D-18.00-01-G](#) [HCMD-36-D-24.00-01-G](#) [HCMD-36-T-12.00-02-G-R](#) [HCMD-36-T-18.00-01-G](#) [HCMD-24-T-10.00-02-D04](#) [HCMD-25-S-12.00-02](#) [HCMD-25-S-36.00-02-G](#) [HCMD-25-T-06.00-01-G](#) [HCMD-25-T-12.00-02-S](#) [HCMD-25-T-12.00-02-T](#) [HCMD-30-T-04.00-01-G](#) [HCMD-30-T-06.00-01](#) [HCMD-32-D-05.00-01-G](#) [HCMD-32-D-05.00-01-S-G](#) [HCMD-32-T-06.00-02-G](#) [HCMD-36-D-02.50-01-G](#) [HCMD-36-T-08.00-01-G](#) [HCMD-24-T-06.00-02](#) [HCMD-25-T-04.00-01](#) [HCMD-25-T-08.00-02-G](#) [HCMD-25-T-12.00-01-S-G](#) [HCMD-30-T-03.00-02-S-R](#) [HCMD-30-T-12.00-02-R](#) [HCMD-32-D-03.00-01-G-R](#) [HCMD-32-D-13.00-02-G-R](#) [HCMD-32-T-02.00-01-G](#) [HCMD-32-T-04.50-02-G](#) [HCMD-32-T-06.00-01-N-G](#) [HCMD-32-T-12.00-01-S-G](#)