

SINGLE-ENDED BEAM
SQB-HSS

Stainless Steel, Welded Seal, NTEP Certified 1:5,000 Class III Multiple Cell, IP67

VPG CELTRON



APPROVALS



Dimensions

Picture is a representation of actual product

Rated Capacity	L	L1	L2	L3	W	H	D	T
lb/in								
1,000-5,000 SE	5.12	1.00	3.00	0.50	1.25	1.25	0.53	1/2-20 UNF
5,000-10,000	6.75	1.50	3.75	0.75	1.50	1.50	0.78	3/4-16 UNF

Order Information

Load Rating	Part #	Est. Weight	Price
1,000 lb	67118	3 lb	\$325.00
2,000 lb	67119	3 lb	\$325.00
2,500 lb	67120	3 lb	\$325.00
3,000 lb	67121	3 lb	\$325.00
4,000 lb	67122	3 lb	\$325.00
5,000 lb SE	67123	3 lb	\$325.00
5,000 lb	67124	5 lb	\$425.00
10,000 lb	67125	5 lb	\$425.00

SE=small envelope

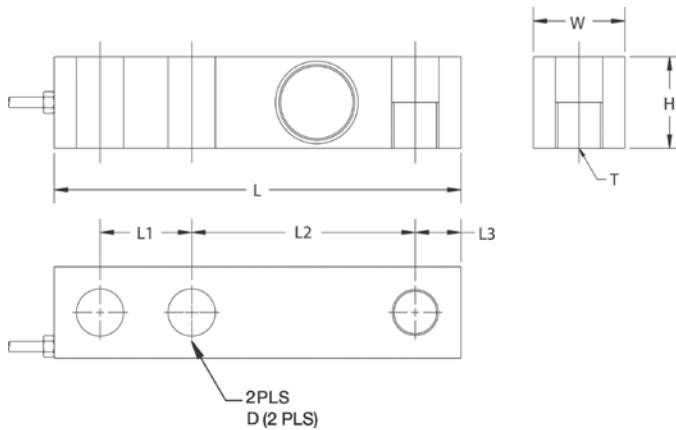

Interchangeable Products

VPG® SENSORTRONICS
65083..... page 320

Weigh Module Available

RICE LAKE WEIGHING SYSTEMS
RL1800 Series..... page 62

Specifications

Full Scale Output:
3.0 mV/V

Output Resistance:
350 (± 3) ohm

Input Resistance:
385 (± 5) ohm

Material/Finish:
Stainless steel

Temperature:
Compensated range
14°F to 104°F (-10° C to 40° C)
Operating range
0° F to 150° F (-18° C to 65° C)

Seal Type:
Welded-seal, IP67

Safe Overload:
150% full scale

Safe Sideload:
100% full scale

Rated Excitation:
5-10 VDC (15 V maximum)

Combined Error:
0.02 full scale

Insulation Resistance:
5,000 megohms

Cable Length:
20 ft

Cable Diameter:
0.200 in polyurethane jacket

Cable Color Code:
Red +Excitation
Black -Excitation
Green +Signal
White -Signal

Warranty:
One-year limited warranty

Approvals:
cFMus
NTEP

www.ricelake.com | Phone: 800-472-6703

