

**SPECIFICATIONS**

Rated(额定参数): 300V,25A  
 Dielectric strength(抗电强度): AC2000V/1 Minute  
 Insulation Resistance(绝缘电阻):1000MΩ Min  
 Contact Resistance(接触电阻):20mΩ Max  
 Screw Torque(扭矩): 1.2Nm (10.53Lb.in)  
 Wire Range(线径):12~22AWG  
 Temp. range(操作温度): -40℃~+105℃  
 MAX Soldering(瞬时温度):+250℃,5s

Housing Material(塑件): PA66 (UL94 V-0)  
 Contact(端子): Brass, Tin plating(黄铜镀锡)  
 Screw (螺丝): M4.0, Steel, Ni plating(钢 镀镍)

PITCH RANGE		NOMINAL DIMENSION RANGE					
IN MM		IN MM		IN MM		IN MM	
TO 6	OVER 10	TO 30	OVER 60	TO 100	OVER 150	TO 10	OVER 150
TO 10	OVER 24	TO 30	OVER 60	TO 100	OVER 150	TO 10	OVER 150
±0.10	±0.15	±0.25	±0.30	±0.30	±0.50	±0.70	±1.00

**Ordering Information**

JL950M - 950 XX X X 1

- Pitch: 762=7.62PH, 850=8.50PH, 900=9.00PH, 950=9.5PH, 100=10.0PH, 121=12.1PH
- No. of pins: 2P~18P
- Housing Color: B=Black, G=Green, U=Blue, R=Red, W=White, Y=Yellow, O=Orange, E=Grey
- Packing: O=Pe, bog, T=Tube, A=Tray

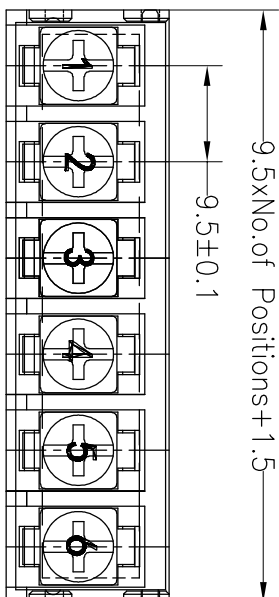
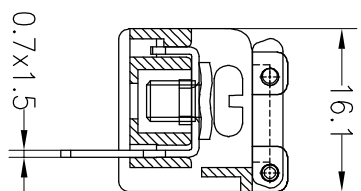
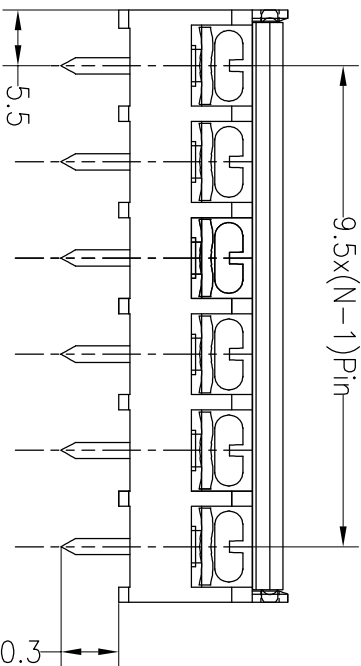
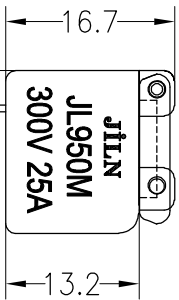

REV	DATE	MODIFICATION DESCRIPTION	CHANGE	OPERATION	DRAW	SCALE	FIT	PART NO.
A0	2018.03.28	NEW DRAWING		XX X:XX X:XXX	yiyusheng	mm	A4	JL950M-950XXXXX1
1				±0.30 ±0.20 ±0.10	18.03.28		1/1	
				Angle DIM				
				TOL	APPROVE	PROU.		
				TITLE:		9.5mm Terminal Blocks Female		

**JIN** 深圳市锦凌电子有限公司  
 SHENZHEN JINLING ELECTRONIC CO.,LTD  
 Tel: 86-755-2997-5806/5802 Fax: 86-755-2997-5992